

REV	LOCATIONS	DESCRIPTION	DATE	REVISER	APPD
1	△	1. Size changes	12/OCT/24	Nick	ERIC

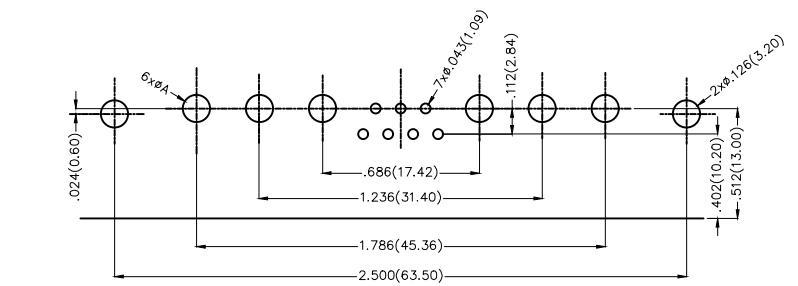
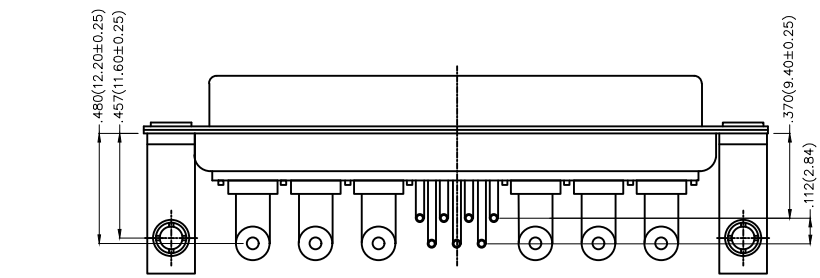
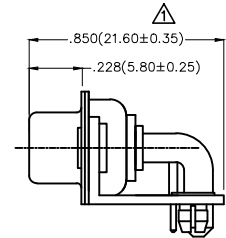
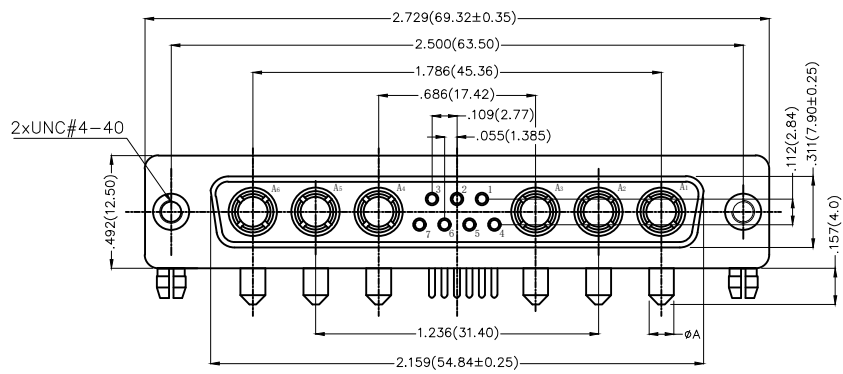

Recommended P.C.Board Layout

1. Electrical Characteristic
  - 1.1 Current Rating
    - Signal Contacts: 7.5A
    - Power Contacts: 10 to 40A
  - 1.2 Voltage Rating: 300V
  - 1.3 Contact Resistance: 5 Milliohms Max
  - 1.4 Insulation Resistance: 5000 Megaohms Min.
  - 1.5 Dielectric Withstanding Voltage : 1000V AC r.m.s Min

2. Materials And Finish
  - 2.1 Shell: Steel Material, Front Nickel Plated 80u" Min  
Back Shell Tin Plated 100u" Min
  - 2.2 Insulator: Glass Filled Thermoplastic, UL 94V-0 , Colour: Black
  - 2.3 Signal Contacts: Bronze /Gold Plated 1u"~30u"
  - 2.4 Power Contacts: Bronze /Gold Plated 3u"~30u"
  3. Temperature Range-Operating: -55°C ~ +105°C

Type	Part NO.	ØA	PCB. ØB	Current Rating(A)
A	FDP1319-F0DB1XXK6KA	.067(1.70)	.079(2.00)	10
B	FDP1319-F0DB1XXK6KB	.108(2.75)	.118(3.00)	20
C	FDP1319-F0DB1XXK6KC	.130(3.30)	.142(3.60)	30
D	FDP1319-F0DB1XXK6KD	.150(3.80)	.161(4.10)	40

### Ordering Information

FDP 13. 19 - F0 D B 1 XX K6 K X  
 1 2 3 4 5 6 7 8 9 10 11

1   D-sub Connector Series Name FDP-Power Type	2   Circuits 13-13W6	3   Distinction No. 19	4   Type MO-Male	5   Assembly Layout D-DIP	6   Entry Type B-Side entry type
7   Plating 1-Gold Flash	8   Thickness of Plating 03-3u" 15-15u" 30-30u" .....	9   Plastic Colour K6-Black	10   Packaging K-Tray	11   Type A-Type A C-Type C B-Type B D-Type D	

<p>THIRD ANGLE PROJECTION</p>	GENERAL TOLERANCES (UNLESS SPECIFIED)		APPROVE BY FRANK	DATE 19/JUL/13	PART NO. FDP1319-F0DB1XXK6KX	ITEM NO. FDP1319-F	<p>Leader Of Industry</p>		
	DESIGN UNITS Inch (metric)	X.±.012(0.30) X.X±.008(0.20) X.XX±.006(0.15) X.XXX±.004(0.10)	X.'±5' X.'±2' .XX'±1" .XXX'±0.5'	CHECKED BY CHERRY	DATE 19/JUL/13	TITLE POWER MACHINED CONTACT HYBRID D-SUB FEMALE 13W6 CONN		REV 1	SHEET NO. 1/1
	SCALE 5:1	SIZE A4	DRAWN BY JACOB	DATE 19/JUL/13	THIS DRAWING CONTAINS INFORMATION THAT IS PROPRIETARY TO TXGA INDUSTRIAL ELECTRONICS(S.Z)CO.,LTD AND SHOULD NOT BE USED WITHOUT WRITTEN PERMISSION				