

REV	LOCATIONS	DESCRIPTION	DATE	REVISER	APPD

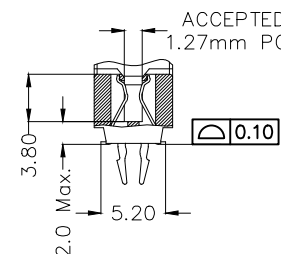
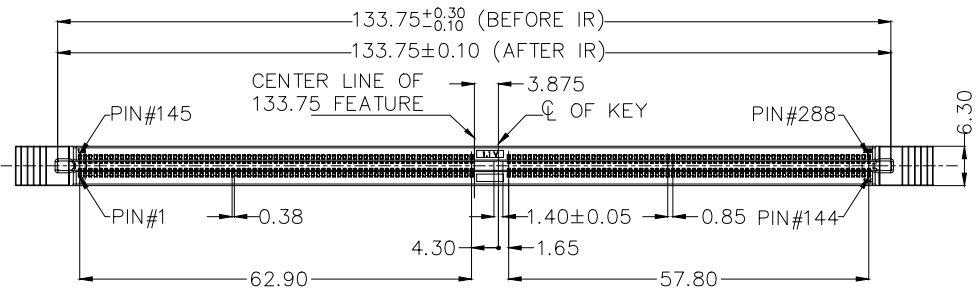

ACCEPTED SPECIFICATION
1.27mm PCB Electrical

Current Rating: 0.75A AC(rms)/DC
Voltage Rating: 25V AC(rms)/DC
Contact Resistance: 20 mΩ Max
Insulation Resistance: 500 MΩ MIN
Withstanding Voltage: 500V AC r.m.s
Temperature Range-Operating: -55°C~+105°C

Material
Housing: PA9T, (UL 94V-0)
LATCH : PA9T, (UL 94V-0)
Contact: Copper Alloy/Selective gold plated on contact area and matte tin plated on tails area
Boardlocks : SUS

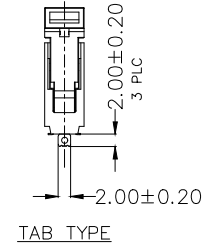
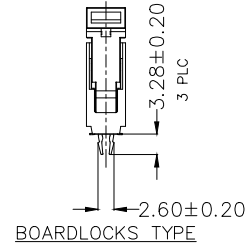
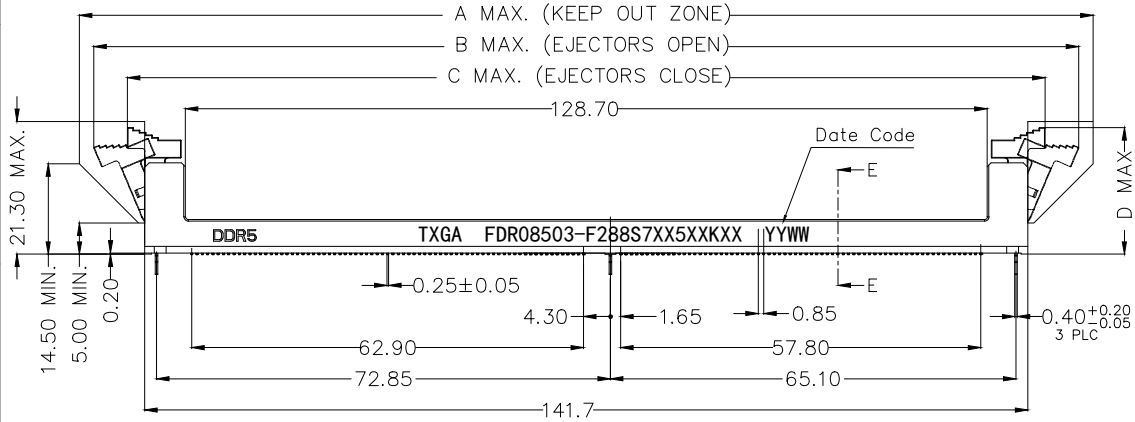

Ordering Information

FDR 085 03 - F 288 S 7 XX 5 XX K X X
1 2 3 4 5 6 7 8 9 10 11 12 13

LATCH TYPE	Dimensions			
	A	B	C	D
LONG	162.00	158.50	147.50	20.70
MIDDLE	156.00	156.00	145.50	20.30
SHORT	152.00	151.50	142.00	20.20

- 1 Category: FDR-DDR Connector
- 2 Series Number: 085-Pitch0.85mm
- 3 Distinction No.: 03
- 4 Type: F-Female
- 5 Circuits: 288
- 6 Entry Angle: S-180° Vertical
- 7 Plating: 7-Selective gold plated on contact area and matte tin plated on tails area
- 8 thickness of Gold Plating: 00-Gold Flash, 15-15u", 30-30u"
- 9 Material-Resin: 5-PA9T
- 10 Color-Resin: BK-Black HSG,Black Latch, NA-Natural HSG,Natural Latch, UA-Blue HSG,Natural Latch, YA-Yellow HSG,Natural Latch
- 11 Packaging: K-Tray
- 12 LATCH Type: 1-LONG, 2-MIDDLE, 3-SHORT
- 13 Type: 1-Boardlock, 2-Tab

<p>THIRD ANGLE PROJECTION</p>	GENERAL TOLERANCES (UNLESS SPECIFIED) X. ±0.30 X.* ±5* X.X ±0.20 X.X* ±2* X.XX ±0.15 X.XX* ±1* X.XXX ±0.10 X.XXX* ±0.5*		APPROVE BY LEO	DATE 19/Sept/23	PART NO. FDR08503-F288S7XX5XXKXX	ITEM NO. FDR08503	<p>TXGA Building Technology Cornerstone</p>
	DESIGN UNITS METRIC(mm)	SCALE 5:1	SIZE A4	CHECKED BY GISELLE	DATE 19/Sept/23	TITLE DDR5, 180°vertical 288P memory socket SMT Type	
THIS DRAWING CONTAINS INFORMATION THAT IS PROPRIETARY TO TXGA INDUSTRIAL ELECTRONICS(S,Z)CO.,LTD AND SHOULD NOT BE USED WITHOUT WRITTEN PERMISSION							

REV	LOCATIONS	DESCRIPTION	DATE	REVISER	APPD

A

A

B

B

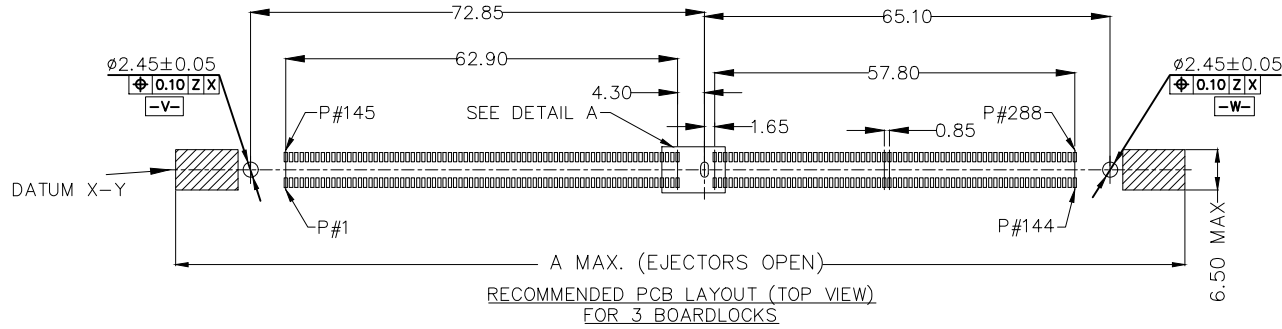

C

C

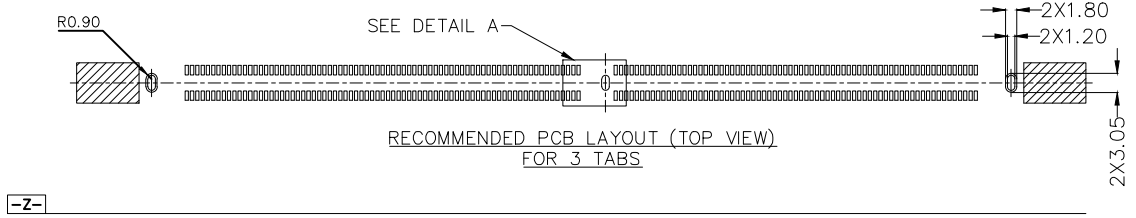

D

D

E

E

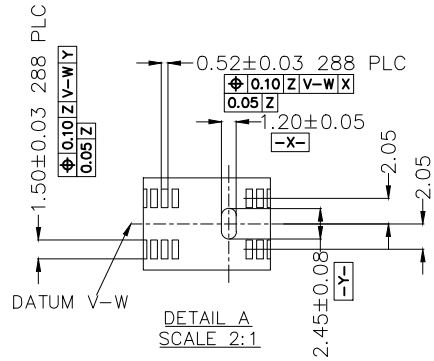

F

F

<p>THIRD ANGLE PROJECTION</p>	<p>GENERAL TOLERANCES (UNLESS SPECIFIED)</p>		<p>APPROVE BY</p> <p>LEO</p>	<p>DATE</p> <p>19/Sept/23</p>	<p>PART NO.</p> <p>FDR08503-F288S7XX5XXKXX</p>	<p>ITEM NO.</p> <p>FDR08503</p>	<p>Building Technology Cornerstone</p>
	<p>X. ± 0.30</p>	<p>X.* $\pm 5^{\circ}$</p>	<p>CHECKED BY</p> <p>GISELLE</p>	<p>DATE</p> <p>19/Sept/23</p>	<p>TITLE</p> <p>DDR5, 180°vertical 288P memory socket SMT Type</p>		
<p>DESIGN UNITS</p> <p>METRIC(mm)</p>	<p>X.X ± 0.20</p>	<p>X.X* $\pm 2^{\circ}$</p>	<p>DRAWN BY</p> <p>Hejianpeng</p>	<p>DATE</p> <p>19/Sept/23</p>	<p>THIS DRAWING CONTAINS INFORMATION THAT IS PROPRIETARY TO TXGA INDUSTRIAL ELECTRONICS(S,Z)CO.,LTD AND SHOULD NOT BE USED WITHOUT WRITTEN PERMISSION</p>		
<p>SCALE</p> <p>5:1</p>	<p>SIZE</p> <p>A4</p>	<p>X.XX ± 0.15</p>			<p>X.XX* $\pm 1^{\circ}$</p>	<p>SHEET NO. 2/3</p>	

1 2 3 4 5 6 7 8

REV	LOCATIONS	DESCRIPTION	DATE	REVISER	APPD

A

A

B

B

C

C

D

D

E

E

F

F

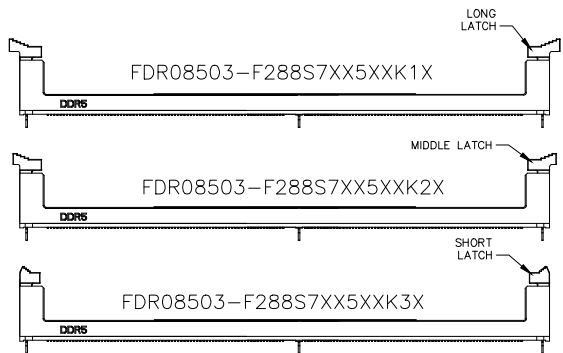
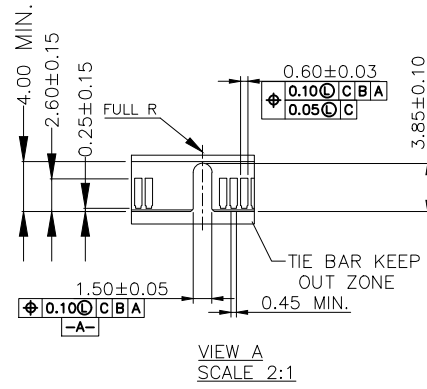
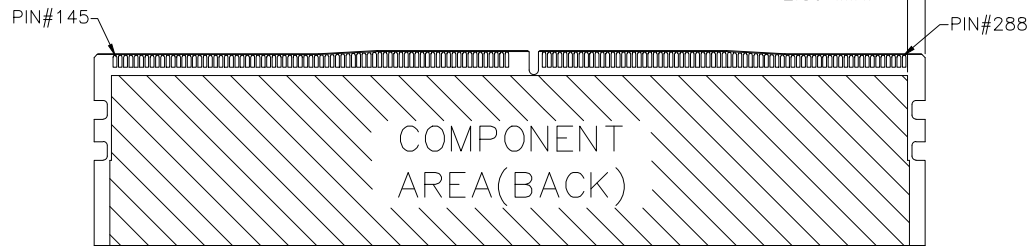
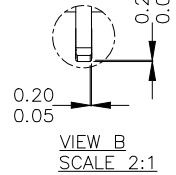
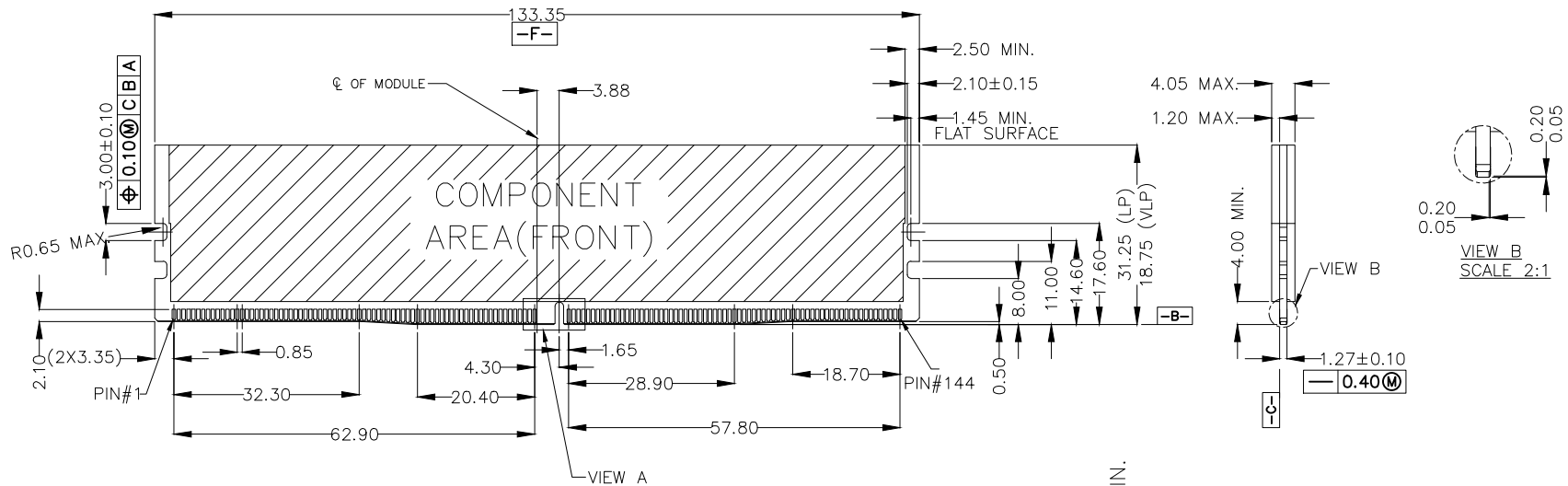

 THIRD ANGLE PROJECTION	GENERAL TOLERANCES (UNLESS SPECIFIED)		APPROVE BY LEO	DATE 19/Sept/23	PART NO. FDR08503-F288S7XX5XXKXX	ITEM NO. FDR08503	 Building Technology Cornerstone
	X. ±0.30	X.' ±5°	CHECKED BY GISELLE	DATE 19/Sept/23	TITLE DDR5, 180°vertical 288P memory socket SMT Type		
DESIGN UNITS METRIC(mm)	X.X ±0.20	X.X' ±2°	DRAWN BY Hejianpeng	DATE 19/Sept/23	THIS DRAWING CONTAINS INFORMATION THAT IS PROPRIETARY TO TXGA INDUSTRIAL ELECTRONICS(S.Z)CO.,LTD AND SHOULD NOT BE USED WITHOUT WRITTEN PERMISSION		
SCALE 5:1	X.XX ±0.15	X.XX' ±1°			SHEET NO. 3/3		
SIZE A4	X.XXX ±0.10	X.XXX' ±0.5°					

1 2 3 4 5 6 7 8