

REV	LOCATIONS	DESCRIPTION	DATE	REVISER	APPD

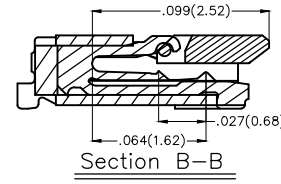
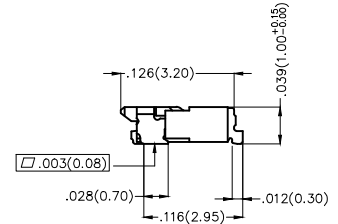
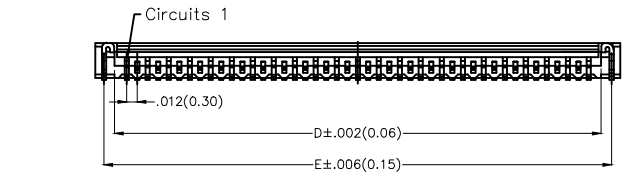
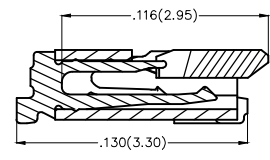
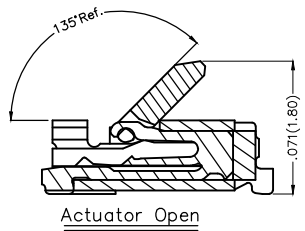
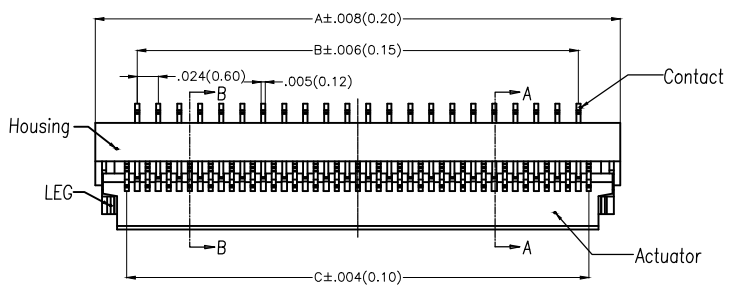

SPECIFICATIONS

Electrical
 Current Rating: 0.2A AC(rms)/DC
 Voltage Rating: 30V AC(rms)/DC
 Contact Resistance: 20 mΩ Max
 Insulation Resistance: 50 MΩ Min
 Withstanding Voltage: 200V AC r.m.s
 Temperature Range—Operating: -25°C~+85°C

Material and Plating
 Housing: LCP UL 94V-0
 Actuator: LCP UL 94V-0
 Terminal: Phosphor Bronze/ Gold Plated
 Stopper: Phosphor Bronze/ Tin Plated

Circuits (n)	Part No.	Dimensions (in/mm)				
		A	B	C	D	E
13	FFC03001-13SBB114W5M	.213(5.40)	.118(3.00)	.142(3.60)	.169(4.30)	.193(4.90)
15	FFC03001-15SBB114W5M	.236(6.00)	.142(3.60)	.165(4.20)	.193(4.90)	.217(5.50)
21	FFC03001-21SBB114W5M	.307(7.80)	.213(5.40)	.236(6.00)	.264(6.70)	.287(7.30)
23	FFC03001-23SBB114W5M	.330(8.40)	.236(6.00)	.260(6.60)	.287(7.30)	.335(7.90)
25	FFC03001-25SBB114W5M	.354(9.00)	.260(6.60)	.283(7.20)	.311(7.90)	.335(8.50)
29	FFC03001-29SBB114W5M	.402(10.20)	.307(7.80)	.331(8.40)	.358(9.10)	.382(9.70)
31	FFC03001-31SBB114W5M	.425(10.80)	.331(8.40)	.354(9.00)	.382(9.70)	.406(10.30)
35	FFC03001-35SBB114W5M	.472(12.00)	.378(9.60)	.402(10.20)	.429(10.90)	.453(11.50)
39	FFC03001-39SBB114W5M	.520(13.20)	.425(10.80)	.449(11.40)	.476(12.10)	.500(12.70)
41	FFC03001-41SBB114W5M	.543(13.80)	.449(11.40)	.472(12.00)	.500(12.70)	.524(13.30)
45	FFC03001-45SBB114W5M	.590(15.00)	.496(12.60)	.520(13.20)	.547(13.90)	.571(14.50)
51	FFC03001-51SBB114W5M	.661(16.80)	.567(14.40)	.591(15.00)	.618(15.70)	.642(16.30)

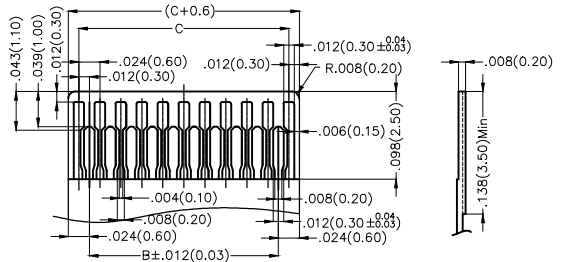

Applicable FFC Recommended Dimension

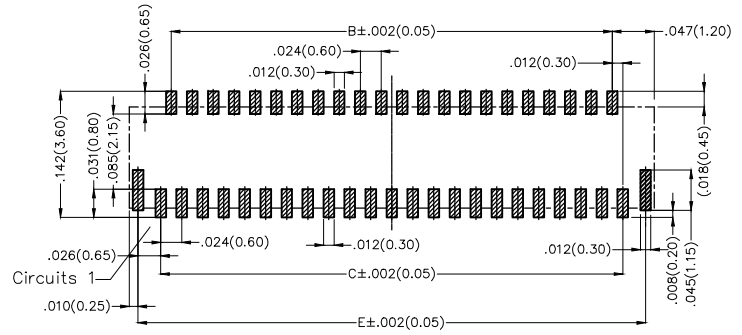

Recommended P.C.Board Layout

Ordering Information

FFC 030 01 — XX S B B 1 1 4 W5 M
 1 2 3 4 5 6 7 8 9 10 11 12

1 Category FFC-FPC	2 Series Number 030-Pitch0.3mm	3 Distinction No. 01	4 Circuits XX	5 Assemble Layout S-SMT	6 Entry Angle B-90° Angle
7 Contact Position B-Bottom	8 ZIF 1-ZIF	9 Plating 1-Gold Plated	10 Material-Resin 4-LCP	11 Color-Resin W5-Housing: Natural, Actuator: Black	12 Packaging M-Reel

 THIRD ANGLE PROJECTION DESIGN UNITS Inch (metric) SCALE 5:1 SIZE A4	GENERAL TOLERANCES (UNLESS SPECIFIED) X.±.012(0.30) X.'±5' X.X±.008(0.20) X.'±2' X.XX±.006(0.15) X.'±1' X.XXX±.004(0.10) X.'±0.5'		APPROVE BY FRANK CHECKED BY JACOB DRAWN BY CHERRY	DATE 28/JUN/13 DATE 28/JUN/13 DATE 28/JUN/13	PART NO. FFC03001-XXSBB114W5M TITLE FPC/FFC connector 0.3mm Bottom contact SMT	ITEM NO. FFC03001 THIS DRAWING CONTAINS INFORMATION THAT IS PROPRIETARY TO TXGA INDUSTRIAL ELECTRONICS(S.Z)CO.,LTD AND SHOULD NOT BE USED WITHOUT WRITTEN PERMISSION	 Leader Of Industry REV 0 SHEET NO. 1/2
---	---	--	--	---	--	--	---

REV	LOCATIONS	DESCRIPTION	DATE	REVISER	APPD

A
B
C
D
E
F

A
B
C
D
E
F

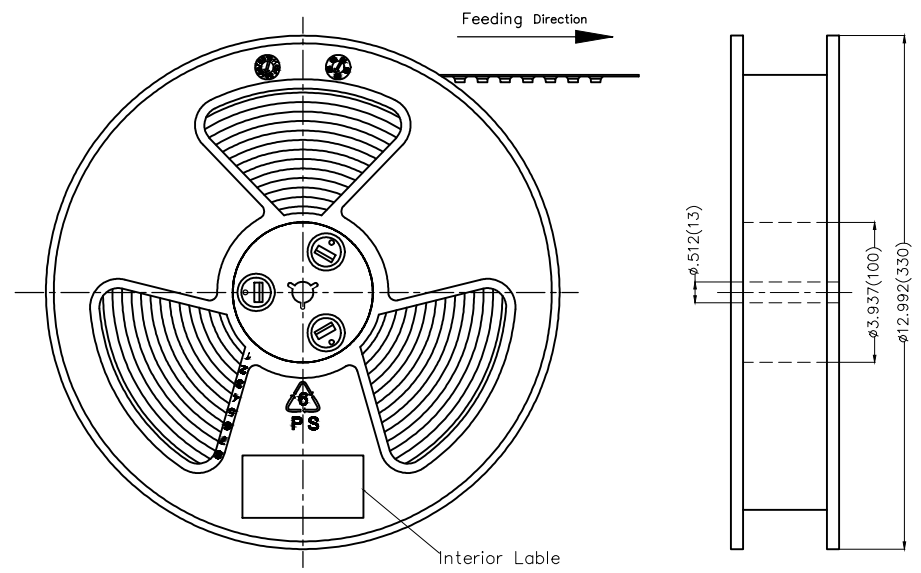

- Note:
- 10 sprocket hole cumulative tolerance ± 0.2
 - Carrier camber is within 1.0mm in 250mm
 - Material: White Conductive polystyrene Alloy 100% recyclable
 - All dimensions meet EIA-481-3 requirements
 - Peel off force of cover tape & carrier tape: 20g~130g(0.2N~1.3N)
 - Component load per 13" reel: 5,000 pcs

Circuits (n)	Dimensions(in/mm)		
	A	B	C
13-25	.630(16.0)	.295(7.5)	—
27-51	.945(24.0)	.453(11.5)	—

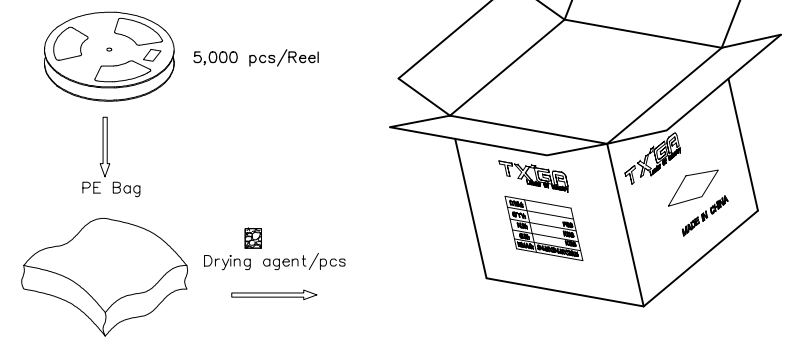
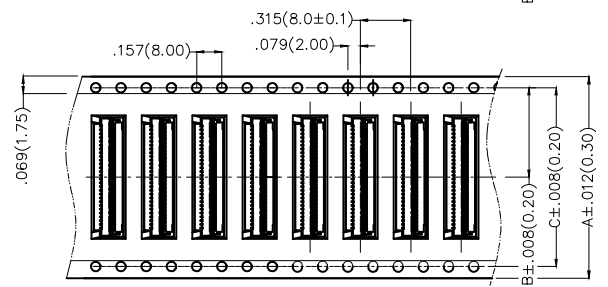
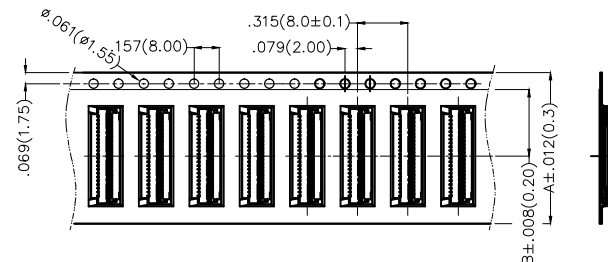
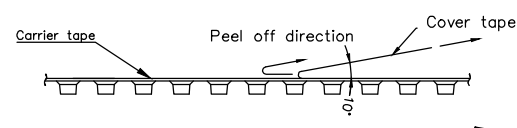
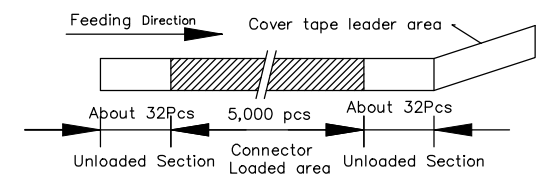

 THIRD ANGLE PROJECTION DESIGN UNITS Inch (metric) SCALE 5:1 SIZE A4	GENERAL TOLERANCES (UNLESS SPECIFIED)		APPROVE BY FRANK	DATE 28/JUN/13	PART NO. FFC03001-XXSBB114W5M	ITEM NO. FFC03001	 Leader Of Industry
	X. \pm .012(0.30)	X.' \pm 5'	CHECKED BY JACOB	DATE 28/JUN/13	TITLE FPC/FFC connector 0.3mm Bottom contact SMT		
	X.XX \pm .008(0.20)	X' \pm 2'	DRAWN BY CHERRY	DATE 28/JUN/13	THIS DRAWING CONTAINS INFORMATION THAT IS PROPRIETARY TO TXGA INDUSTRIAL ELECTRONICS(S.Z)CO.,LTD AND SHOULD NOT BE USED WITHOUT WRITTEN PERMISSION		SHEET NO. 2/2
	X.XX \pm .006(0.15)	.XX' \pm 1'					
	X.XXX \pm .004(0.10)	.XXX' \pm 0.5'					

1 2 3 4 5 6 7 8