

1 2 3 4 5 6 7 8

REV	LOCATIONS	DESCRIPTION	DATE	REVISER	APPD

SPECIFICATIONS

Material
 Body: Aluminium die-cast, powder-coated (Grey)
 Locking element: Galvanized iron

Mechanical
 Temperature Range-Operating: -40°C ~ +125°C
 Degree of protection: IP65 (sealed state)
 Cable entry: Side cable entry

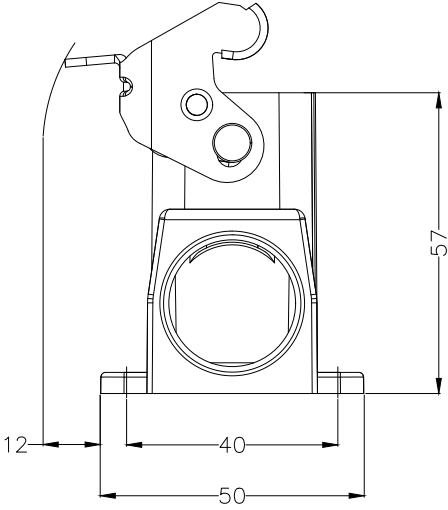
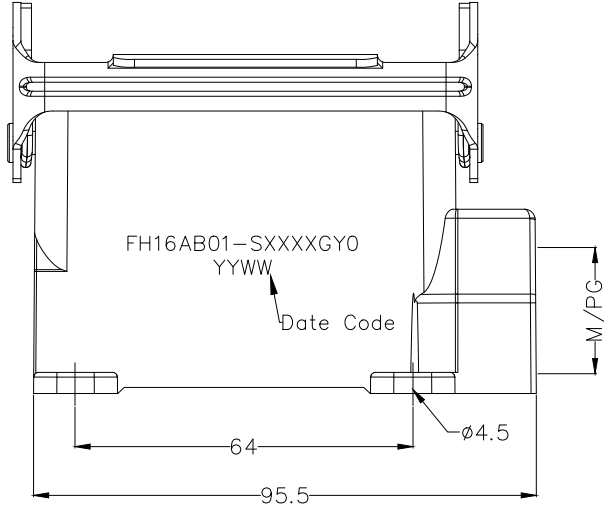
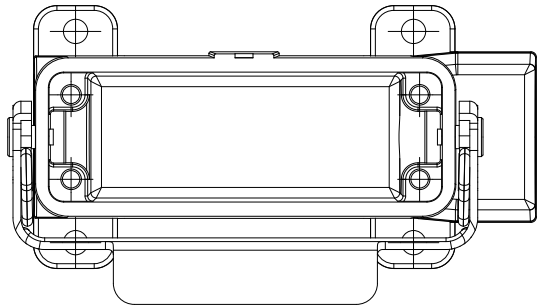

Ordering Information

FH16A B 01 - S XXXX GY 0
 1 2 3 4 5

1 Category FH16A-Shell	2 Style B-Base shell	3 Cable entry S-Side cable entry	4 Thread specification M200-M20 M250-M25 P160-PG16 P210-PG21	5 Color GY-Gray
-----------------------------	---------------------------	---------------------------------------	--	----------------------

Part NO.	Thread size
FH16AB01-SM200GY0	M20
FH16AB01-SM250GY0	M25
FH16AB01-SP160GY0	PG16
FH16AB01-SP210GY0	PG21

 THIRD ANGLE PROJECTION DESIGN UNITS mm SCALE 5:1 SIZE A4	GENERAL TOLERANCES (UNLESS SPECIFIED) X. ±0.30 X.* ±5' X.X ±0.20 X.X* ±2' X.XX ±0.15 X.XX* ±1' X.XXX ±0.10 X.XXX* ±0.5'		APPROVE BY LEO CHECKED BY GISELLE DRAWN BY PYD	DATE 05/Jul/21 DATE 05/Jul/21 DATE 05/Jul/21	PART NO. FH16AB01-SXXXXGY0 TITLE Heavy-duty connector H16A Base shell	ITEM NO. FH16AB01	 Building Technology Cornerstone REV 0 SHEET NO. 1/1
	THIS DRAWING CONTAINS INFORMATION THAT IS PROPRIETARY TO TXGA INDUSTRIAL ELECTRONICS(S.Z)CO.,LTD AND SHOULD NOT BE USED WITHOUT WRITTEN PERMISSION						

1 2 3 4 5 6 7 8