

1 2 3 4 5 6 7 8

REV	LOCATIONS	DESCRIPTION	DATE	REVISER	APPD

SPECIFICATIONS

Material
 Body: Aluminium die-cast, powder-coated (Grey)
 Locking element: Galvanized iron
 Sealing element: NBR

Mechanical
 Temperature Range-Operating: -40°C ~ +125°C
 Degree of protection: IP65 (sealed state)
 Cable entry: Bottom cable entry

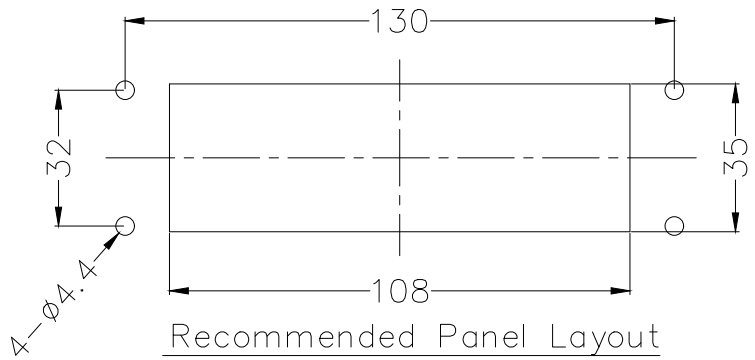
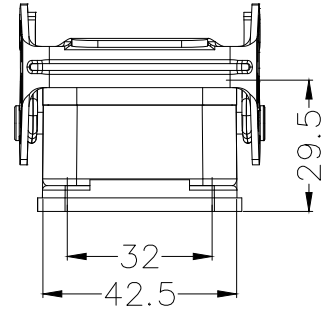
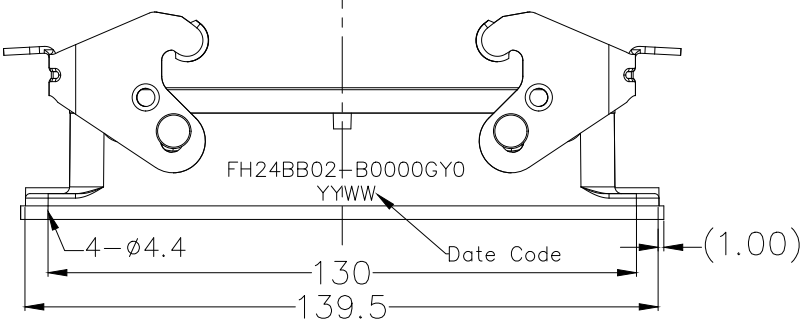
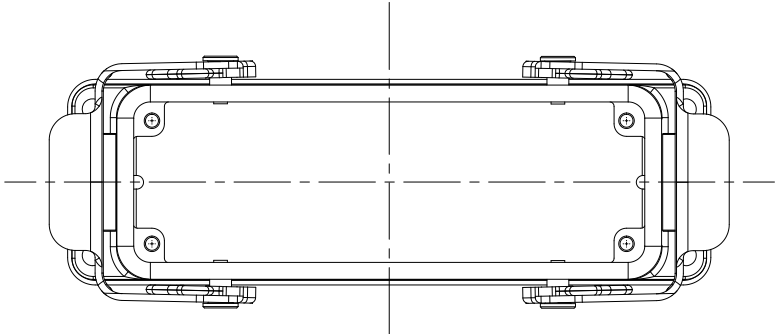

 THIRD ANGLE PROJECTION	GENERAL TOLERANCES (UNLESS SPECIFIED)		APPROVE BY	DATE	PART NO.	ITEM NO.	 Building Technology Cornerstone
	X. \pm 0.30	X.* \pm 5'	LEO	05/Jul/21	FH24BB02-B0000GY0	FH24BB02	
	DESIGN UNITS mm		CHECKED BY	DATE	TITLE		REV 0 SHEET NO. 1/1
	X.X \pm 0.20	X.X' \pm 2'	GISELLE	05/Jul/21	Heavy-duty connector H24B Base shell		
SCALE 5:1	SIZE A4	X.XX \pm 0.15	X.XX' \pm 1'	DRAWN BY	DATE	THIS DRAWING CONTAINS INFORMATION THAT IS PROPRIETARY TO TXGA INDUSTRIAL ELECTRONICS(S.Z)CO.,LTD AND SHOULD NOT BE USED WITHOUT WRITTEN PERMISSION	
		X.XXX \pm 0.10	X.XXX' \pm 0.5'	PYD	05/Jul/21		

1 2 3 4 5 6 7 8