

1 2 3 4 5 6 7 8

| REV | LOCATIONS | DESCRIPTION | DATE | REVISER | APPD |
|-----|-----------|-------------|------|---------|------|
| | | | | | |

SPECIFICATION

Technical Parameters
 No. of contact: 2
 Rated current: 100A
 Rated voltage: 1000V
 Rated impulse voltage: 8KV
 Contact resistance: 0.3mΩ MAX
 Rated voltage acc.to UL: 600V
 Insulation resistance: 10¹⁰Ω MIN
 Temperature range: -40°C~+125°C
 Pollution degree: 3
 Wire gauge: 10-25mm²
 Stripping length: 13mm
 Tightening Torque:
 10-16mm²(6N.m);
 25mm²(7N.m);
 35mm²(8N.m)
 Wrench Size: SW 4

Mechanical
 Connection method: Screw locking
 Durability: 500 cycles MIN

Material and Plating
 Insulators: PC(UL 94V-0), Light grey
 Terminal: copper alloy, 3μm silver plated
 Screw: Iron nickel plated

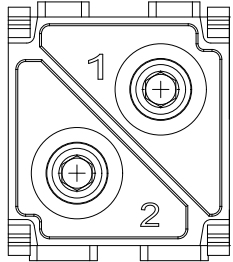
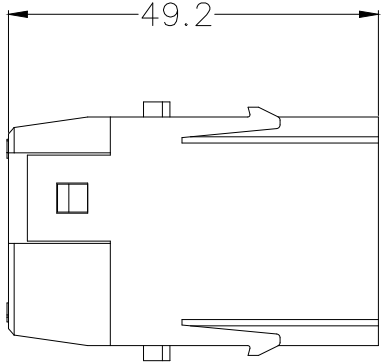
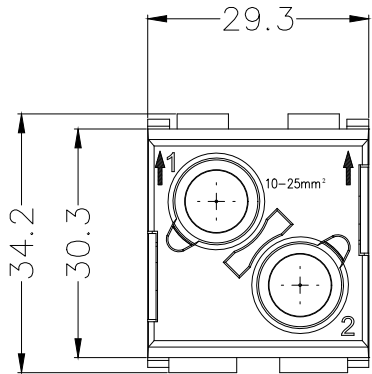
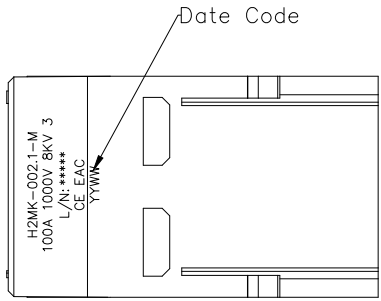

| | | | | | | | |
|-------------------------------|---------------------------------------|-------------|--------------|-----------|----------------------------------|--|--|
| <p>THIRD ANGLE PROJECTION</p> | GENERAL TOLERANCES (UNLESS SPECIFIED) | | APPROVE BY | DATE | PART NO. | ITEM NO. | <p>Building Technology Cornerstone</p> |
| | X. ±0.30 | X.* ±5' | LEO | 05/Jul/21 | FH2MK001-M0024GYE0 | FH2MK002 | |
| | DESIGN UNITS mm | | CHECKED BY | DATE | TITLE | | REV 0 SHEET NO. 1/1 |
| | X.X ±0.20 | X.X' ±2' | GISELLE | 05/Jul/21 | Heavy-duty connector H2MK Insert | | |
| SCALE 5:1 | SIZE A4 | X.XX ±0.15 | X.XX' ±1' | DRAWN BY | DATE | THIS DRAWING CONTAINS INFORMATION THAT IS PROPRIETARY TO TXGA INDUSTRIAL ELECTRONICS(S.Z)CO.,LTD AND SHOULD NOT BE USED WITHOUT WRITTEN PERMISSION | |
| | | X.XXX ±0.10 | X.XXX' ±0.5' | PYD | 05/Jul/21 | | |

1 2 3 4 5 6 7 8

A
B
C
D
E
F

A
B
C
D
E
F