

REV	LOCATIONS	DESCRIPTION	DATE	REVISER	APPD

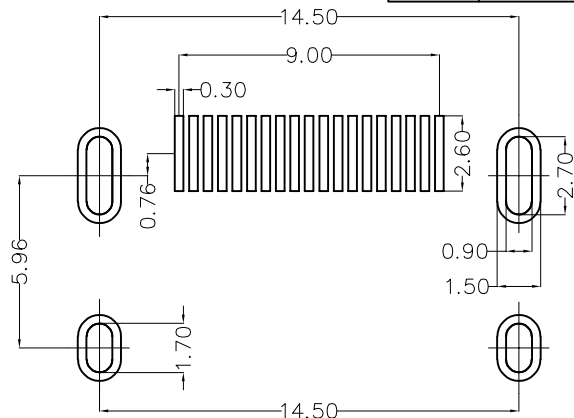
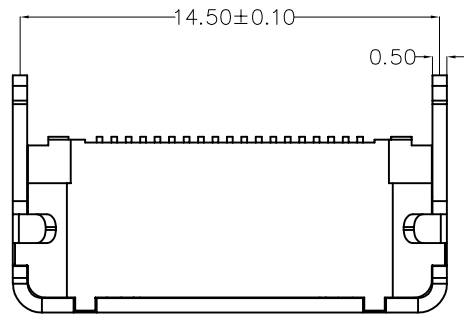

Recommended P.C.Board Layout
Tolerance: ±.002(±0.05)

SPECIFICATIONS

Electrical

Current Rating: 0.5A AC(rms)/DC
Voltage Rating: 40V AC(rms)/DC
Contact Resistance: 30 mΩ Max
Insulation Resistance: 100 MΩ Min
Withstanding Voltage: 500V AC r.m.s

Mechanical

Mating force: 4.4KG.F Max
Retention force: 0.5-4.0KG.F
Durability: 5000 cycles Min.

Environmental

Operating Temperature: -25°C~+85°C

Material and plating

Housing: LCP (UL 94V-0), Black
Contacts: Copper Alloy/Gold plated on contact, Matte Tin plated on tail
Shell: SPCC/Nikel plated

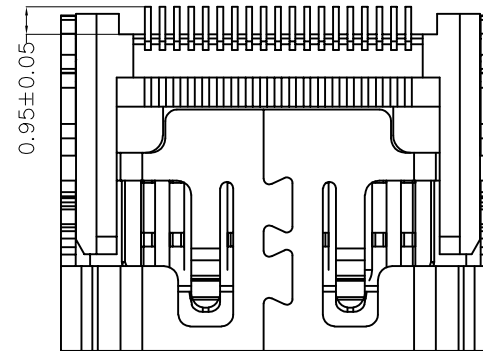
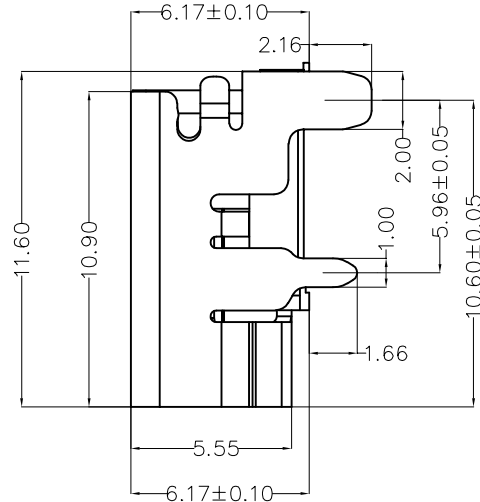
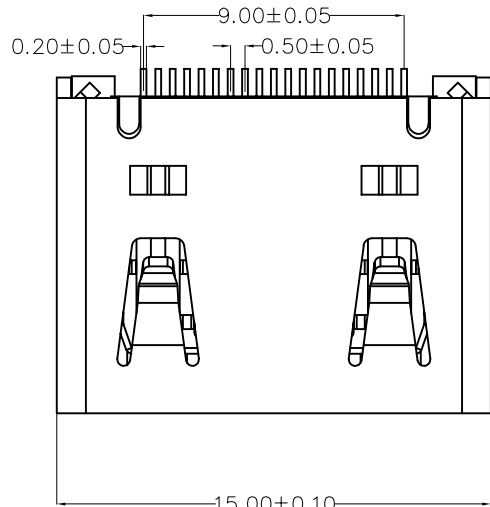

Pin	Signal Assignment	Pin	Signal Assignment
1	Hot Plug Detect	11	TMDS Data0-
2	Utility	12	TMDS Clock+
3	TMDS Data2+	13	TMDS Clock Shield
4	TMDS Data2 Shield	14	TMDS Clock-
5	TMDS Data2-	15	CEC
6	TMDS Data1+	16	DDC/CEG Ground
7	TMDS Data1 Shield	17	SCL
8	TMDS Data1-	18	SDA
9	TMDS Data0+	19	+5V Power
10	TMDS Data0 Shield	/	/

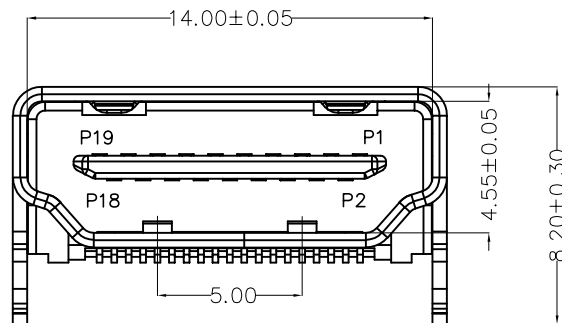

<p>THIRD ANGLE PROJECTION</p>	GENERAL TOLERANCES (UNLESS SPECIFIED)		APPROVE BY FRANK	DATE 15/AUG/22	PART NO. FHD37-FSB700BKMA	ITEM NO. FHD37
	X.±0.30	X.'±5'	CHECKED BY CHERRY	DATE 15/AUG/22	TITLE HDMI A/F 90'(SMT)	
	X.XX±0.20	.X'±2'	DRAWN BY QING	DATE 15/AUG/22	THIS DRAWING CONTAINS INFORMATION THAT IS PROPRIETARY TO TXGA INDUSTRIAL ELECTRONICS(S.Z)CO.,LTD AND SHOULD NOT BE USED WITHOUT WRITTEN PERMISSION	
	X.XX±0.15	.XX'±1'			REV 0	SHEET NO. 1/1
SCALE 5:1	SIZE A4	X.XXX±0.10	.XXX'±0.5'			



REV	LOCATIONS	DESCRIPTION	DATE	REVISER	APPD

- Note:
- 1.10 sprocket hole cumulative tolerance ± 0.2
 2. Carrier camber is within 1.0mm in 250mm
 3. Material: Clear conductive polystyrene Alloy 100% recyclable
 4. All dimensions meet EIA-481-3 requirements
 5. Peel off force of cover tape & carrier tape: 20g~130g (0.2N~1.3N)
 6. Component load per 13" reel: 500 pcs

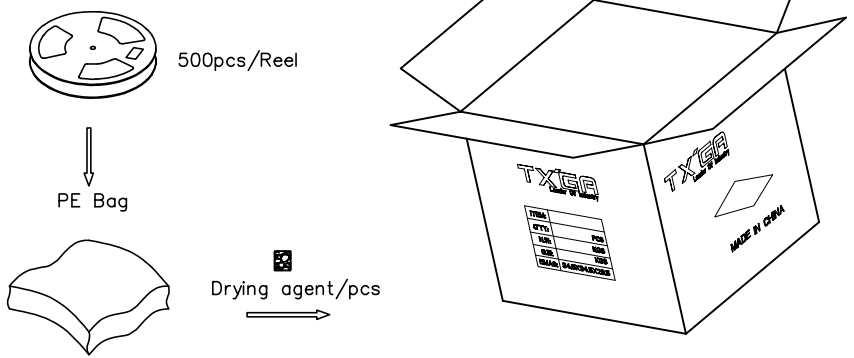
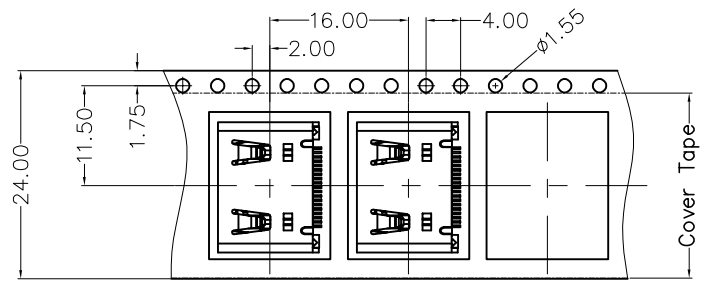
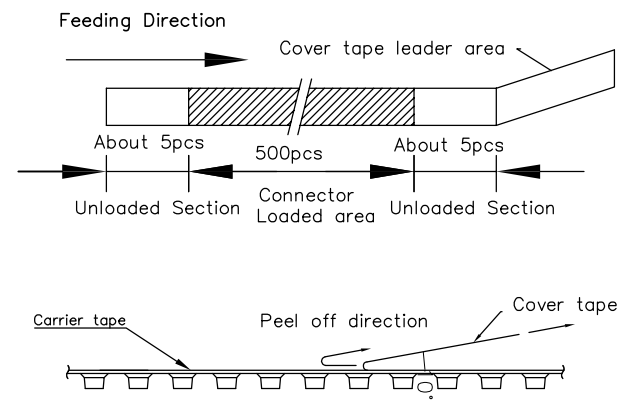
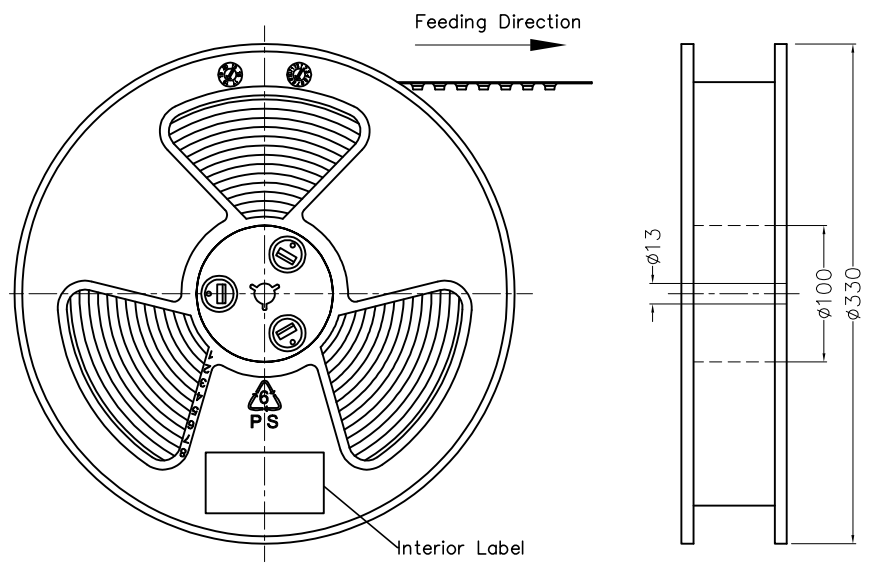

 THIRD ANGLE PROJECTION	GENERAL TOLERANCES (UNLESS SPECIFIED)		APPROVE BY FRANK	DATE 15/AUG/22	PART NO. FHD37-FSB700BKMA	ITEM NO. FHD37	 Leader Of Industry	
	X.±0.30	X.±5'	CHECKED BY CHERRY	DATE 15/AUG/22	TITLE HDMI A/F 90'(SMT)			
DESIGN UNITS (metric)	X.X±0.20	.X'±2'	DRAWN BY QING	DATE 15/AUG/22	THIS DRAWING CONTAINS INFORMATION THAT IS PROPRIETARY TO TXGA INDUSTRIAL ELECTRONICS(S.Z)CO.,LTD AND SHOULD NOT BE USED WITHOUT WRITTEN PERMISSION		REV 0	SHEET NO. 2/2
SCALE	SIZE A4	X.XX±0.15	.XX'±1"					
		X.XXX±0.10	.XXX'±0.5"					