

REV	LOCATIONS	DESCRIPTION	DATE	REVISER	APPD

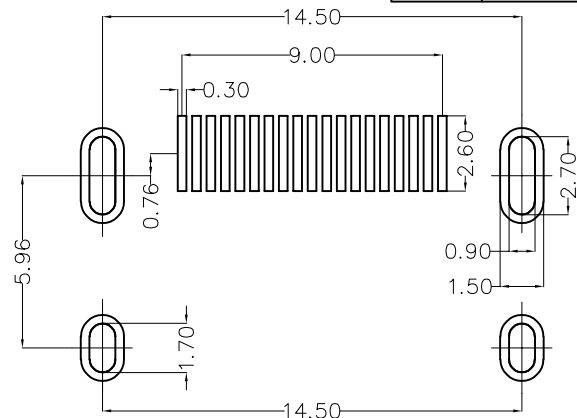
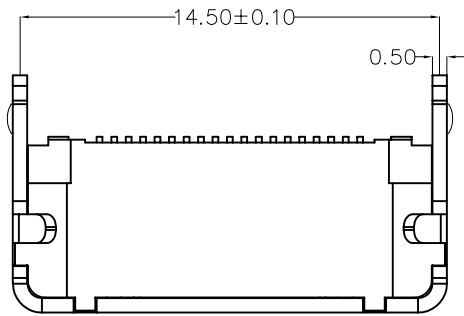

Recommended P.C.Board Layout

Tolerance: $\pm 0.002(\pm 0.05)$

SPECIFICATIONS

Electrical

Current Rating: 0.5A AC(rms)/DC
Voltage Rating: 40V AC(rms)/DC
Contact Resistance: 30 mΩ Max
Insulation Resistance: 100 MΩ Min
Withstanding Voltage: 500V AC r.m.s

Mechanical

Mating force: 4.4KG.F Max
Retention force: 0.5-4.0KG.F
Durability: 5000 cycles Min.

Environmental

Operating Temperature: $-25^{\circ}\text{C}\sim+85^{\circ}\text{C}$

Material and plating

Housing: LCP (UL 94V-0), Black
Contacts: Copper Alloy/Gold plated on contact, Matte Tin plated on tail
Shell: Copper Alloy/Nikel plated

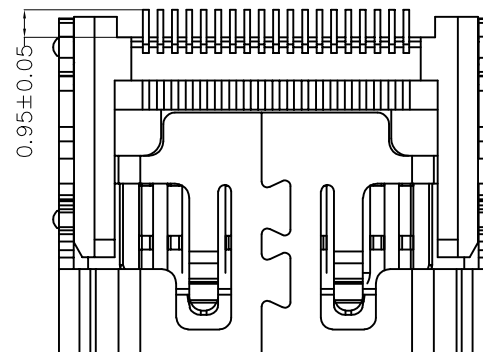
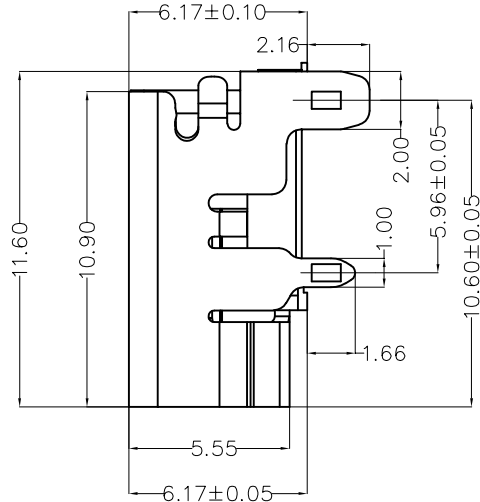
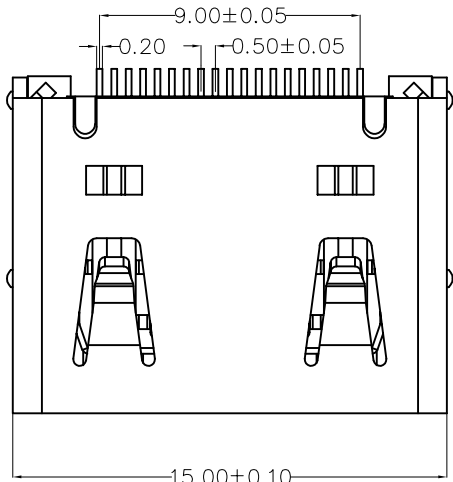

Pin	Signal Assignment	Pin	Signal Assignment
1	TMDS Data2+	2	TMDS Data2 Shield
3	TMDS Data2-	4	TMDS Data1+
5	TMDS Data1 Shield	6	TMDS Data1-
7	TMDS Data0+	8	TMDS Data0 Shield
9	TMDS Data0-	10	TMDS Clock+
11	TMDS Clock Shield	12	TMDS Clock-
13	CEC	14	Reserved (N.C. on device)
15	SCL	16	SDA
17	DDC/CEC Ground	18	+5V Power
19	Hot Plug Detect	/	/

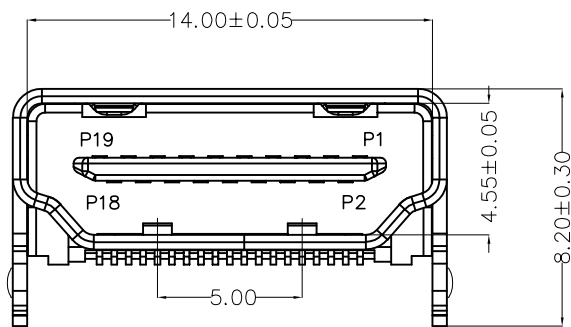

 THIRD ANGLE PROJECTION	GENERAL TOLERANCES (UNLESS SPECIFIED)		APPROVE BY FRANK	DATE 15/AUG/22
	X.±0.30	X.±5°	CHECKED BY CHERRY	DATE 15/AUG/22
	X.XX±0.15	.XX'±1"	DRAWN BY QING	DATE 15/AUG/22
	X.XXX±0.10	.XXX'±0.5"		
DESIGN UNITS (metric)				
SCALE 5:1	SIZE A4			

PART NO. FHD38-FSB700BKM	ITEM NO. FHD38	 Leader Of Industry
TITLE HDMI A/F 90'(SMT)		
THIS DRAWING CONTAINS INFORMATION THAT IS PROPRIETARY TO TXGA INDUSTRIAL ELECTRONICS(S.Z)CO.,LTD AND SHOULD NOT BE USED WITHOUT WRITTEN PERMISSION		REV 0 SHEET NO. 1/1

1 2 3 4 5 6 7 8

REV	LOCATIONS	DESCRIPTION	DATE	REVISER	APPD

A
B
C
D
E
F

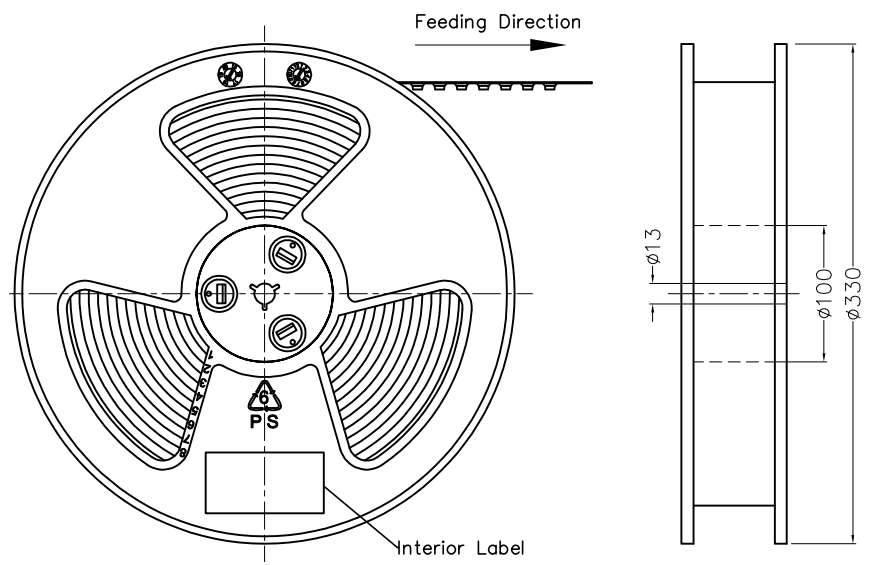

- Note:
- 1.10 sprocket hole cumulative tolerance ± 0.2
 2. Carrier camber is within 1.0mm in 250mm
 3. Material: Clear conductive polystyrene Alloy 100% recyclable
 4. All dimensions meet EIA-481-3 requirements
 5. Peel off force of cover tape & carrier tape: 20g~130g (0.2N~1.3N)
 6. Component load per 13" reel: 500 pcs

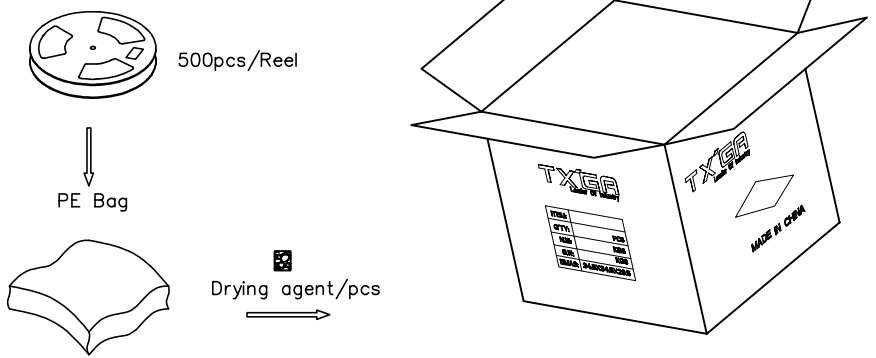
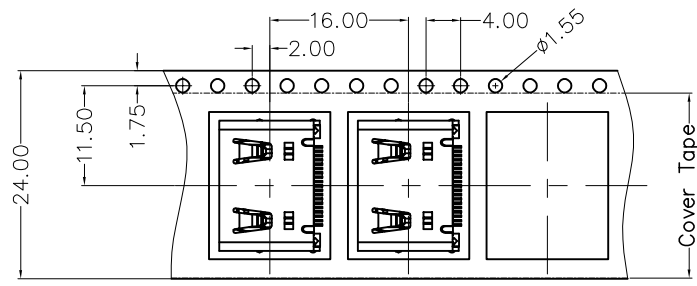
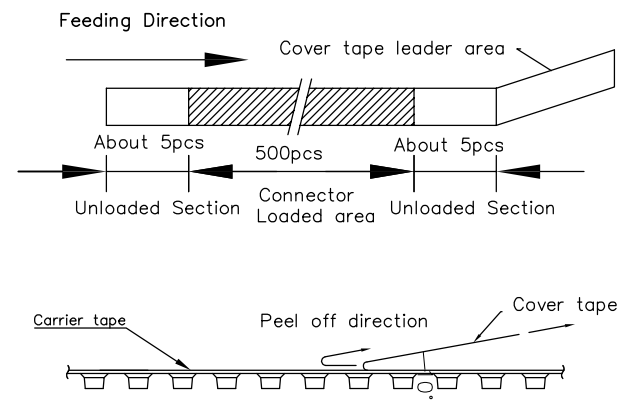

 THIRD ANGLE PROJECTION	GENERAL TOLERANCES (UNLESS SPECIFIED)		APPROVE BY FRANK	DATE 15/AUG/22	PART NO. FHD38-FSB700BKM	ITEM NO. FHD38	 Leader Of Industry	
	X.±0.30	X.±5'	CHECKED BY CHERRY	DATE 15/AUG/22	TITLE HDMI A/F 90'(SMT)			
DESIGN UNITS (metric)	X.X±0.20	.X'±2'	DRAWN BY QING	DATE 15/AUG/22	THIS DRAWING CONTAINS INFORMATION THAT IS PROPRIETARY TO TXGA INDUSTRIAL ELECTRONICS(S.Z)CO.,LTD AND SHOULD NOT BE USED WITHOUT WRITTEN PERMISSION		REV 0	SHEET NO. 2/2
SCALE	SIZE A4	X.XX±0.15	.XX'±1"					
		X.XXX±0.10	.XXX'±0.5"					

1 2 3 4 5 6 7 8