

REV	LOCATIONS	DESCRIPTION	DATE	REVISER	APPD

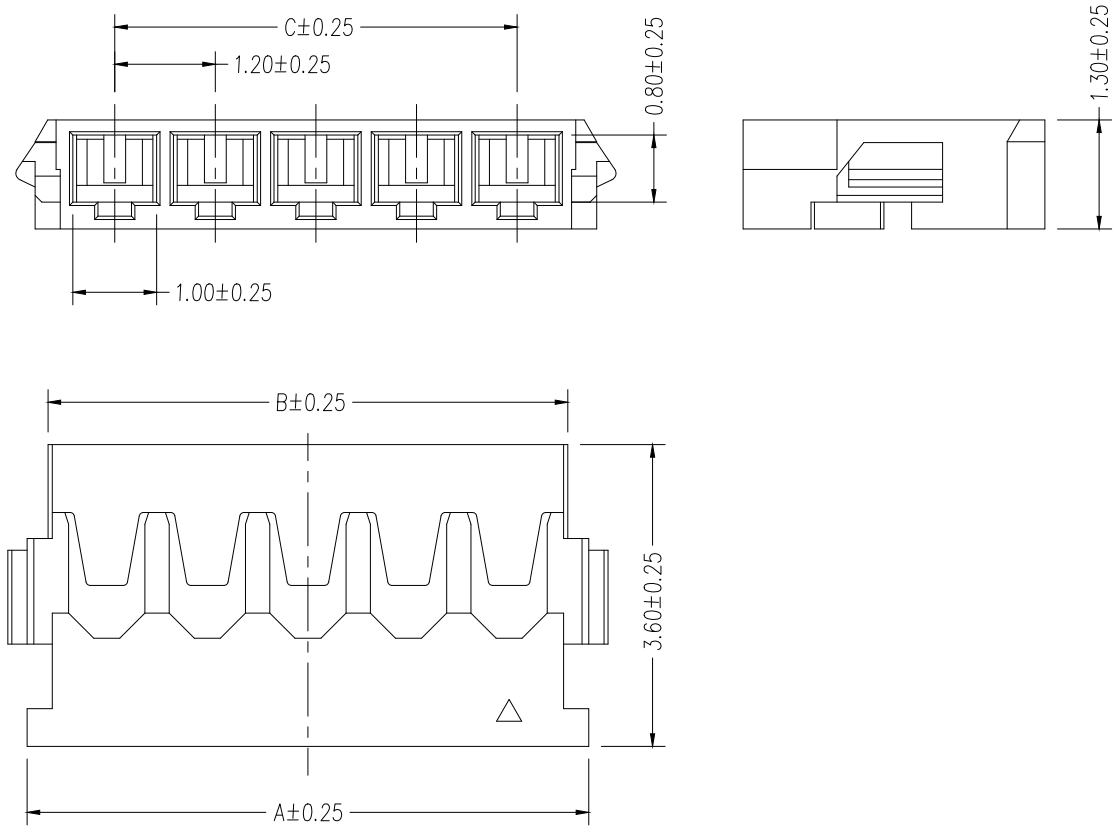

Circuits (n)	Part NO.	Dimensions		
		A	B	C
2	FHG12003-S02M3BKB	3.10	2.60	1.20
3	FHG12003-S03M3BKB	4.30	3.80	2.40
4	FHG12003-S04M3BKB	5.50	5.00	3.60
5	FHG12003-S05M3BKB	6.70	6.20	4.80
6	FHG12003-S06M3BKB	7.90	7.40	6.00
7	FHG12003-S07M3BKB	9.10	8.60	7.20
8	FHG12003-S08M3BKB	10.30	9.80	8.40
9	FHG12003-S09M3BKB	11.50	11.00	9.60
10	FHG12003-S10M3BKB	12.70	12.20	10.80
11	FHG12003-S11M3BKB	13.90	13.40	12.00
12	FHG12003-S12M3BKB	15.10	14.60	13.20

Ordering Information

FHG 120 03 - S XX M 3 BK B
 1 2 3 4 5 6 7 8 9

1	Category	2	Series Number	3	Distinction No.	4	Row Option		
	FHG-Housing		120-Pitch1.20mm		03		S-Single row		
5	Circuits	6	Gender	7	Material-Resin	8	Color-Resin	9	Packaging
	XX		M-Male		3-LCP		BK-Black		B-Bag

SPECIFICATIONS

Electrical

Current Rating: 1.5A AC/DC
 Voltage Rating: 50V AC/DC
 Contact Resistance: 20mΩ MAX
 Insulation Resistance: 100 MΩ MIN
 Withstanding Voltage: 500V AC/minute
 Temperature Range-Operating: -40°C~+105°C
 Material: LCP, UL94V-0,Black
 Applicable Terminal: FT12003
 Mates With Socket: FWF12003 Series

 THIRD ANGLE PROJECTION	GENERAL TOLERANCES (UNLESS SPECIFIED)		APPROVE BY	DATE	PART NO.	ITEM NO.	 Building Technology Cornerstone REV 0 SHEET NO. 1/1
	X. ±0.30	X.* ±5'	CHECKED BY	DATE	FHG12003-SXXM3BKB	FHG12003	
	X.X ±0.20	X.X' ±2'	GISELLE	21/Oct/21			
	X.XX ±0.15	X.XX' ±1'	DRAWN BY	DATE	THIS DRAWING CONTAINS INFORMATION THAT IS PROPRIETARY TO TXGA INDUSTRIAL ELECTRONICS(S.Z)CO.,LTD AND SHOULD NOT BE USED WITHOUT WRITTEN PERMISSION		
SCALE	SIZE	X.XXX ±0.10	X.XXX' ±0.5'	PYD	21/Oct/21		
5:1	A4						