

REV	LOCATIONS	DESCRIPTION	DATE	REVISER	APPD
1	Δ	Add dimensions	07/SEP/18	KATE	FRANK

Electrical
 Temperature Range—Operating: -25°C~+85°C
 Material
 Housing: PA46(UL 94V-0)
 Applicable Terminal: FT12502
 Mates With(Wafer): FWF12508,FWF12509 Series.

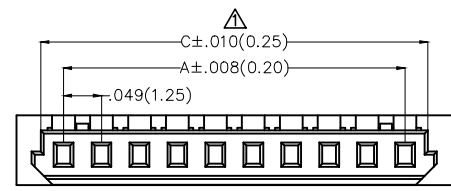
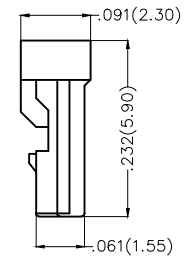
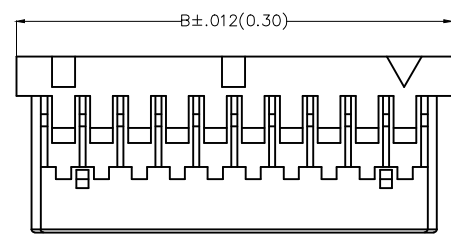

Circuits (n)	Part No.	Dimensions(in/mm)		
		A	B	C Δ
20	FHG12503-S20M2W5B	.935(23.75)	1.053(26.75)	.994(25.25)
30	FHG12503-S30M2W5B	1.427(36.25)	1.545(39.25)	1.486(37.75)

Ordering Information

FHG 125 03 — S XX M 2 W5 B
 1 2 3 4 5 6 7 8 9

1	Category FHG-Housing	2	Series Number 125-Pitch1.25mm	3	Distinction No. 03	4	Row Option S-Single Row	5	Circuits XX
6	Entry Type M-Male	7	Material-Resin 2-PA46	8	Color-Resin W5-White	9	Packaging B-PE Bag		

 THIRD ANGLE PROJECTION	GENERAL TOLERANCES (UNLESS SPECIFIED)		APPROVE BY FRANK	DATE 25/JUN/13	PART NO. FHG12503-SXXM2W5B	ITEM NO. FHG12503	 Leader Of Industry	
	DESIGN UNITS Inch (metric)	X.X±.012(0.30)	X.'±5'	CHECKED BY JACOB	DATE 25/JUN/13	TITLE Wire to Board Pitch 1.25mm(Housing)		REV 1
SCALE 5:1	SIZE A4	X.XX±.006(0.15)	.XX'±1'	DRAWN BY CHERRY	DATE 25/JUN/13	THIS DRAWING CONTAINS INFORMATION THAT IS PROPRIETARY TO TXGA INDUSTRIAL ELECTRONICS(S.Z)CO.,LTD AND SHOULD NOT BE USED WITHOUT WRITTEN PERMISSION		
		X.XXX±.004(0.10)	.XXX'±0.5'					