

REV	LOCATIONS	DESCRIPTION	DATE	REVISER	APPD

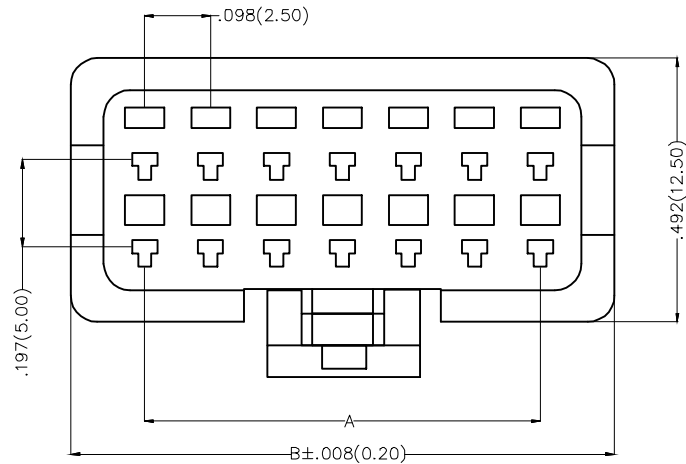

Electrical

Current Rating: 2.5A AC(rms)/DC
Voltage Rating: 250V AC(rms)/DC
Contact Resistance: 20m Ω Max
Insulation Resistance: 1000 M Ω MIN
Withstanding Voltage: 800V AC r.m.s
Temperature Range—Operating: -25°C~+85°C

Material and Plating

Housing: PA66 (UL 94V-2)
Applicable Terminal: FT25016
Mates With : FHG25016 Series.

Circuits (n)	Part No.	Dimensions(in/mm)	
		A	B
14	FHG25017-D14F2K6B	.591(15.00)	.807(20.50)
18	FHG25017-D18F2K6B	.787(20.00)	1.004(25.50)

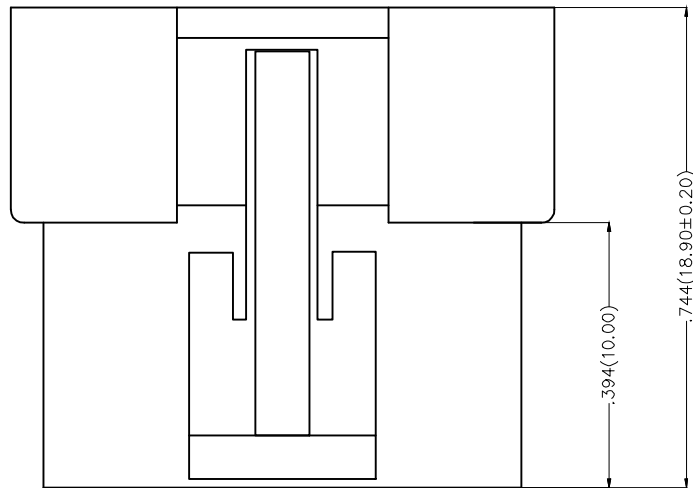

Ordering Information

FHG 250 17 - D XX F 2 K6 B
1 2 3 4 5 6 7 8 9

1 Category FHG—Housing	2 Series Number 250—Pitch2.50mm	3 Distinction No. 17	4 Row Option D—Double row
5 Circuits XX	6 Type F—Female	7 Material—Resin 2—PA66	8 Color—Resin K6—Black
			9 Packaging B—PE Bag

 THIRD ANGLE PROJECTION	GENERAL TOLERANCES (UNLESS SPECIFIED)		APPROVE BY FRANK	DATE 29/JUN/17	PART NO. FHG25017-DXXF2K6B	ITEM NO. FHG25017	 Leader Of Industry	
	DESIGN UNITS Inch (metric)	X.±.012(0.30)	X.'±5'	CHECKED BY CHERRY	DATE 29/JUN/17	TITLE Wire to Wire Pitch 2.5mm(Housing)		REV 0
SCALE 5:1	SIZE A4	X.XX±.006(0.15)	.XX'±1'	DRAWN BY LXF	DATE 29/JUN/17	THIS DRAWING CONTAINS INFORMATION THAT IS PROPRIETARY TO TXGA INDUSTRIAL ELECTRONICS(S.Z)CO.,LTD AND SHOULD NOT BE USED WITHOUT WRITTEN PERMISSION		
		X.XXX±.004(0.10)	.XXX'±0.5'					