

1 2 3 4 5 6 7 8

Part NO.	Dimensions		REV	LOCATIONS	DESCRIPTION	DATE	REVISER	APPD
	A	B						
FHG36501-D04F2NAB	3.65	8.70						
FHG36501-D06F2NAB	7.30	12.35						
FHG36501-D08F2NAB	10.95	16.00						

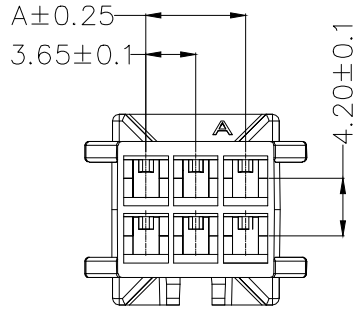

SPECIFICATION

Rated Current: 5A MAX
 Rated Voltage: 250V (AC/DC)
 Withstand Voltage: 1000V AC/minute
 Contact Resistance: 20mΩ MAX
 Insulation Resistance: 1000MΩ MIN
 Temperature Range: -25°C~+85°C
 Housing: PA66(UL 94V-0), Natural
 Applicable Terminal: FT36501-M
 Mates With Housing: FHG36502 Series

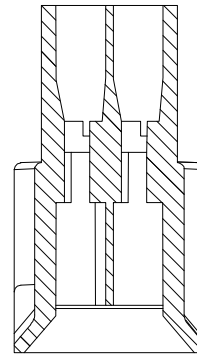
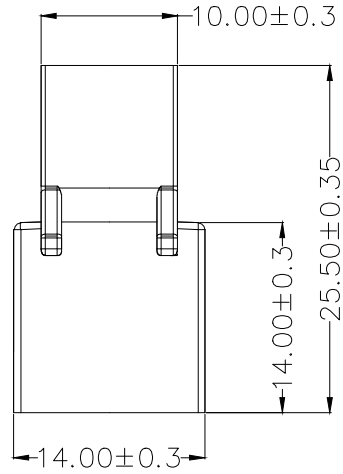
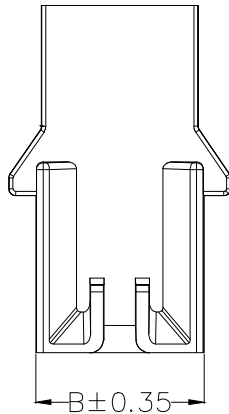
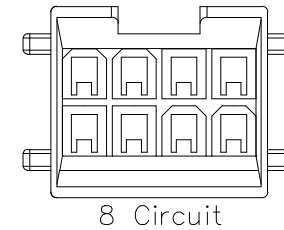
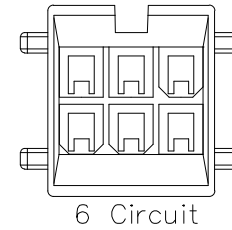
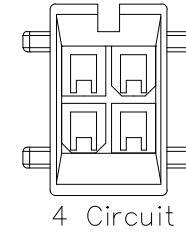

Section A-A

Ordering Information

FHG 365 01 - D XX F 2 NA B
 1 2 3 4 5 6 7 8 9

1	Category FHG-Housing	2	Series Number 365-Pitch 3.65mm	3	Distinction No. 01	4	Row Option D-Double row		
5	Circuits XX	6	Gender F-Female	7	Material-Resin 2-PA66	8	Color-Resin NA-Natural	9	Packaging B-Bag

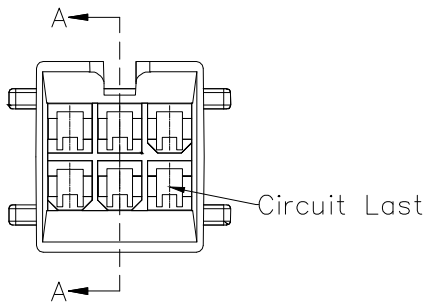

 THIRD ANGLE PROJECTION DESIGN UNITS mm SCALE 5:1 SIZE A4	GENERAL TOLERANCES (UNLESS SPECIFIED)		APPROVE BY	DATE	PART NO.	ITEM NO.	 Building Technology Cornerstone REV 0 SHEET NO. 1/1
	X. ±0.30	X.* ±5'	LEO	26/SEP/21	FHG36501-DXXF2NAB	FHG36501	
	X.X ±0.20	X.X' ±2'	CHECKED BY	DATE	TITLE		
	X.XX ±0.15	X.XX' ±1'	GISELLE	26/SEP/21	Wire to Board Pitch 3.65mm (Housing)		
X.XXX ±0.10	X.XXX' ±0.5'	DRAWN BY	DATE	THIS DRAWING CONTAINS INFORMATION THAT IS PROPRIETARY TO TXGA INDUSTRIAL ELECTRONICS(S.Z)CO.,LTD AND SHOULD NOT BE USED WITHOUT WRITTEN PERMISSION			
		PYD	26/SEP/21				

1 2 3 4 5 6 7 8