

1 2 3 4 5 6 7 8

| REV | LOCATIONS | DESCRIPTION | DATE | REVISER | APPD |
|-----|-----------|-------------|------|---------|------|
| | | | | | |

A

A

SPECIFICATIONS
 Material: POM(UL 94V-HB),Black
 Internal diameter(ID): 3.0mm
 Working pressure: up to 8 bar/116 psi
 Durability: 500 cycles MIN

B

B

C

C

D

D

E

E

F

F

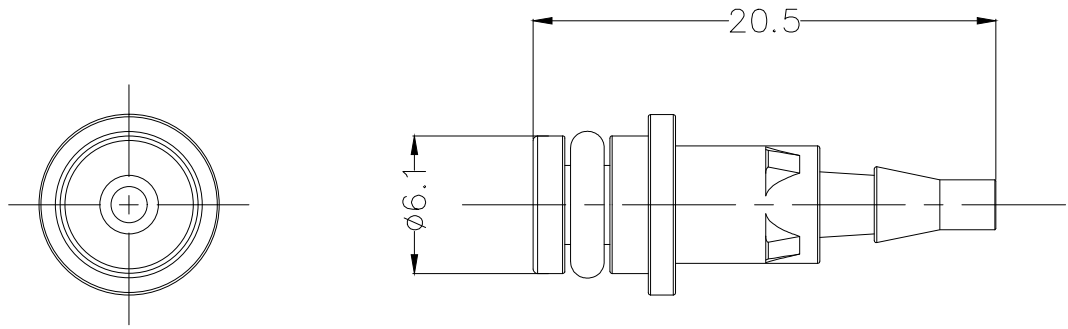

| | | | | | | | | |
|----------------------------|---------------------------------------|-------------|--------------|-----------|--|----------|--|---------------|
| THIRD ANGLE PROJECTION | GENERAL TOLERANCES (UNLESS SPECIFIED) | | APPROVE BY | DATE | PART NO. | ITEM NO. | Building Technology Cornerstone | |
| | X. ±0.30 | X.* ±5' | LEO | 30/JUN/21 | FHPC01-M030BK0 | FHPC01 | | |
| | DESIGN UNITS mm | | CHECKED BY | DATE | TITLE | | REV 0 | SHEET NO. 1/1 |
| | SCALE 5:1 | SIZE A4 | GISELLE | 30/JUN/21 | Heavy-duty connector PCM Pneumatic insert | | THIS DRAWING CONTAINS INFORMATION THAT IS PROPRIETARY TO TXGA INDUSTRIAL ELECTRONICS(S.Z)CO.,LTD AND SHOULD NOT BE USED WITHOUT WRITTEN PERMISSION | |
| | | X.XX ±0.15 | X.XX' ±1' | DRAWN BY | DATE | | | |
| | | X.XXX ±0.10 | X.XXX' ±0.5' | PYD | 30/JUN/21 | | | |

1 2 3 4 5 6 7 8