

REV	LOCATIONS	DESCRIPTION	DATE	REVISER	APPD

SPECIFICATION

Technical Parameters  
 No. of contact: 5+PE  
 Rated current: 16A  
 Phase-to-earth rated voltage: 230V  
 Phase-to-phase rated voltage: 400V  
 Rated impulse voltage: 4KV  
 Insulation resistance: 10<sup>10</sup>Ω MIN  
 Temperature range: -40°C~+125°C  
 Pollution degree: 3

Mechanical  
 Connection method: Riveting  
 Durability: 500 cycles MIN

Material and Plating  
 Insulators: PC(UL 94V-0), Light grey  
 Terminal: copper alloy, 1μm silver plated  
 Clamping Screw: Brass  
 Mounting Screw: Iron nickel plated  
 Sealing element: NBR

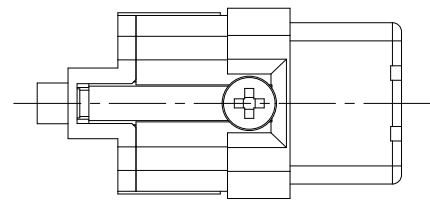
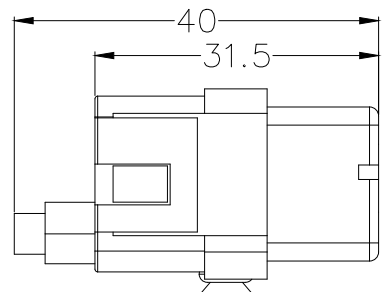
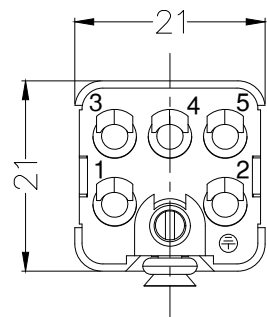
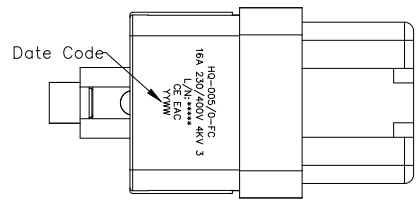

 THIRD ANGLE PROJECTION	GENERAL TOLERANCES (UNLESS SPECIFIED)		APPROVE BY	DATE	PART NO.	ITEM NO.	 Building Technology Cornerstone	
	X. ±0.30	X.* ±5'	LEO	05/Jul/21	FHQ00002-F0054GYE0	FHQ00002		
	DESIGN UNITS mm		CHECKED BY	DATE	TITLE		REV 0	SHEET NO. 1/1
	X.X ±0.20	X.X' ±2'	GISELLE	05/Jul/21	Heavy-duty connector HQ Insert			
SCALE 5:1	SIZE A4	X.XX ±0.15	X.XX' ±1'	DRAWN BY	DATE	THIS DRAWING CONTAINS INFORMATION THAT IS PROPRIETARY TO TXGA INDUSTRIAL ELECTRONICS(S.Z)CO.,LTD AND SHOULD NOT BE USED WITHOUT WRITTEN PERMISSION		
		X.XXX ±0.10	X.XXX' ±0.5'	PYD	05/Jul/21			