

REV	LOCATIONS	DESCRIPTION	DATE	REVISED	APPD
1	△	Size changes	28/APR/21	KATE	CHERRY

SPECIFICATIONS

Electrical

Current Rating: 1.0A AC(rms)/DC
Voltage Rating: 250V AC(rms)/DC
Contact Resistance: 20 mΩ Max
Insulation Resistance: 1000 MΩ MIN
Withstanding Voltage: 500V AC r.m.s
Temperature Range—Operating: -40°C ~ +105°C

Material and Plating

Housing: PBT (UL94V-0)
Contact: Brass
Plating: Gold flash in contact area, nickel on tail

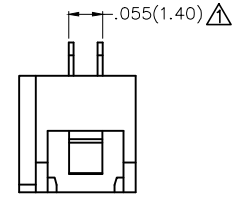
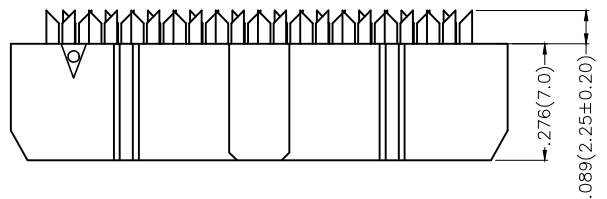
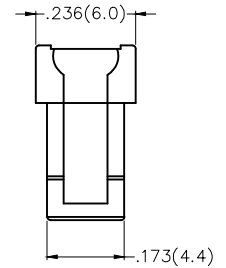
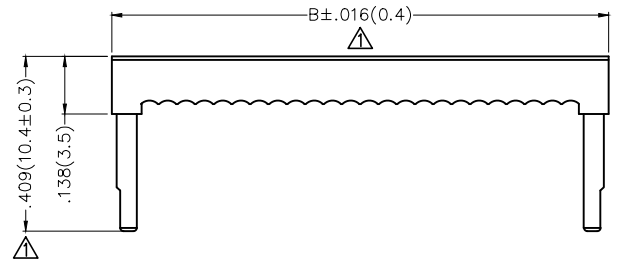

Ordering Information

FID 254 05 — XX 3 K6 K
1 2 3 4 5 6 7

1 Category	2 Series Number	3 Distinction No.	4 Circuits	5 Plating	6 Color—Resin	7 Packaging
FID-DC	254—Pitch2.54mm	05	XX	3—Gold flash in contact area, nickel on tail	K6—Black	K—Tray

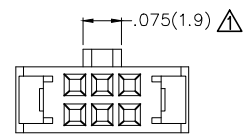
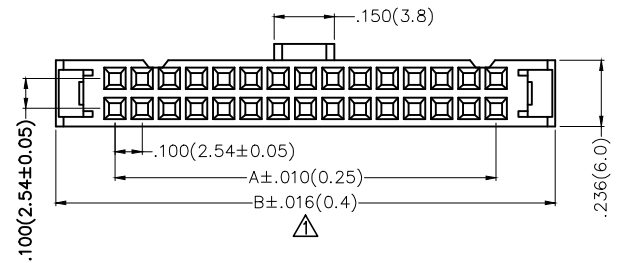

6 Circuits

Circuits (n)	Part No.	Dimensions(in/mm)		Circuits (n)	Part No.	Dimensions(in/mm)	
		A	B			A	B
6	FID25405-063K6K	.200(5.08)	.485(12.32)	26	FID25405-263K6K	1.200(30.48)	1.485(37.72)
8	FID25405-083K6K	.300(7.62)	.585(14.86)	30	FID25405-303K6K	1.400(35.56)	1.685(42.80)
10	FID25405-103K6K	.400(10.16)	.685(17.40)	34	FID25405-343K6K	1.600(40.64)	1.885(47.88)
12	FID25405-123K6K	.500(12.70)	.785(19.94)	36	FID25405-363K6K	1.700(43.18)	1.985(50.42)
14	FID25405-143K6K	.600(15.24)	.885(22.48)	40	FID25405-403K6K	1.900(48.26)	2.185(55.50)
16	FID25405-163K6K	.700(17.78)	.985(25.02)	44	FID25405-443K6K	2.100(53.34)	2.385(60.58)
18	FID25405-183K6K	.800(20.32)	1.085(27.56)	50	FID25405-503K6K	2.400(60.96)	2.685(68.20)
20	FID25405-203K6K	.900(22.86)	1.185(30.10)	60	FID25405-603K6K	2.900(73.66)	3.185(80.90)
24	FID25405-243K6K	1.100(27.94)	1.385(35.18)	64	FID25405-643K6K	3.100(78.74)	3.385(85.98)

<p>THIRD ANGLE PROJECTION</p>	GENERAL TOLERANCES (UNLESS SPECIFIED)		APPROVE BY	DATE	PART NO.	ITEM NO.	<p>Leader Of Industry</p>
	X.±.012(0.30)	X.±5'	FRANK	9/SEP/13	FID25405-XX3K6K	FID25405	
	X.X±.008(0.20)	.X'±2'	CHECKED BY	DATE	TITLE		
	X.XX±.006(0.15)	.XX'±1'	CHERRY	9/SEP/13	Wire to Board(IDC Connector) Pitch 2.54mm		
SCALE	SIZE	X.XXX±.004(0.10)	.XXX'±0.5'	DRAWN BY	DATE	THIS DRAWING CONTAINS INFORMATION THAT IS PROPRIETARY TO TXGA INDUSTRIAL ELECTRONICS(S.Z)CO.,LTD AND SHOULD NOT BE USED WITHOUT WRITTEN PERMISSION	
5:1	A4			JACOB	9/SEP/13	REV 1	SHEET NO. 1/1