

REV	LOCATIONS	DESCRIPTION	DATE	REVISER	APPD

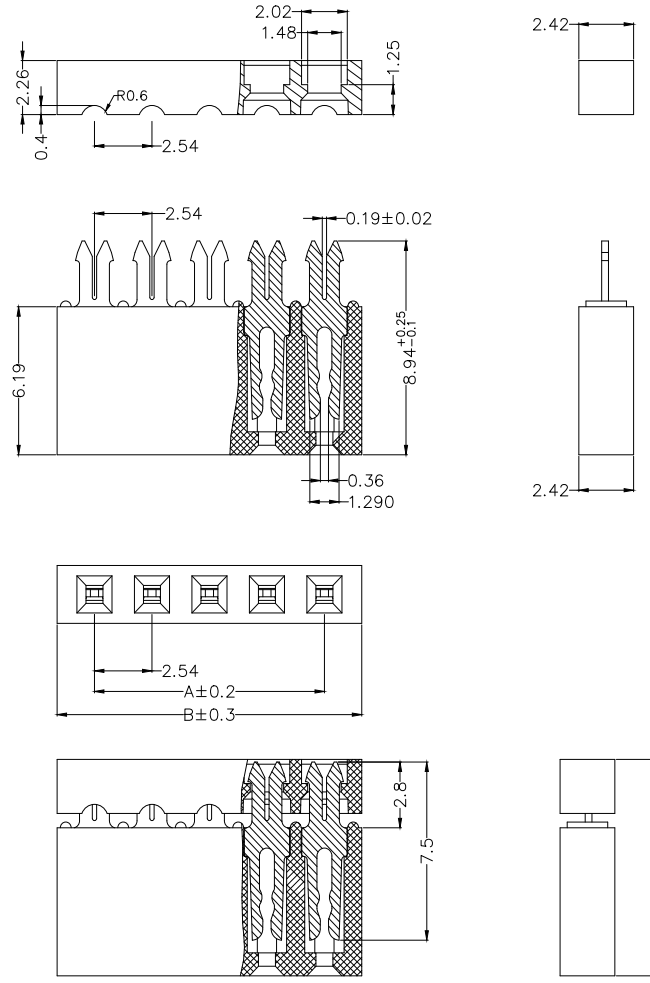

Circuits (n)	Part NO.	Dimensions	
		A	B
04	FID25412-045BKB	7.62	10.92
05	FID25412-055BKB	10.16	13.46
06	FID25412-065BKB	12.70	16.00
07	FID25412-075BKB	15.24	18.54
08	FID25412-085BKB	17.78	21.08
09	FID25412-095BKB	20.32	23.62
10	FID25412-105BKB	22.86	26.16
11	FID25412-115BKB	25.40	28.70
12	FID25412-125BKB	27.94	31.24
13	FID25412-135BKB	30.48	33.78
14	FID25412-145BKB	33.02	36.32
15	FID25412-155BKB	35.56	38.86
16	FID25412-165BKB	38.10	41.40
17	FID25412-175BKB	40.64	43.94
18	FID25412-185BKB	43.18	46.48
19	FID25412-195BKB	45.72	49.02
20	FID25412-205BKB	48.26	51.56
21	FID25412-215BKB	50.80	54.10
22	FID25412-225BKB	53.34	56.64
23	FID25412-235BKB	55.88	59.18
24	FID25412-245BKB	58.42	61.72

### Ordering Information

FID 254 12 - XX 5 BK B  
 1 2 3 4 5 6 7

1 Category FID-IDC 2 Series Number 254-Pitch2.54mm 3 Distinction No. 12 4 Circuits XX 5 Plating 5-Gold flash on contact area, nickel on tail 6 Color-Resin BK-Black 7 Packaging B-Bag

### SPECIFICATIONS

**Electrical**  
 Current Rating: 1A AC/DC  
 Voltage Rating: 250V AC/DC  
 Contact Resistance: 20mΩ MAX  
 Insulation Resistance: 1000 MΩ MIN  
 Withstanding Voltage: 500V AC/Minute  
 Temperature Range-Operating: -40°C~+105°C

**Material**  
 Housing: PBT (UL94V-0), Black  
 Terminal: Brass, Gold flash on contact area, nickel on tail

 THIRD ANGLE PROJECTION	GENERAL TOLERANCES (UNLESS SPECIFIED)		APPROVE BY LEO	DATE 22/Dec/21	PART NO. FID25412-XX5BKB	ITEM NO. FID25412	 Building Technology Cornerstone	
	X. ±0.30	X.* ±5'	CHECKED BY GISELLE	DATE 22/Dec/21	TITLE Wire to Board (IDC Connector) Pitch 2.54mm			REV 0
	DESIGN UNITS mm	X.X ±0.20	X.X* ±2'	DRAWN BY PYD	DATE 22/Dec/21	THIS DRAWING CONTAINS INFORMATION THAT IS PROPRIETARY TO TXGA INDUSTRIAL ELECTRONICS(S.Z)CO.,LTD AND SHOULD NOT BE USED WITHOUT WRITTEN PERMISSION		
	SCALE 5:1	SIZE A4	X.XXX ±0.10	X.XXX* ±0.5'				