

REV	LOCATIONS	DESCRIPTION	DATE	REVISER	APPD

Coded 8circuits

X-Coded

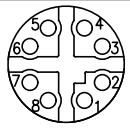

VIEW A

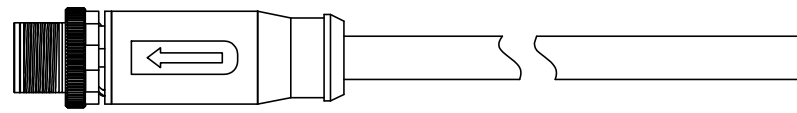

Note:  
 1. Waterproof rate: IP67  
 2. This product must meet IEC61076-2-109  
 3. This product must meet 2011/65/EU ROHS compliance.  
 4. Operation temperature: -20°C~85°C  
 5. Mechanical operation: > 100 mating cycles  
 6. Ethernet CAT6A, 10 Gbps  
 7. Flame retardant grade: VW-1  
 8. Drag chain cable  
 8.1. Drag chain radius: 50mm  
 8.2. Test life (drag chain test): ≥ 10 million times

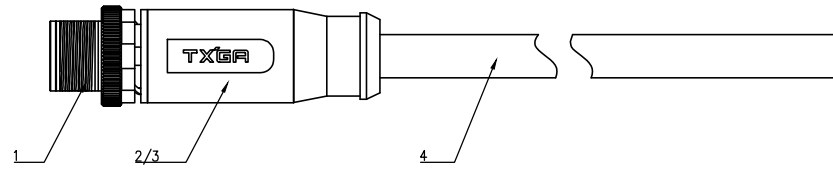
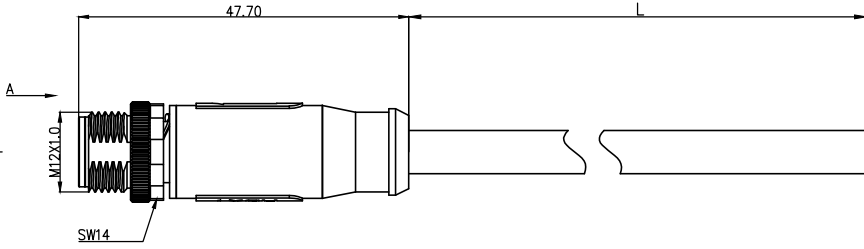
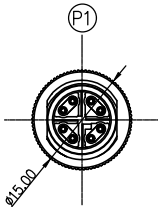
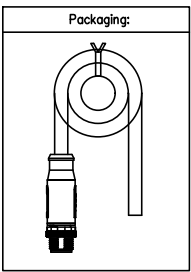
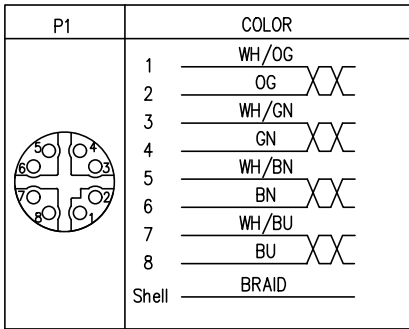

TABLE 1

L (XXXXX)	00050	00100	00150	00200	...	00990
50mm	100mm	150mm	200mm	...	990mm	
01000	01500	02000	10000	...	99900	
1M	1.5M	2M	10M	...	99.9M	
Dimensions L (mm)						
Range(length)	50 to 200	201 to 500	1001 to 5000	5000 to 9000		
Tolerance(mm)	±10	±15	±25	±30		
PACKING SPECIFICATION						
Range(length)	50 to 200	201 to 1000	1001 to 9000			
	5pcs/Bag	2pcs/Bag	1pcs/Bag			

WIRING CHART



Connector product information						Cable product Information	
Circuits	Rated Voltage	Rated impulse Voltage	Rated Current	Insulation resistance	Signal type classification	O.D	Wire Size(mm <sup>2</sup> ) AWG
8Circuits	60V	800V	0.5A	≥100MΩ	CAT6 <sub>A</sub>	6.8mm	0.14mm <sup>2</sup> /4Px26AWG
4	CAT6 <sub>A</sub> , UL2835 4Px26AWG, AB JACKET: BK, Drag chain cable						
3	Overmold: PVC black 30P						
2	Innermold: PVC black 30P						
1	M12-X encoded 8circuits shielded male plug						

Ordering Information

FM12D 03 08 09 - X 08 E XXXXX 00

1 Cable type FM12D-M12 Drag chain cable  
 2 Cable category 03-Male Straight to open  
 3 Mounting thread 08-M12X1.0  
 4 Distinction num 09

5 Coded X-X CODED  
 6 Circuits 08-8Circuits  
 7 Angle-Key E-0°  
 8 Cable length XXXXX-(see table1)

ELECTRICAL
1. Withstanding Voltage: DC 300V
2. Conduction Impedance: 3Ω (Max)
3. Insulation Resistance: 10MΩ (Min)

<p>THIRD ANGLE PROJECTION</p>	<p>GENERAL TOLERANCES (UNLESS SPECIFIED)</p>		<p>APPROVE BY</p> <p>LEO</p>	<p>DATE</p> <p>27/Apr/24</p>	<p>PART NO.</p> <p>FM12D030809-X08EXXXXX00</p>	<p>ITEM NO.</p> <p>FM12D030809</p>	<p>Building Technology Cornerstone</p>
	<p>DESIGN UNITS METRIC</p>	<p>X. ±0.30</p> <p>X.X ±0.20</p> <p>X.XX ±0.15</p> <p>X.XXX ±0.10</p>	<p>X.* ±5°</p> <p>X.X* ±2°</p> <p>X.XX* ±1°</p> <p>X.XXX* ±0.5°</p>	<p>CHECKED BY</p> <p>GISELLE</p>	<p>DATE</p> <p>27/Apr/24</p>	<p>TITLE</p> <p>M12 cable connector, male straight end, shielded, PVC, codes X, 8 circuits,</p>	
<p>SCALE 1:1</p>	<p>SIZE A4</p>	<p>DRAWN BY</p> <p>King</p>		<p>DATE</p> <p>27/Apr/24</p>	<p>THIS DRAWING CONTAINS INFORMATION THAT IS PROPRIETARY TO TXGA INDUSTRIAL ELECTRONICS(S.Z)CO.,LTD AND SHOULD NOT BE USED WITHOUT WRITTEN PERMISSION</p>		