

Note:
 1. Waterproof Rate: IP68
 2. This product must meet IEC61076-2-101
 3. This product must meet 2011/65/EU ROHS compliance.
 4. Not note tolerances: ±0.20
 5. Electronic wire UL 1569 PVC

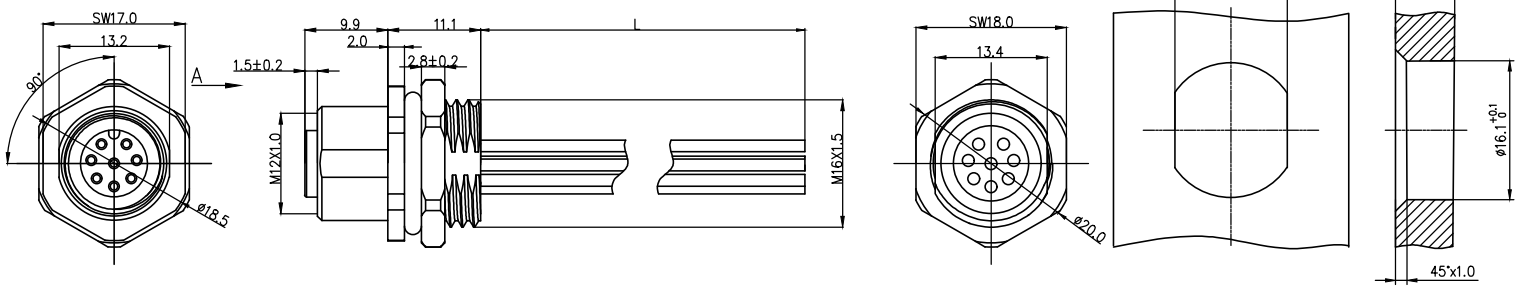

Recommended Panel Cut-Out

TABLE 1

L (XXXX)	0050	0100	0150	0200	...	0990
	50mm	100mm	150mm	200mm	...	990mm
	1000	1500	2000	3000	...	9999
	1M	1.5M	2M	3M	...	9.999M
Dimensions L (mm)						
Range(length)	50 to 200	201 to 500	1001 to 5000	5000 to 9000		
Tolerance(mm)	±10	±15	±25	±30		
PACKING SPECIFICATION						
Range(length)	50 to 200	201 to 1000	1001 to 5000			
	5pcs/Bag	2pcs/Bag	1pcs/Bag			

Ordering Information

FM12WR11 02 - X XX S 1 XX XXXX 00
 1 2 3 4 5 6 7 8 9

1 Category FM12W-M12 Wire	2 Mounting thread R11-Rear mounting M16X1.5	3 Distinction num. 02	4 Coded A-A CODED B-B CODED D-D CODED
5 Circuits 02-2Circuits 03-3Circuits ... 17-17Circuits	6 Contact S-socket	7 Contact plating 1-Gold plated	8 Contact plating thickness 01-0.025μm 03-0.075μm
			9 Cable length XXXX-(see table1)

6Circuits		7Circuits		8Circuits	
7	Blue	7	Blue	7	Blue
6	Pink	6	Pink	6	Pink
		5	Gray	5	Gray
4	Yellow	4	Yellow	4	Yellow
3	Green	3	Green	3	Green
2	Brown	2	Brown	2	Brown
1	White	1	White	1	White
Circuits	wire color	Circuits	wire color	Circuits	wire color

Circuits	Rated voltage	Rated impulse voltage	Rated current	Contact resistance	Insulation resistance	O.D	Wire size(mm ²) AWG
6Circuits	30V	800V	2A	≤5mΩ	≥100MΩ	1.4	0.25mm ² /24AWG
7Circuits	30V	800V	2A	≤5mΩ	≥100MΩ	1.4	0.25mm ² /24AWG
8Circuits	30V	800V	2A	≤5mΩ	≥100MΩ	1.4	0.25mm ² /24AWG

Installation category	single line
Degree of protection	IP68(in mated condition)
Mechanical operation	> 100 mating cycles
Upper temperature	105°C
Lower temperature	-40°C
Pollution degree	3
Overvoltage categorie	II
Material group	II
Material of contact	CuZn
Contact plating	Au
Material of contact body	PA66
Sealing	EPDM
Material of housing	alloy

ELECTRICAL
1. Withstanding Voltage: DC 300V
2. Conduction Impedance: 3Ω (Max)
3. Insulation Resistance: 10MΩ (Min)

THIRD ANGLE PROJECTION	GENERAL TOLERANCES (UNLESS SPECIFIED)		APPROVE BY LEO	DATE 27/Apr/24	PART NO. FM12WR1102-XXXS1XXXXXX00	ITEM NO. FM12WR1102	 Building Technology Cornerstone
	X. ±0.30	X.* ±5°	CHECKED BY GISELLE	DATE 27/Apr/24	TITLE M12 female socket, unshielded, with wire, 2~12 circuits, M16X1.5, rear lock, codes A/B/D, double flat position		
	X.X ±0.20	X.X* ±2°	DRAWN BY King	DATE 27/Apr/24	THIS DRAWING CONTAINS INFORMATION THAT IS PROPRIETARY TO TXGA INDUSTRIAL ELECTRONICS(S.Z)CO.,LTD AND SHOULD NOT BE USED WITHOUT WRITTEN PERMISSION		
SCALE 1:1	SIZE A4	X.XXX ±0.10	X.XXX* ±0.5°	REV 0 SHEET NO. 2/3			

1	2	3	4	5	6	7	8			
Coded	9circuits	10circuits	11circuits	12circuits	REV	LOCATIONS	DESCRIPTION	DATE	REVISER	APPD
A-Coded										
VIEW A										

Note:
 1. Waterproof Rate: IP68
 2. This product must meet IEC61076-2-101
 3. This product must meet 2011/65/EU ROHS compliance.
 5. Electronic wire UL 1569 PVC

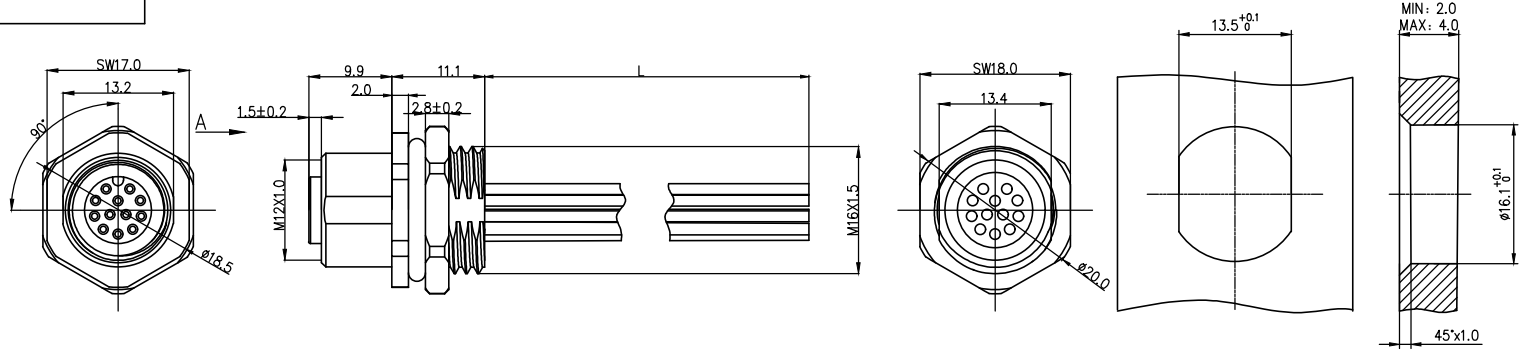

Recommended Panel Cut-Out

TABLE 1

L (XXXX)	0050	0100	0150	0200	...	0990
	50mm	100mm	150mm	200mm	...	990mm
	1000	1500	2000	3000	...	9999
	1M	1.5M	2M	3M	...	9.999M
Dimensions L (mm)						
Range(length)	50 to 200	201 to 500	1001 to 5000	5000 to 9000		
Tolerance(mm)	±10	±15	±25	±30		
PACKING SPECIFICATION						
Range(length)	50 to 200	201 to 1000	1001 to 5000			
	5pcs/Bag	2pcs/Bag	1pcs/Bag			

Circuits	Rated voltage	Rated impulse voltage	Rated current	Contact resistance	Insulation resistance	OD	Wire size(mm ²) AWG
9Circuits	30V	800V	1.5A	≤5mΩ	≥100MΩ	1.3	0.14mm ² /26AWG
10Circuits	30V	800V	1.5A	≤5mΩ	≥100MΩ	1.3	0.14mm ² /26AWG
11Circuits	30V	800V	1.5A	≤5mΩ	≥100MΩ	1.3	0.14mm ² /26AWG
12Circuits	30V	800V	1.5A	≤5mΩ	≥100MΩ	1.3	0.14mm ² /26AWG

Circuits	Rated voltage	Rated impulse voltage	Rated current	Contact resistance	Insulation resistance	OD	Wire size(mm ²) AWG
9Circuits	30V	800V	1.5A	≤5mΩ	≥100MΩ	1.3	0.14mm ² /26AWG
10Circuits	30V	800V	1.5A	≤5mΩ	≥100MΩ	1.3	0.14mm ² /26AWG
11Circuits	30V	800V	1.5A	≤5mΩ	≥100MΩ	1.3	0.14mm ² /26AWG
12Circuits	30V	800V	1.5A	≤5mΩ	≥100MΩ	1.3	0.14mm ² /26AWG

9Circuits	10Circuits	11Circuits	12Circuits	Installation category	single line
				Degree of protection	IP68(in mated condition)
				Mechanical operation	> 100 mating cycles
				Upper temperature	105°C
				Lower temperature	-40°C
				Pollution degree	3
				Overtoltage categorie	II
				Material group	II
				Material of contact	CuZn
				Contact plating	Au
				Material of contact body	PA66
				Sealing	EPDM
				Material of housing	alloy

Ordering Information

FM12WR11 02 - X XX S 1 XX XXXX 00
 1 2 3 4 5 6 7 8 9

1 Category FM12W-M12 Wire	2 Mounting thread R11-Rear mounting M16X1.5	3 Distinction num. 02	4 Coded A-A CODED B-B CODED D-D CODED
5 Circuits 02-2Circuits 03-3Circuits ... 17-17Circuits	6 Contact S-socket	7 Contact plating 1-Gold plated	8 Contact plating thickness 01-0.025μm 03-0.075μm
			9 Cable length XXXX-(see table)

ELECTRICAL
1. Withstanding Voltage: DC 300V
2. Conduction Impedance: 3Ω (Max)
3. Insulation Resistance: 10MΩ (Min)

 THIRD ANGLE PROJECTION DESIGN UNITS METRIC SCALE 1:1 SIZE A4	GENERAL TOLERANCES (UNLESS SPECIFIED)		APPROVE BY	DATE	PART NO.	ITEM NO.	 Building Technology Cornerstone REV 0 SHEET NO. 3/3
	X. ±0.30	X.* ±5°	LEO	27/Apr/24	FM12WR1102-XXXS1XXXXXX00	FM12WR1102	
	X.X ±0.20	X.XX' ±2°	CHECKED BY	DATE	TITLE		
	X.XX ±0.15	X.XX' ±1°	GISELLE	27/Apr/24	M12 female socket, unshielded, with wire, 2~12 circuits, M16X1.5, rear lock, codes A/B/D, double flat position		
X.XXX ±0.10	X.XXX' ±0.5°	DRAWN BY	DATE	THIS DRAWING CONTAINS INFORMATION THAT IS PROPRIETARY TO TXGA INDUSTRIAL ELECTRONICS(S.Z)CO.,LTD AND SHOULD NOT BE USED WITHOUT WRITTEN PERMISSION			
		King	27/Apr/24				