

REV	LOCATIONS	DESCRIPTION	DATE	REVISER	APPD

A
B
C
D
E
F

A
B
C
D
E
F

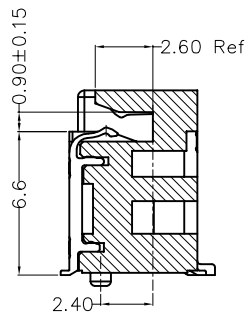
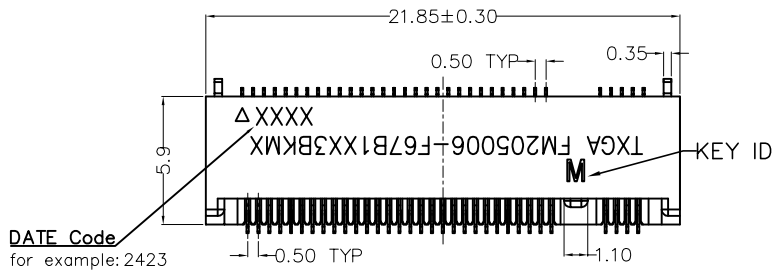

Section A-A

SPECIFICATIONS

Electrical
 Current Rating: 0.5A AC(rms)/DC
 Voltage Rating: 50V AC(rms)/DC
 Contact Resistance: 55mΩ Max
 Insulation Resistance: 500MΩ Min
 Withstanding Voltage: 300V AC r.m.s
 Temperature Range-Operating: -40°C ~ +80°C

Material

Housing: LCP (UL 94V-0) Black
 Contact: Copper Alloy/ Selected gold plated on contact area, gold flash plated on solder tails
 Pegs: Copper Alloy/ 100u" Min. Matte Tin Plated

*The pin NO. defintions are according to PCB footprint,the actual pin quantity is only 67 POS. For Key taking out 8 POS.

DATE Code
 for example: 2423
 24: 2024 Year
 23: the 23th Week

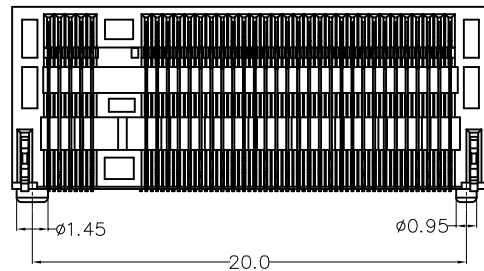
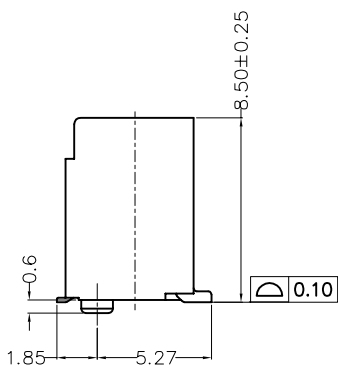
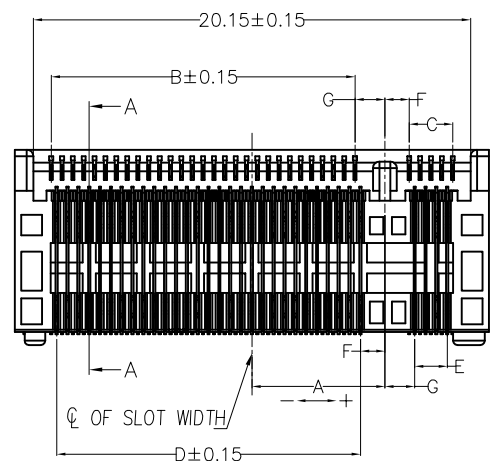

Ordering Information

FM2 050 06 - F 67 B 1 XX 3 BK M X
 1 2 3 4 5 6 7 8 9 10 11 12

1 Category FM2-M.2 Connector	2 Series Number 050-Pitch0.50mm	3 Distinction No. 06	4 Type F-Female	5 Circuits 67	6 Entry Angle B-90° Angle	7 Plating 1-Gold Plated
8 thickness of Gold Plating 00-Gold Flash 15-15u" 30-30u"	9 Material-Resin 3-LCP	10 Color-Resin BK-Black	11 Packaging M-Reel	12 Key ID A-A E-E M-M		

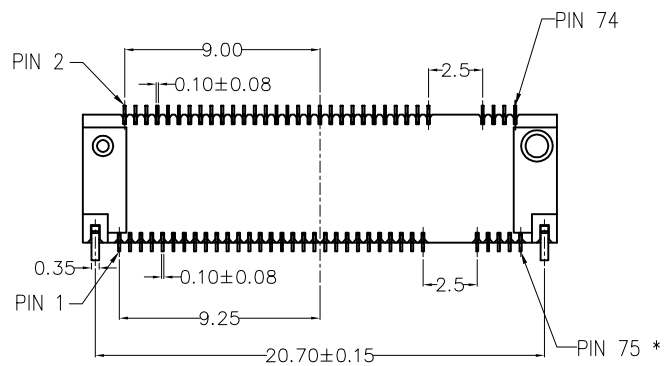

THIRD ANGLE PROJECTION	GENERAL TOLERANCES (UNLESS SPECIFIED)		APPROVE BY LEO	DATE 02/AUG/24	PART NO. FM205006-F67B1XX3BKMXX	ITEM NO. FM205006	 Building Technology Cornerstone	
	DESIGN UNITS METRIC	X. ±0.30	X.* ±5°	CHECKED BY GISELLE	DATE 02/AUG/24	TITLE M.2 Connector (H8.5mm) Pitch 0.5mm 90° Angle(Gen4)		REV 0
SCALE 5:1	SIZE A4	X.XX ±0.15	X.XX' ±1°	DRAWN BY MATT	DATE 02/AUG/24	THIS DRAWING CONTAINS INFORMATION THAT IS PROPRIETARY TO TXGA INDUSTRIAL ELECTRONICS(S.Z)CO.,LTD AND SHOULD NOT BE USED WITHOUT WRITTEN PERMISSION		

1 2 3 4 5 6 7 8

REV	LOCATIONS	DESCRIPTION	DATE	REVISER	APPD

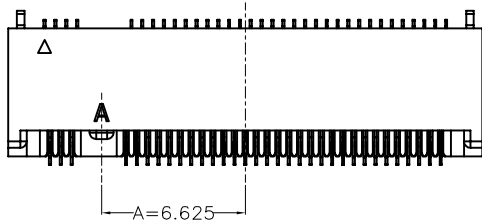

Part No.	Dimensions (mm)						
	A	B	C	D	E	F	G
FM205006-F67B1XX3BKMA	-6.625	1.5	14.5	1.0	14.5	1.375	1.125
FM205006-F67B1XX3BKME	-2.625	5.5	10.5	5.0	10.5	1.375	1.125
FM205006-F67B1XX3BKMM	6.125	14.0	2.0	14.0	1.5	1.125	1.375

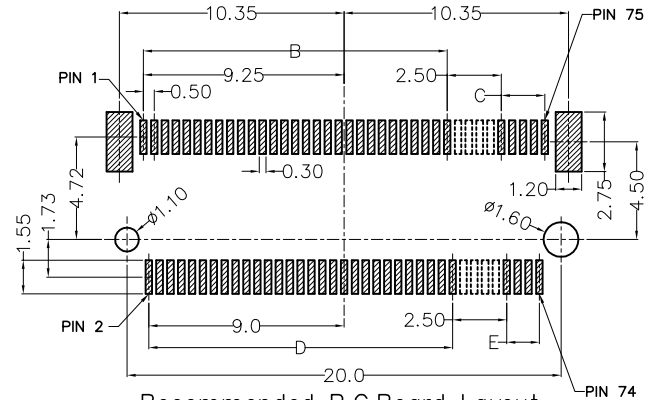
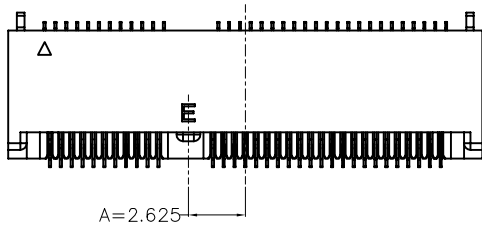

Recommended P.C. Board Layout
General tolerances: ±0.05mm

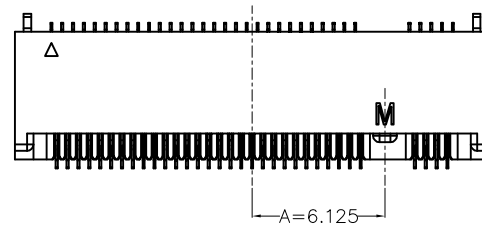

 THIRD ANGLE PROJECTION DESIGN UNITS METRIC SCALE 5:1 SIZE A4	GENERAL TOLERANCES (UNLESS SPECIFIED)		APPROVE BY LEO	DATE 02/AUG/24	PART NO. FM205006-F67B1XX3BKMX	ITEM NO. FM205006	 Building Technology Cornerstone
	X. ±0.30	X.* ±5°	CHECKED BY GISELLE	DATE 02/AUG/24	TITLE M.2 Connector (H8.5mm) Pitch 0.5mm 90° Angle(Gen4)		
	X.X ±0.20	X.X* ±2°	DRAWN BY MATT	DATE 02/AUG/24	THIS DRAWING CONTAINS INFORMATION THAT IS PROPRIETARY TO TXGA INDUSTRIAL ELECTRONICS(S.Z)CO.,LTD AND SHOULD NOT BE USED WITHOUT WRITTEN PERMISSION		
	X.XX ±0.15	X.XX* ±1°					
X.XXX ±0.10	X.XXX* ±0.5°						

1 2 3 4 5 6 7 8

REV	LOCATIONS	DESCRIPTION	DATE	REVISER	APPD

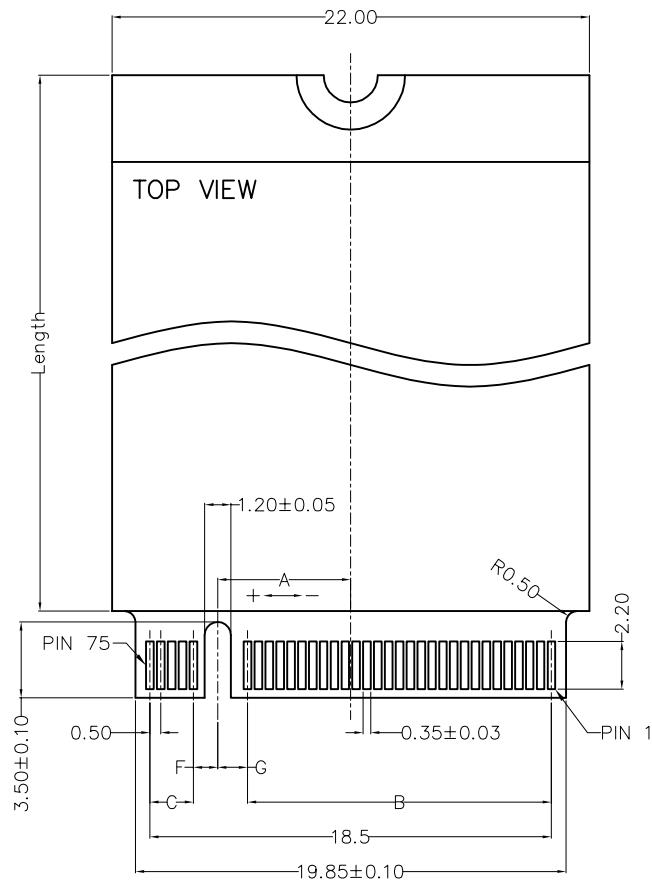

Recommended Card Size

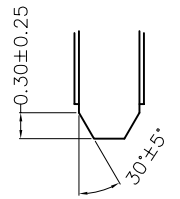
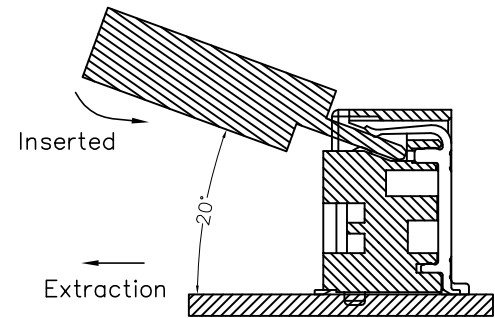
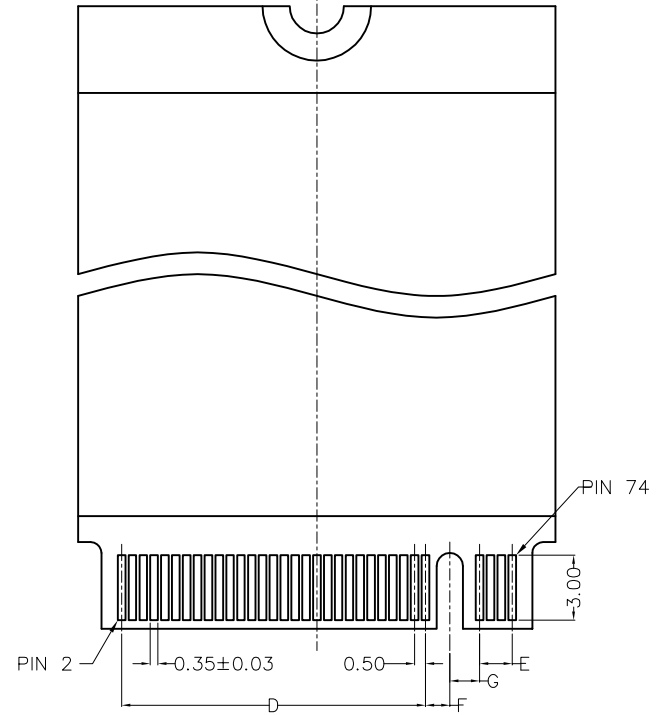
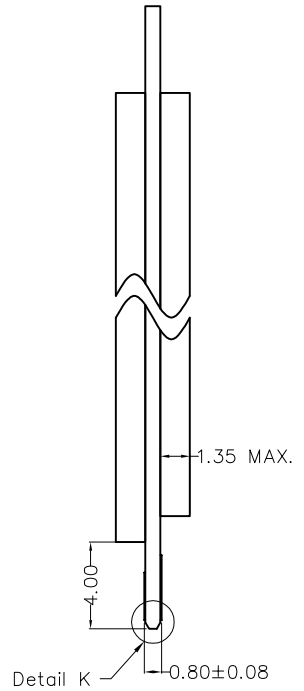

Detail K
Scale: 4:1

<p>THIRD ANGLE PROJECTION</p>	GENERAL TOLERANCES (UNLESS SPECIFIED)		APPROVE BY	DATE	PART NO.	ITEM NO.	<p>Building Technology Cornerstone</p>
	X. ±0.30	X.* ±5°	LEO	02/AUG/24	FM205006-F67B1XX3BKMx	FM205006	
	X.X ±0.20	X.X* ±2°	CHECKED BY	DATE	TITLE		
	X.XX ±0.15	X.XX* ±1°	GISELLE	02/AUG/24	M.2 Connector (H8.5mm) Pitch 0.5mm 90° Angle(Gen4)		
SCALE	SIZE	X.XXX ±0.10	X.XXX* ±0.5°	DRAWN BY	DATE	THIS DRAWING CONTAINS INFORMATION THAT IS PROPRIETARY TO TXGA INDUSTRIAL ELECTRONICS(S.Z)CO.,LTD AND SHOULD NOT BE USED WITHOUT WRITTEN PERMISSION	
5:1	A4			MATT	02/AUG/24	REV 0	SHEET NO. 3/3