

1	2	3	4	5	6	7	8				
Circuits	2Circuits	3Circuits	4Circuits	Circuits	5Circuits	REV	LOCATIONS	DESCRIPTION	DATE	REVISER	APPD
A-Coded				B-Coded		0		New Release	4/DEC	LAM	FRANK
FRONT VIEW A											

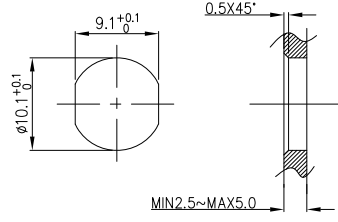

- Note:
- ① Important Dimension
 - Waterproof Rate: IP68
 - This product must meet IEC61076-2-104
 - This product must meet 2011/65/EU ROHS compliance.
 - Not note tolerances: ±0.20
 - Use torque values 1Nm

Recommended Panel Cut-Out

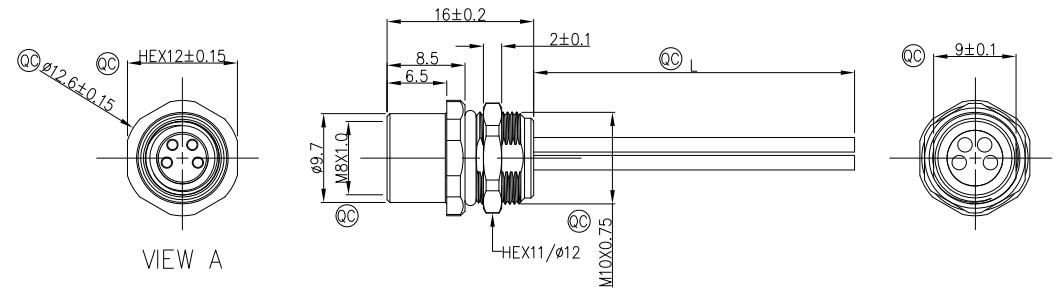

Ordering Information

FM8W R05 22 - X XX S 1 04 XXXX 00
 1 2 3 4 5 6 7 8 9

1 Series Name FM8W-M8 Wire	2 Mounting thread R05-rear fastened M10X0.75	3 Distinction No. 22	4 Coded A-A CODED B-B CODED	5 Circuits 02-2Circuits 03-3Circuits 04-4Circuits 05-5Circuits 06-6Circuits 07-7Circuits 08-8Circuits
6 Contact S- Socket	7 Plating 1-Ep Au	8 Thickness Plating 04-0.1μm	9 Length XXXX-(see table1)	

TABLE 1

CABLE LENGTH (XXX)	0050	0100	0150	0200	0990
	50mm	100mm	150mm	200mm	990mm
	1000	1500	2000	3000	9999
	1M	1.5M	2M	3M	9.999M

Dimensions L (mm)				
Range(length)	50 to 200	201 to 1000	1001 to 5000	5000 to 9999
Tolerance(mm)	±10	±15	±25	±30

3	4	4	5				
blue	black	black	grey				
3	3	4	4				
blue	blue	black	black				
1	1	2	2				
brown	brown	white	white				
1	1	1	1				
brown	brown	brown	brown				
Circuits	Color	Circuits	Color	Circuits	Color	Circuits	Color
Circuits	Rated Voltage	Rated impulse Voltage	Rated Currnt (40°C)	Contact resistance	Insulation resistance	Wire Size(mm ²)/AWG	
2Circuits	60V DC	1500V	4A	≤5mΩ	≥100MΩ	0.35mm ² /22AWG	
3Circuits	60V DC	1500V	4A	≤5mΩ	≥100MΩ	0.35mm ² /22AWG	
4Circuits	60V DC	1500V	4A	≤5mΩ	≥100MΩ	0.35mm ² /22AWG	
5Circuits	60V DC	1500V	4A	≤5mΩ	≥100MΩ	0.35mm ² /22AWG	

Connector locking system	Screw
Wiring type	Crimp
Degree of protection	IP68(in mated condition)
Mechanical operation	> 100 mating cycles
Upper temperature	105°C
Lower temperature	-40°C
Pollution degree	3
Overvoltage categorie	II
Material group	II
Material of contact	CuZn (Messing/brass)
Contact plating	Au
Material of contact body	PA
Sealing	EPDM
Material of housing	Brass nickel plated

 THIRD ANGLE PROJECTION DESIGN UNITS Metric SCALE 2:1 SIZE A4	GENERAL TOLERANCES (UNLESS SPECIFIED)		APPROVE BY	DATE	PART NO.	ITEM NO.	 Building Technology Cornerstone REV 0 SHEET NO. 1/2 THIS DRAWING CONTAINS INFORMATION THAT IS PROPRIETARY TO TXGA INDUSTRIAL ELECTRONICS(S,Z)CO.,LTD AND SHOULD NOT BE USED WITHOUT WRITTEN PERMISSION
	X.±0.30	X.±5'	FRANK	4/DEC/23	FM8WR0522-XXXS104XXXX00	FM8SR0522	
	X.X±0.20	.X'±2'	CHECKED BY	DATE	TITLE		
	X.XX±0.15	.XX'±1'	CERRY	4/DEC/23	M8X1.0 female socket rear fastened M10X0.75 Crimp terminal 【double section】 To Lite open end		
X.XXX±0.10	.XXX'±0.5'	DRAWN BY	DATE				
LAM	4/DEC/23						

1	2	3	4	5	6	7	8			
Circuits	6Circuits	7Circuits	8Circuits		REV	LOCATIONS	DESCRIPTION	DATE	REVISER	APPD
A-Coded					0		New Release	4/DEC	LAM	FRANK

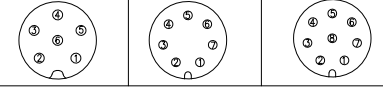

FRONT VIEW A

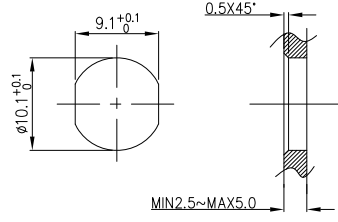

- Note:
- ① Important Dimension
 - Waterproof Rate: IP68
 - This product must meet IEC61076-2-104
 - This product must meet 2011/65/EU ROHS compliance.
 - Not note tolerances: ±0.20
 - Use torque values 1Nm

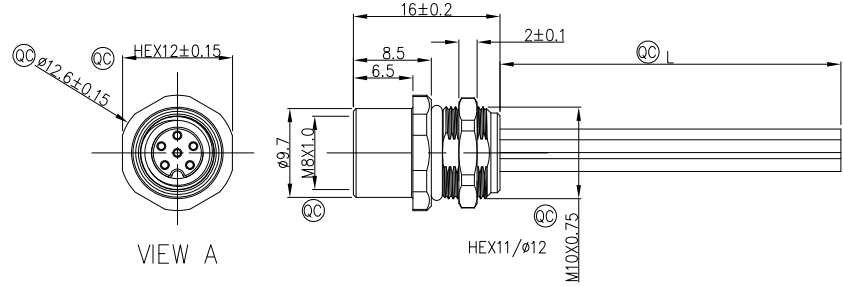

VIEW A

Ordering Information

FM8W R05 22 - X XX S 1 04 XXXX 00
 1 2 3 4 5 6 7 8 9

1 Series Name FM8W-M8 Wire	2 Mounting thread R05-rear fastened M10X0.75	3 Distinction No. 22	4 Coded A-A CODED B-B CODED	5 Circuits 02-2Circuits 03-3Circuits 04-4Circuits 05-5Circuits 06-6Circuits 07-7Circuits 08-8Circuits
6 Contact S- Socket	7 Plating 1-Ep Au	8 Thickness Plating 04-0.1μm	9 Length XXXX-(see table1)	

TABLE 1

CABLE LENGTH (XXX)	0050	0100	0150	0200	0990
	50mm	100mm	150mm	200mm	990mm
	1000	1500	2000	3000	9999
	1M	1.5M	2M	3M	9.999M

Dimensions L (mm)				
Range(length)	50 to 200	201 to 1000	1001 to 5000	5000 to 9999
Tolerance(mm)	±10	±15	±25	±30

Circuits	Color	Circuits	Color	Circuits	Color	Connector locking system	Screw
6	purple	7	blue	8	red	Connector locking system	Screw
5	grey	6	pink	7	blue	Wiring type	Crimp
4	black	5	grey	6	pink	Degree of protection	IP68(in mated condition)
3	blue	4	yellow	5	grey	Mechanical operation	> 100 mating cycles
2	white	3	green	4	yellow	Upper temperature	105°C
1	brown	2	brown	3	green	Lower temperature	-40°C
		1	white			Pollution degree	3
						Overvoltage categorie	II
						Material group	II
						Material of contact	CuZn (Messing/brass)
						Contact plating	Au
						Material of contact body	PA
						Sealing	EPDM
						Material of housing	Brass nickel plated

<p>THIRD ANGLE PROJECTION</p>	GENERAL TOLERANCES (UNLESS SPECIFIED)		APPROVE BY	DATE	PART NO.	ITEM NO.	<p>Building Technology Cornerstone</p>	
	X.±0.30	.X'±5'	FRANK	4/DEC/23	FM8WR0522-XXXS104XXX00	FM8SR0522		
	DESIGN UNITS Metric	X.X±0.20	.X'±2'	CHECKED BY	DATE	TITLE		
	X.XX±0.15	.XX'±1'	CERRY	4/DEC/23	M8X1.0 female socket rear fastened M10X0.75 Crimp terminal [double section] To Lite open end			
SCALE 2:1	SIZE A4	X.XXX±0.10	.XXX'±0.5'	DRAWN BY LAM	DATE 4/DEC/23	THIS DRAWING CONTAINS INFORMATION THAT IS PROPRIETARY TO TXGA INDUSTRIAL ELECTRONICS(S,Z)CO.,LTD AND SHOULD NOT BE USED WITHOUT WRITTEN PERMISSION		

REV 0 SHEET NO. 2/2