

1	2	3	4	5	6	7	8				
Circuits	2Circuits	3Circuits	4Circuits	Circuits	5Circuits	REV	LOCATIONS	DESCRIPTION	DATE	REVISER	APPD
A-Coded				B-Coded		0		New Release	4/DEC	LAM	FRANK
FRONT VIEW A											

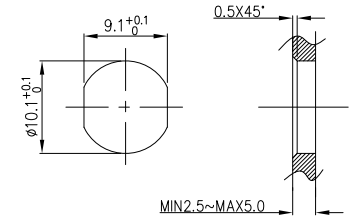

Note:
 1. Ⓞ Important Dimension
 2. Waterproof Rate: IP68
 3. This product must meet IEC61076-2-104
 4. This product must meet 2011/65/EU ROHS compliance.
 5. Not note tolerances: ±0.20
 6. Use torque values 1Nm

Recommended Panel Cut-Out

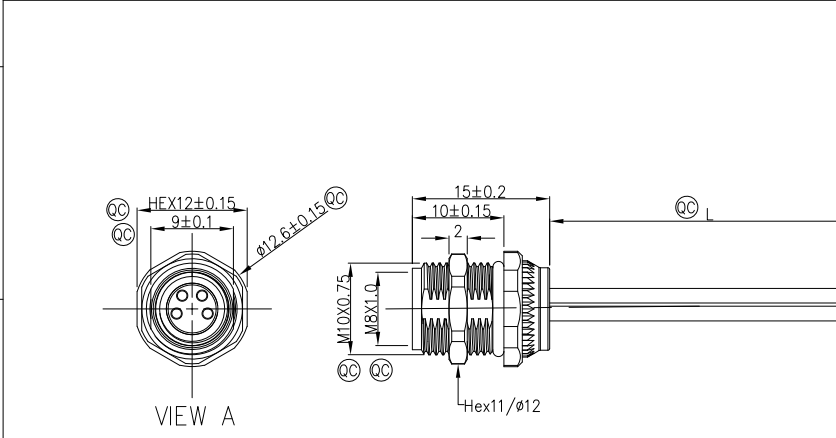
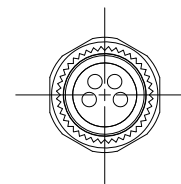

Ordering Information

FM8W WT05 18 - X XX S 1 04 XXXX 00
 1 2 3 4 5 6 7 8 9

1 Series Name FM8W-M8 Wire	2 Mounting thread WT05-Front fastened M10X0.75	3 Distinction No. 18	4 Coded A-A CODED B-B CODED	5 Circuits 02-2Circuits 03-3Circuits 04-4Circuits 05-5Circuits 06-6Circuits 07-7Circuits 08-8Circuits
6 Contact S- Socket	7 Plating 1- Ep Au	8 Thickness Plating 04-0.1µm	9 Length XXXX-(see table1)	

TABLE 1

CABLE LENGTH (XXX)	0050	0100	0150	0200	0990
	50mm	100mm	150mm	200mm	990mm
	1000	1500	2000	3000	9999
	1M	1.5M	2M	3M	9.999M

Dimensions L (mm)				
Range(length)	50 to 200	201 to 1000	1001 to 5000	5000 to 9999
Tolerance(mm)	±10	±15	±25	±30

				5	grey		
	4	black	4	black	4	black	
3	blue	3	blue	3	blue	3	blue
				2	white	2	white
1	brown	1	brown	1	brown	1	brown
Circuits	Color	Circuits	Color	Circuits	Color	Circuits	Color
Circuits	Rated Voltage	Rated impulse Voltage	Rated Currnt (40°C)	Contact resistance	Insulation resistance	Wire Size(mm²)/AWG	
2Circuits	60V DC	1500V	4A	≤5mΩ	≥100MΩ	0.35mm²/22AWG	
3Circuits	60V DC	1500V	4A	≤5mΩ	≥100MΩ	0.35mm²/22AWG	
4Circuits	60V DC	1500V	4A	≤5mΩ	≥100MΩ	0.35mm²/22AWG	
5Circuits	60V DC	1500V	4A	≤5mΩ	≥100MΩ	0.35mm²/22AWG	

Connector locking system	Screw
Wiring type	Crimp
Degree of protection	IP68(in mated condition)
Mechanical operation	> 100 mating cycles
Upper temperature	105°C
Lower temperature	-40°C
Pollution degree	3
Overvoltage categorie	II
Material group	II
Material of contact	CuZn (Messing/brass)
Contact plating	Au
Material of contact body	PA
Sealing	EPDM
Material of housing	Brass nickel plated

 THIRD ANGLE PROJECTION DESIGN UNITS Metric SCALE 2:1 SIZE A4	GENERAL TOLERANCES (UNLESS SPECIFIED)		APPROVE BY FRANK	DATE 4/DEC/23	PART NO. FM8WT0518-XXXX104XXXX00	ITEM NO. FM8WT0518	 Building Technology Cornerstone REV 0 SHEET NO. 1/2
	X.±0.30	X.±5°	CHECKED BY CHERRY	DATE 4/DEC/23	TITLE M8X1.0 female socket front fastened M10X0.75 Crimp terminal【double section】		
	X.X±0.20	.X±2°	DRAWN BY LAM	DATE 4/DEC/23	THIS DRAWING CONTAINS INFORMATION THAT IS PROPRIETARY TO TXGA INDUSTRIAL ELECTRONICS(S,Z)CO.,LTD AND SHOULD NOT BE USED WITHOUT WRITTEN PERMISSION		
	X.XX±0.15	.XX±1°					
X.XXX±0.10	.XXX±0.5°						

1	2	3	4	5	6	7	8			
Circuits	6Circuits	7Circuits	8Circuits		REV	LOCATIONS	DESCRIPTION	DATE	REVISER	APPD
A-Coded					0		New Release	4/DEC	LAM	FRANK

FRONT VIEW A

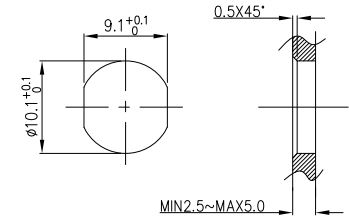
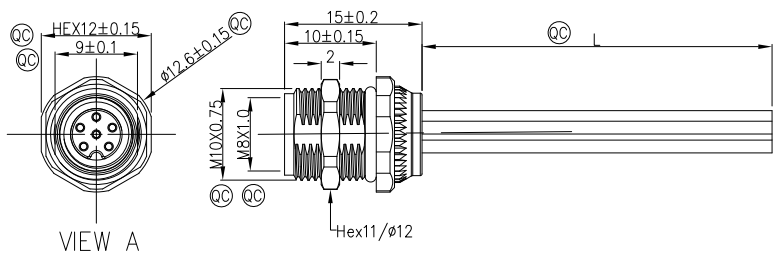

Recommended Panel Cut-Out

- Note:
- ① Important Dimension
 - Waterproof Rate: IP68
 - This product must meet IEC61076-2-104
 - This product must meet 2011/65/EU ROHS compliance.
 - Not note tolerances: ±0.20
 - Use torque values 1Nm

Ordering Information

FM8W WT05 18 - X XX S 1 04 XXXX 00
 1 2 3 4 5 6 7 8 9

1 Series Name FM8W-M8 Wire	2 Mounting thread WT05-Front fastened M10X0.75	3 Distinction No. 18	4 Coded A-A CODED B-B CODED	5 Circuits 02-2Circuits 03-3Circuits 04-4Circuits 05-5Circuits 06-6Circuits 07-7Circuits 08-8Circuits
6 Contact S- Socket	7 Plating 1- Ep Au	8 Thickness Plating 04-0.1µm	9 Length XXXX-(see table1)	

TABLE 1

CABLE LENGTH (XXX)	0050	0100	0150	0200	0990
	50mm	100mm	150mm	200mm	990mm
	1000	1500	2000	3000	9999
	1M	1.5M	2M	3M	9.999M

Dimensions L (mm)				
Range(length)	50 to 200	201 to 1000	1001 to 5000	5000 to 9999
Tolerance(mm)	±10	±15	±25	±30

6	7	8	red	Connector locking system	Screw				
6	7	7	blue	Wiring type	Crimp				
6	6	6	pink	Degree of protection	IP68(in mated condition)				
5	5	5	grey	Mechanical operation	> 100 mating cycles				
4	4	4	yellow	Upper temperature	105°C				
3	3	3	green	Lower temperature	-40°C				
2	2	2	brown	Pollution degree	3				
1	1	1	white	Overvoltage categorie	II				
Circuits	Color	Circuits	Color	Circuits	Color				
Circuits	Rated Voltage	Rated impulse Voltage	Rated Current (40°C)	Contact resistance	Insulation resistance	Wire Size(mm²)/AWG	Material group	II	
6Circuits	30V DC	800V	1.5A	≤5mΩ	≥100MΩ	0.25mm²/24AWG	Material of contact	CuZn (Messing/brass)	
7Circuits	30V DC	800V	1.5A	≤5mΩ	≥100MΩ	0.14mm²/26AWG	Contact plating	Au	
8Circuits	30V DC	800V	1.5A	≤5mΩ	≥100MΩ	0.14mm²/26AWG	Material of contact body	PA	
							Sealing	EPDM	
							Material of housing	Brass nickel plated	

 THIRD ANGLE PROJECTION DESIGN UNITS Metric SCALE 2:1 SIZE A4	GENERAL TOLERANCES (UNLESS SPECIFIED)		APPROVE BY FRANK	DATE 4/DEC/23	PART NO. FM8WT0518-XXS104XXXX00	ITEM NO. FM8WT0518	 Building Technology Cornerstone
	X.±0.30	.X'±5'	CHECKED BY CHERRY	DATE 4/DEC/23	TITLE M8X1.0 female socket front fastened M10X0.75 Crimp terminal【double section】		
	X.XX±0.20	.XX±2'	DRAWN BY LAM	DATE 4/DEC/23	THIS DRAWING CONTAINS INFORMATION THAT IS PROPRIETARY TO TXGA INDUSTRIAL ELECTRONICS(S,Z)CO.,LTD AND SHOULD NOT BE USED WITHOUT WRITTEN PERMISSION		
	X.XX±0.15	.XX±1'					
X.XXX±0.10	.XXX±0.5'						