

REV	LOCATIONS	DESCRIPTION	DATE	REVISER	APPD

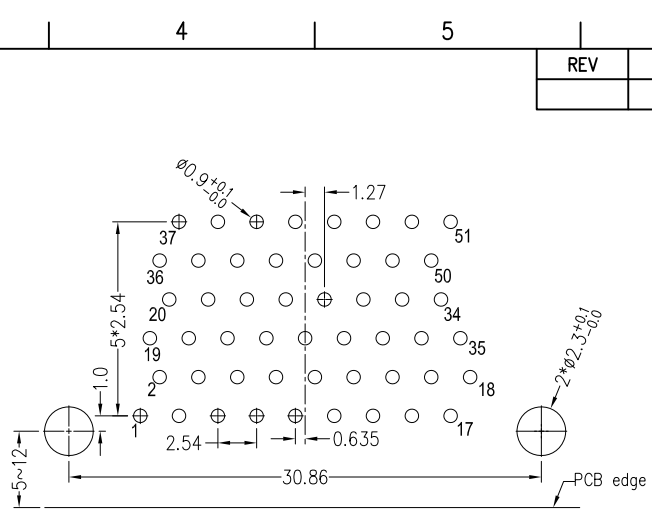
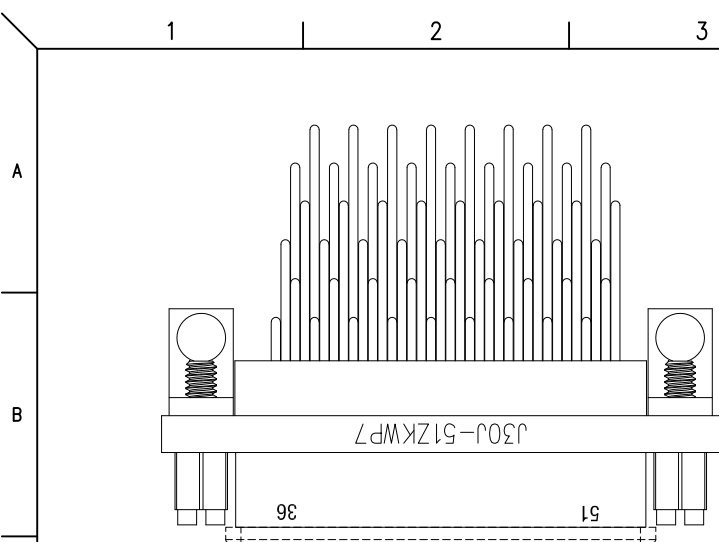

Recommended P.C.Board Layout  
General tolerances:  $\pm 0.05$

**SPECIFICATIONS**

**Electrical**

- Current Rating: 3.0A AC(rms)/DC
- Voltage Rating: 500V AC(rms)/DC
- Contact Resistance: 20 mΩ Max
- Insulation Resistance: 5000 MΩ MIN
- Withstanding Voltage: 800V AC r.m.s
- Temperature Range-Operating:  $-55^{\circ}\text{C} \sim +125^{\circ}\text{C}$

**Mechanical**

- Durability: 500 Cycles
- Vibration: Frequency 10~2000Hz, Acceleration  $196\text{m/s}^2$ ,
- Shock: Peak Acceleration  $735\text{m/s}^2$  11ms.

**Material and Plating**

- Housing: High-temperature plastic Natural(UL94V-0)
- Contact Pin: Copper Alloy/Gold Plated
- Shell: Aluminium alloy/Nickel Plated
- Seal Pad: Silicone Rubber RED
- Nut: Stainless steel

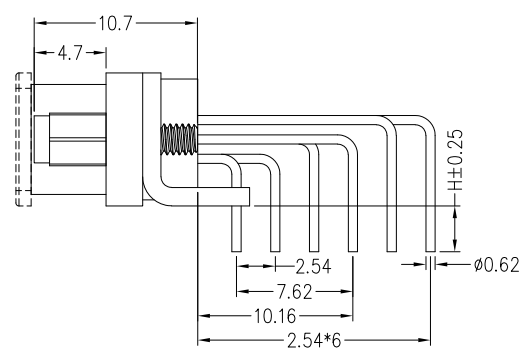
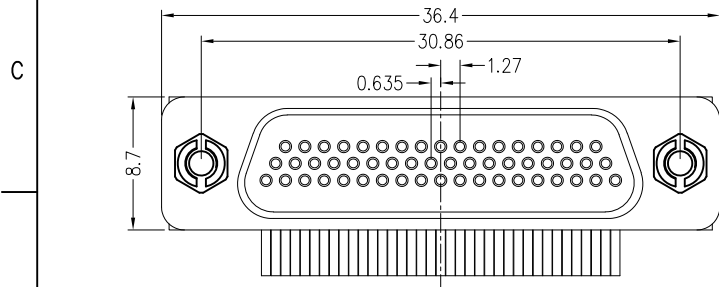

**Ordering Information**

FMD0 05 — F 051 B D XX — 0 X  
1 2 3 4 5 6 7 8 9

1	Category FMD0-Micro-D Connector	2	Distinction No. 05	3	Gender F-Female	4	Circuits 51	5	Entry Angle B-90° Angle
6	Assembly Layout D-DIP	7	Color-Resin NA-Natural	8	Type 0-Standard	9	H 0-H=3		

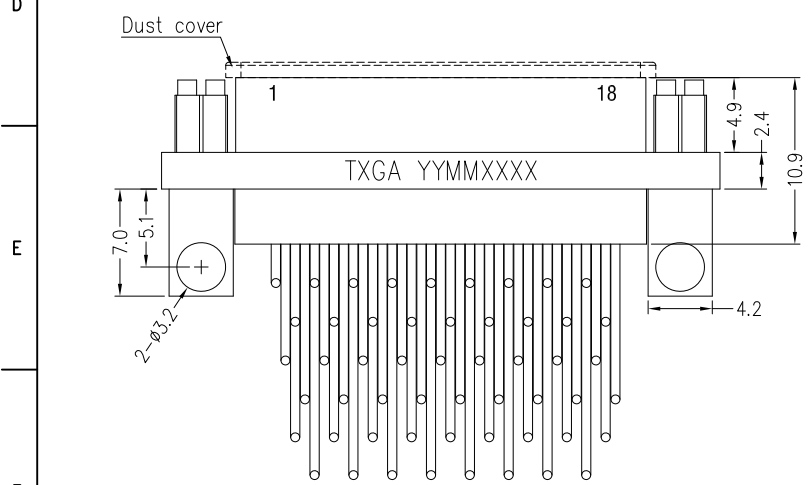

<p>THIRD ANGLE PROJECTION</p>	GENERAL TOLERANCES (UNLESS SPECIFIED)		APPROVE BY LEO	DATE 08/MAY/25	PART NO. FMD005-F051BDXX-XX	ITEM NO. FMD005	<p>Building Technology Cornerstone</p>
	X.X $\pm 0.30$	X.X' $\pm 5'$	CHECKED BY GISELLE	DATE 08/MAY/25	TITLE Micro-D Connector Pitch 1.27mm Female(DIP)		
	X.XX $\pm 0.20$	X.XX' $\pm 2'$	DRAWN BY HUANG	DATE 08/MAY/25	THIS DRAWING CONTAINS INFORMATION THAT IS PROPRIETARY TO TXGA INDUSTRIAL ELECTRONICS(S.Z)CO.,LTD AND SHOULD NOT BE USED WITHOUT WRITTEN PERMISSION		SHEET NO. 1/1
	X.XXX $\pm 0.15$	X.XXX' $\pm 1'$					
SCALE NTS	SIZE A4	X.XXX $\pm 0.10$	X.XXX' $\pm 0.5'$				