

REV	LOCATIONS	DESCRIPTION	DATE	REVISER	APPD
0		New Release	4/JUNE	LAM	FRANK

Material
connector parts material Plating
inner contact bronze Gold
outer contact brass Sn
housing LCP
Flame proofing
Component category
overmold material conforms to UL94V-0
housing material conforms to UL94V-0
RoHS compliant
Standards
According to the standard IEC 61076-3-122

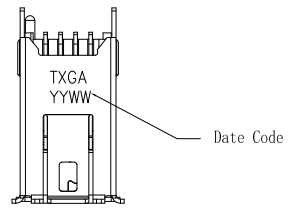
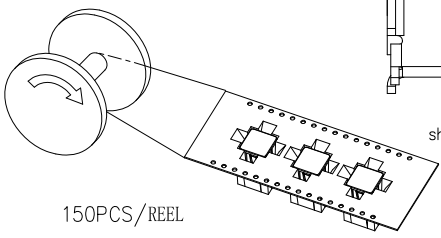
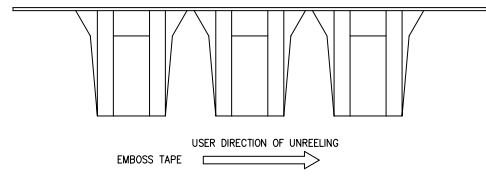
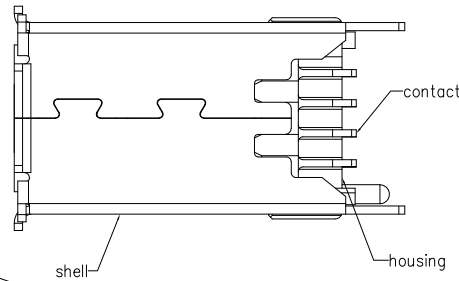
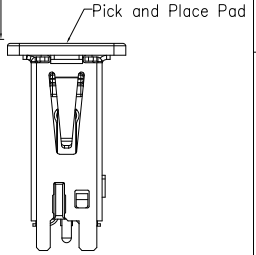
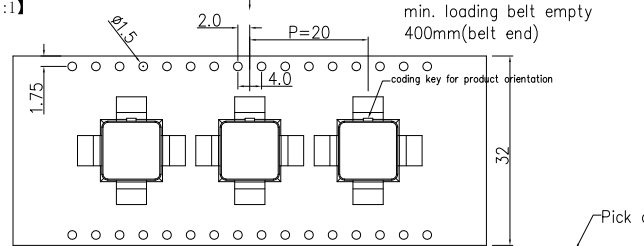
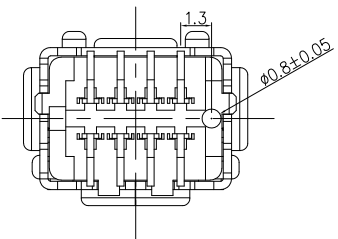
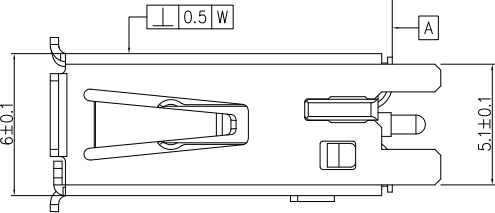
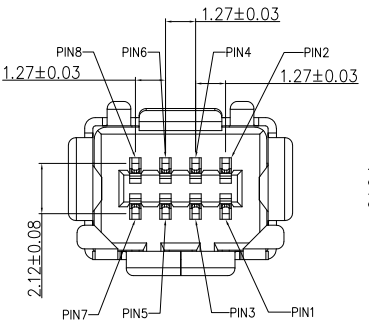
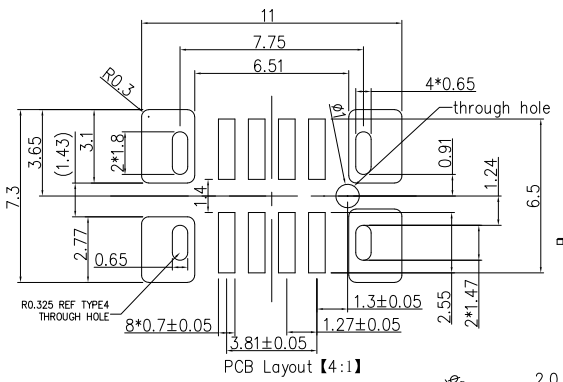
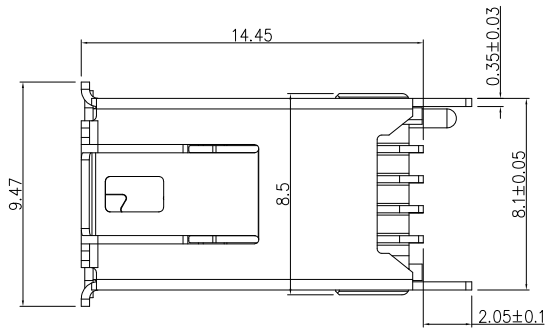

Ordering Information

FMNTU01	-	F	XX	S	S	7	16	Y	M	00	
1	Series Name	2	Gender	3	Circuits	4	Orientation	5	Mounting Style	6	Contact plating
	FMNTU01		F-Female		08-8Circuits		S-Vertical(180°)		S-SMT		7-Gold on contact,matte tin on tail
7	Contact plating thickness	8	Peg	9	Packaging						
	16-0.5µm		Y-With peg		M-Reel						

 THIRD ANGLE PROJECTION DESIGN UNITS Metric SCALE 4:1 SIZE A4	GENERAL TOLERANCES (UNLESS SPECIFIED)		DATE	APPROVE BY	PART NO.	ITEM NO.	 Building Technology Cornerstone REV 0 SHEET NO. 1/1
	X.±0.30	.X'±5'	FRANK	4/JUNE/24	FMNTU01-F08SS716YM00	FMNTU01	
	X.X±0.20	.X'±2'	CHECKED BY	DATE	TITLE		
	X.XX±0.15	.XX'±1'	CHERRY	4/JUNE/24	MINI 1/0 U Shape Socket Straight SMT		
X.XXX±0.10	.XXX'±0.5'	DRAWN BY	DATE	THIS DRAWING CONTAINS INFORMATION THAT IS PROPRIETARY TO TXGA INDUSTRIAL ELECTRONICS(S,Z)CO.,LTD AND SHOULD NOT BE USED WITHOUT WRITTEN PERMISSION			
LAM			4/JUNE/24				