

| REV | LOCATIONS | DESCRIPTION | DATE | REVISER | APPD |
|-----|-----------|-------------|------|---------|------|
| | | | | | |
| | | | | | |

SPECIFICATIONS

Electrical
 Current Rating: 50A Max AC(rms)/DC
 Screw Torque: 7 lbf.in
 Operating Temperature: -40°C~+120°C
 Material And Plating
 Brass/Tin Plated

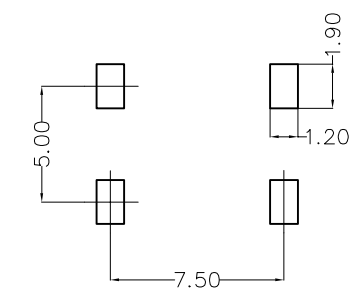
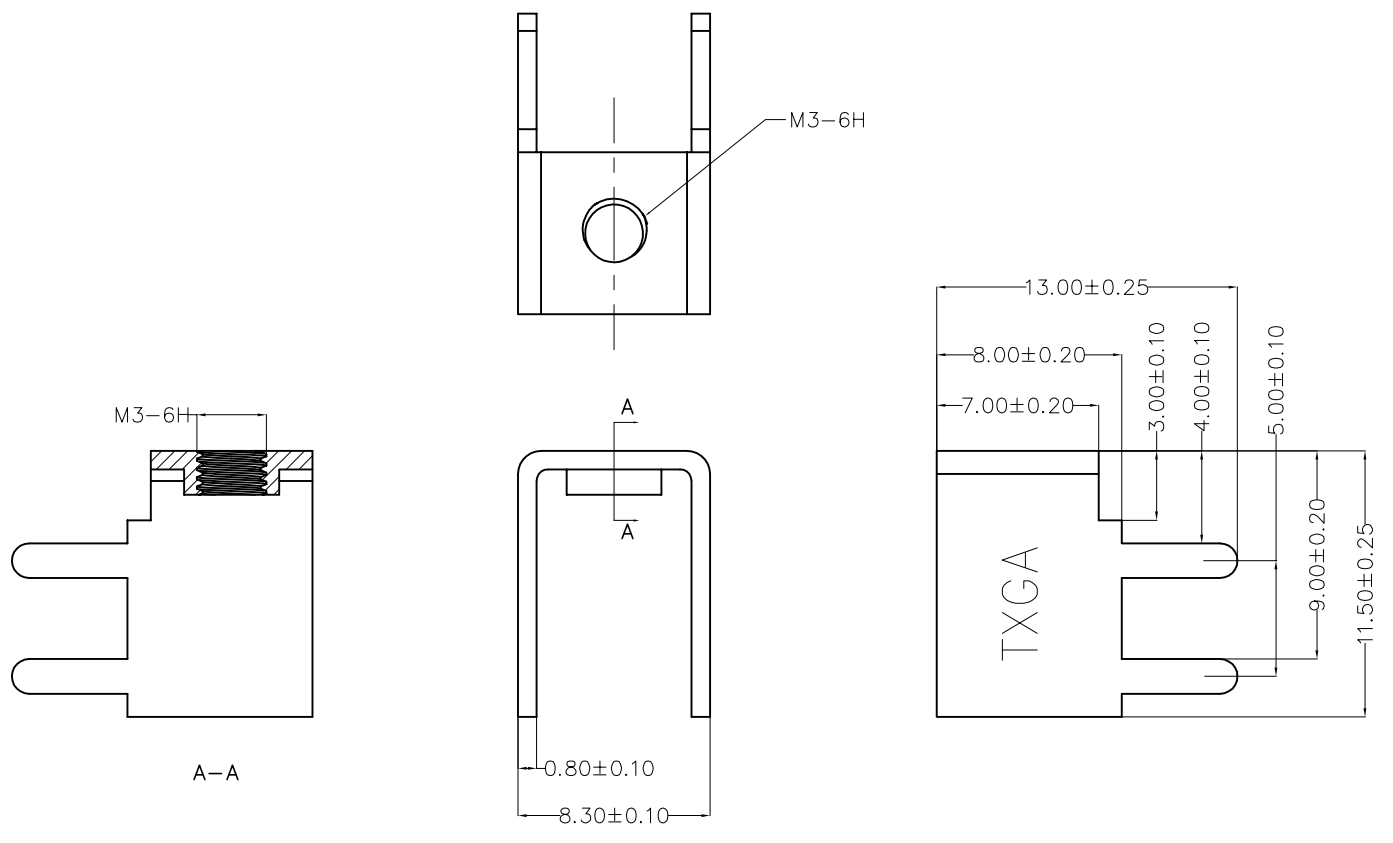

Recommended P.C.Board Layout

| | | | | | | | |
|-------------------------------|--|-------------|-----------------------|-------------------|--|--------------------|-------------------------------------|
| THIRD ANGLE PROJECTION | GENERAL TOLERANCES (UNLESS SPECIFIED) | | APPROVE BY LEO | DATE 30/JAN/23 | PART NO. FNT011-M030B | ITEM NO. FNT011 | Building Technology Cornerstone |
| | X. ±0.30 | X.* ±5° | CHECKED BY GISELLE | DATE 30/JAN/23 | TITLE Nut-type Terminal (M3) | | |
| DESIGN UNITS METRIC | X.X ±0.20 | X.X* ±2° | DRAWN BY YYQ | DATE 30/JAN/23 | THIS DRAWING CONTAINS INFORMATION THAT IS PROPRIETARY TO TXGA INDUSTRIAL ELECTRONICS(S.Z)CO.,LTD AND SHOULD NOT BE USED WITHOUT WRITTEN PERMISSION | | REV 0 |
| SCALE 5:1 | SIZE A4 | X.XX ±0.15 | X.XX* ±1° | | | | SHEET NO. 1/1 |
| | | X.XXX ±0.10 | X.XXX* ±0.5° | | | | |