

REV	LOCATIONS	DESCRIPTION	DATE	REVISER	APPD

SPECIFICATIONS

Electrical
 Current Rating: 60A Max AC(rms)/DC
 Screw Torque: 13 lbf.in
 Operating Temperature: -40°C~+120°C
 Material And Plating
 Feet: Brass/Tin Plated
 Shim: stainless steel/Tin Plated

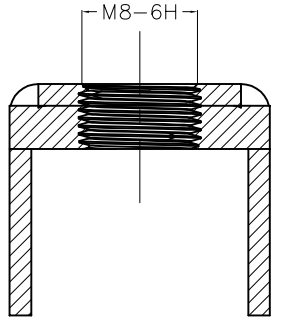
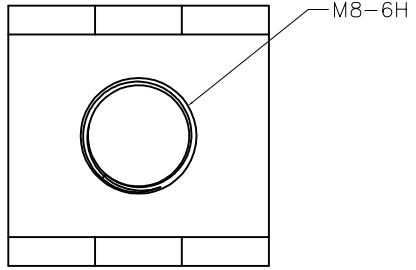

A-A

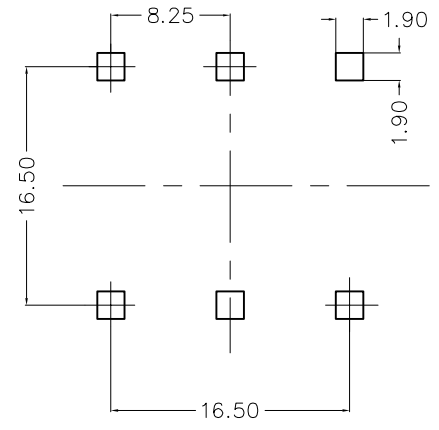
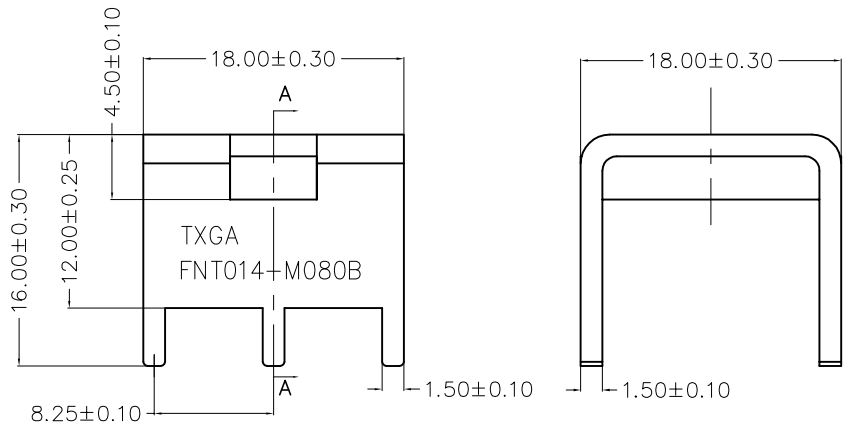

Recommended P.C.Board Layout

 THIRD ANGLE PROJECTION DESIGN UNITS METRIC SCALE 5:1 SIZE A4	GENERAL TOLERANCES (UNLESS SPECIFIED)		APPROVE BY	DATE	PART NO.	ITEM NO.	 Building Technology Cornerstone
	X. ±0.30	X.* ±5°	LEO	30/JAN/23	FNT014-M080B	FNT014	
	X.X ±0.20	X.X* ±2°	CHECKED BY	DATE	TITLE		REV 0
	X.XX ±0.15	X.XX* ±1°	YIQ	30/JAN/23	Nut-type Terminal (M8)		SHEET NO. 1/1
X.XXX ±0.10	X.XXX* ±0.5°	DRAWN BY	DATE	THIS DRAWING CONTAINS INFORMATION THAT IS PROPRIETARY TO TXGA INDUSTRIAL ELECTRONICS(S.Z)CO.,LTD AND SHOULD NOT BE USED WITHOUT WRITTEN PERMISSION			
		YYQ	30/JAN/23				