

REV	LOCATIONS	DESCRIPTION	DATE	REVISER	APPD

SPECIFICATIONS

Electrical
 Current Rating: 3.0A AC(rms)/DC
 Voltage Rating: 250V AC(rms)/DC
 Contact Resistance: 20 mΩ Max
 Insulation Resistance: 1000 MΩ Min
 Withstanding Voltage: 600V AC r.m.s
 Temperature Range—Operating: -40°C~+125°C

Mechanical Performance
 Extraction Force: 1.5kgf

Material
 Housing: PA9T (UL 94V-0), Color: Black
 Pin: Brass /80~160μ" Tin Plated

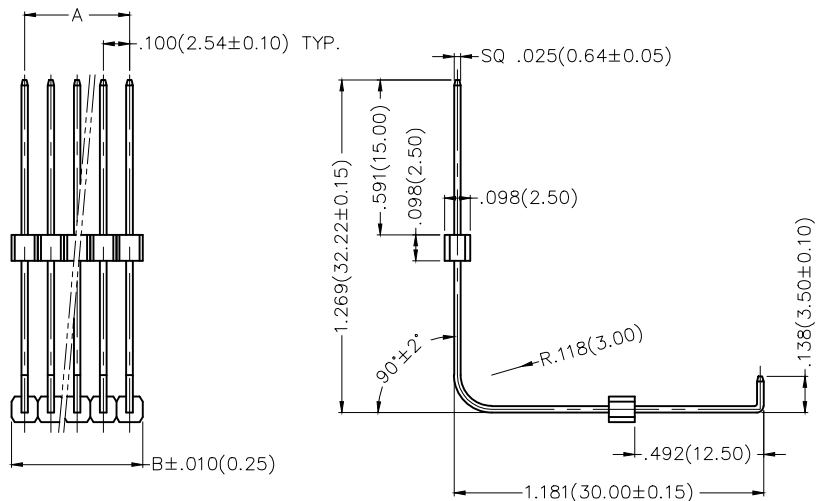

Circuits (n)	Part No.	Dimensions(in/mm)	
		A	B
5	FPH25408-S05B200401M	.400(10.16)	.500(12.70)
11	FPH25408-S11B200401M	1.000(25.40)	1.100(27.94)

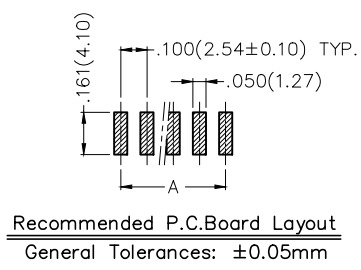

 THIRD ANGLE PROJECTION	GENERAL TOLERANCES (UNLESS SPECIFIED)		APPROVE BY	DATE	PART NO.	ITEM NO.	 Leader Of Industry
	X.X±0.012(0.30)	X'±5'	FRANK	12/OCT/16	FPH25408-SXXB200401M	FPH25408	
DESIGN UNITS	X.XX±.008(0.20)	.X'±2'	CHECKED BY	DATE	TITLE		REV 0 SHEET NO. 1/1
Inch (metric)	X.XX±.006(0.15)	.XX±1'	CHERRY	12/OCT/16	Board to Board(Pin Header) Pitch 2.54mm 90° Angle(SMT)		
SCALE	X.XXX±.004(0.10)	.XXX±0.5'	DRAWN BY	DATE	THIS DRAWING CONTAINS INFORMATION THAT IS PROPRIETARY TO TXGA INDUSTRIAL ELECTRONICS(S.Z)CO.,LTD AND SHOULD NOT BE USED WITHOUT WRITTEN PERMISSION		
5:1			KATE	12/OCT/16			