

REV	LOCATIONS	DESCRIPTION	DATE	REVISER	APPD

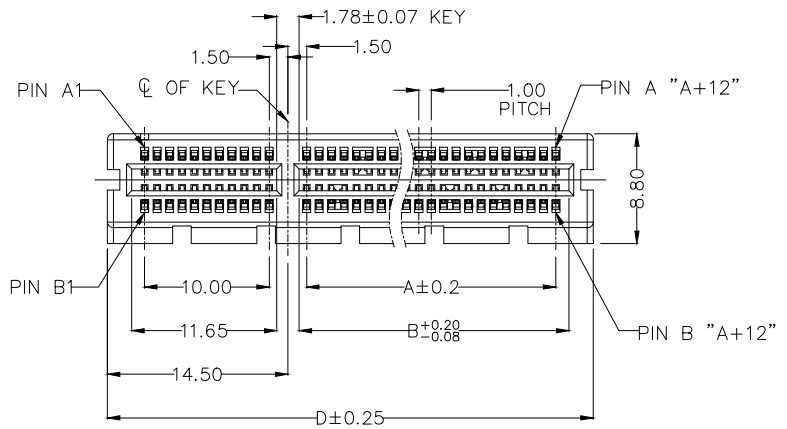

SPECIFICATION

Electrical
 Current Rating: 1.1A AC(rms)/DC
 Voltage Rating: 50V AC(rms)/DC
 Contact Resistance: 30 mΩ Max
 Insulation Resistance: 1000 MΩ MIN
 Withstanding Voltage: 500V AC r.m.s
 Temperature Range-Operating: -40°C~+85°C

Material
 Housing: PA9T, (UL 94V-0)
 Contact: Copper Alloy/, Selective gold plated on contact area and matte tin plated on tails area

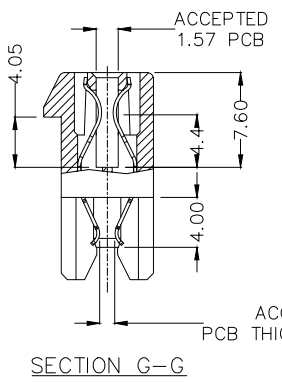
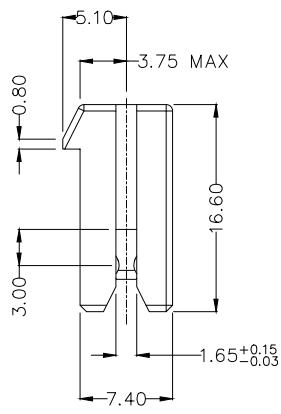
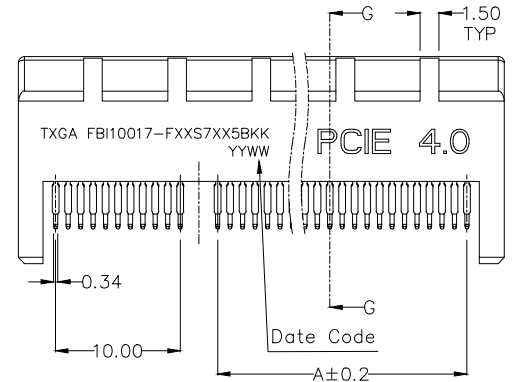

Circuits(n)	Part NO.	Dimensions			
		A	B	D	E
36	FPI10017-F36S7XX5BKK	6.0	7.65	25.0	23.0
64	FPI10017-F64S7XX5BKK	20.0	21.65	39.0	37.0
98	FPI10017-F98S7XX5BKK	37.0	38.65	56.0	54.0
164	FPI10017-F164S7XX5BKK	70.0	71.65	89.0	87.0

Ordering Information

FPI 100 17 - F XX S 7 XX 5 BK K
 1 2 3 4 5 6 7 8 9 10 11

1 Category FPI-PCIE	2 Series Number 100-Pitch1.00mm	3 Distinction No. 17	4 Type F-Female	5 Circuits XX	6 Entry Angle S-180° Vertical
7 Plating 7-Selective gold plated on contact area and matte tin plated on tails area	8 thickness of Gold Plating 00-Gold Flash 15-15u" 30-30u"	9 Material-Resin 5-PA9T	10 Color-Resin BK-Black	11 Packaging K-Tray	

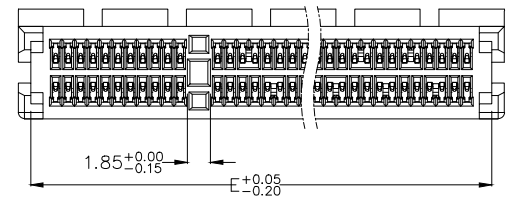

<p>THIRD ANGLE PROJECTION</p>	GENERAL TOLERANCES (UNLESS SPECIFIED) X. ±0.30 X.* ±5* X.X ±0.20 X.X* ±2* X.XX ±0.15 X.XX* ±1* X.XXX ±0.10 X.XXX* ±0.5*		APPROVE BY LEO	DATE 19/Sept/23	PART NO. FPI10017-FXXS7XX5BKK	ITEM NO. FPI10017	<p>TXGA Building Technology Cornerstone</p>
	DESIGN UNITS METRIC(mm)	CHECKED BY GISELLE	DATE 19/Sept/23	TITLE PCI Express Gen4.0(16GT/S), 180°vertical Pitch 1.0mm	REV 0 SHEET NO. 1/3		
SCALE 5:1	SIZE A4	DRAWN BY Hejianpeng	DATE 19/Sept/23	THIS DRAWING CONTAINS INFORMATION THAT IS PROPRIETARY TO TXGA INDUSTRIAL ELECTRONICS(S.Z)CO.,LTD AND SHOULD NOT BE USED WITHOUT WRITTEN PERMISSION			

REV	LOCATIONS	DESCRIPTION	DATE	REVISER	APPD

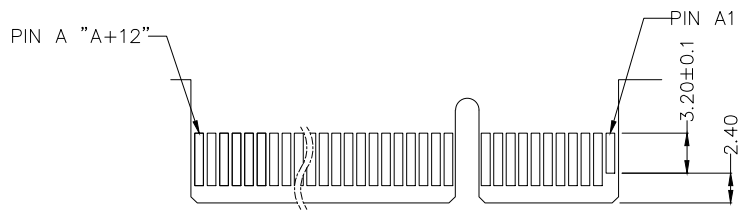
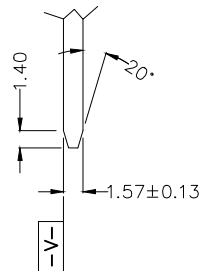
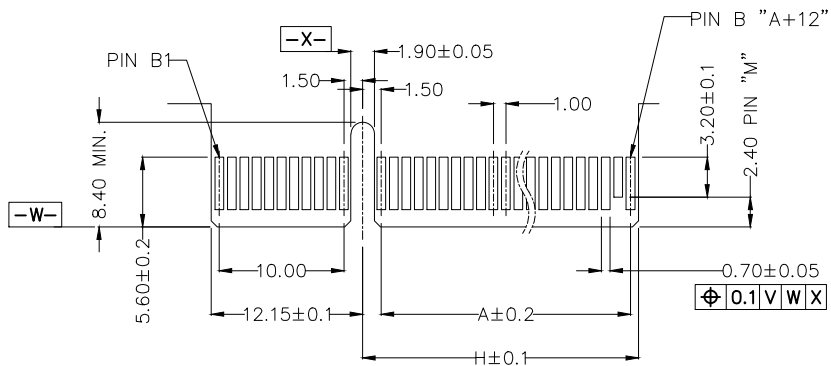

SECONDARY (SOLDER) SIDE

I/O PANEL DIRECTION
PRIMARY (COMPONENT) SIDE

NOTES:
CHAMFER EDGE MUST BE FREE OF CUTTING BURRS

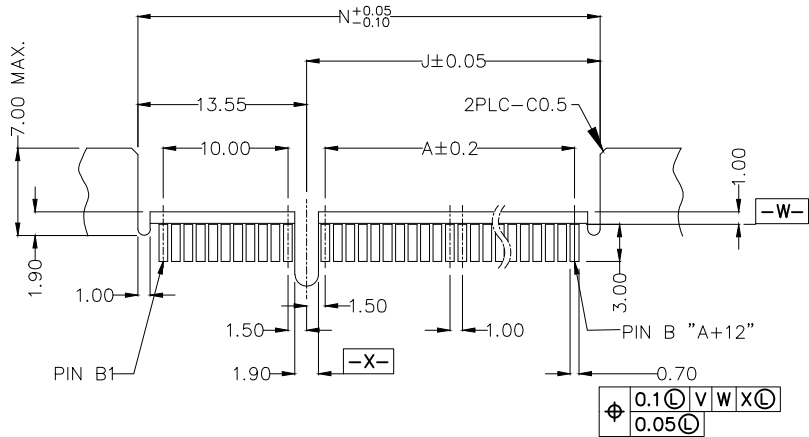

RECOMMENDED PCB LAYOUT
TOLERANCE: ±0.05

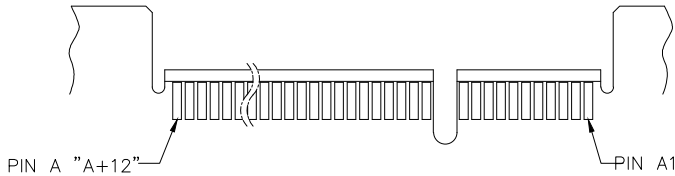
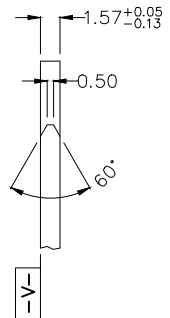

Circuits(n)	Part NO.	Dimensions				
		A	H	J	N	M
36	FPI10017-F36S7XX5BKK	6.0	8.15	9.55	23.1	B17
64	FPI10017-F64S7XX5BKK	20.0	22.15	23.55	37.1	B31
98	FPI10017-F98S7XX5BKK	37.0	39.15	40.55	54.1	B48
164	FPI10017-F164S7XX5BKK	70.0	72.15	73.55	87.1	B81

<p>THIRD ANGLE PROJECTION</p>	GENERAL TOLERANCES (UNLESS SPECIFIED)		APPROVE BY	DATE	PART NO.	ITEM NO.	<p>Building Technology Cornerstone</p>	
	X. ±0.30	X.* ±5°	LEO	19/Sept/23				FPI10017-FXXS7XX5BKK
	DESIGN UNITS METRIC(mm)		CHECKED BY	DATE	TITLE			REV 0
	X.X ±0.20	X.X* ±2°	GISELLE	19/Sept/23	PCI Express Gen4.0, 180°vertical Pitch 1.0mm			SHEET NO. 2/3
SCALE	SIZE	X.XX ±0.15	X.XX* ±1°	DRAWN BY	DATE	THIS DRAWING CONTAINS INFORMATION THAT IS PROPRIETARY TO TXGA INDUSTRIAL ELECTRONICS(S.Z)CO.,LTD AND SHOULD NOT BE USED WITHOUT WRITTEN PERMISSION		
5:1	A4	X.XXX ±0.10	X.XXX* ±0.5°	Hejianpeng	19/Sept/23			

1 2 3 4 5 6 7 8

REV	LOCATIONS	DESCRIPTION	DATE	REVISER	APPD

With Dummy Card

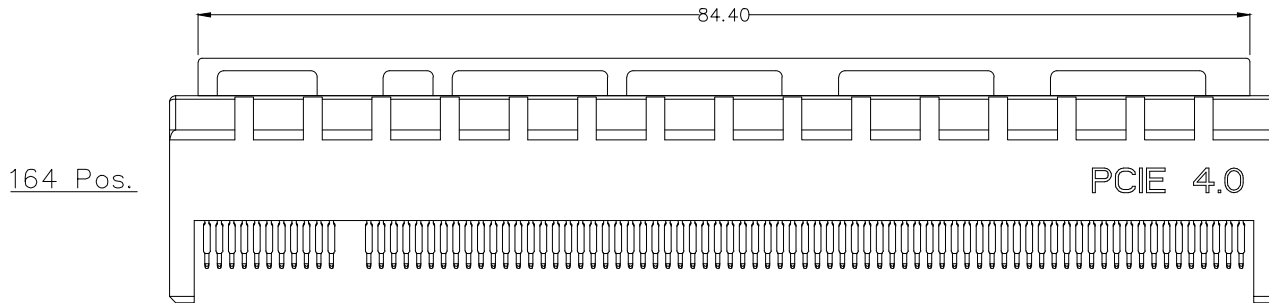
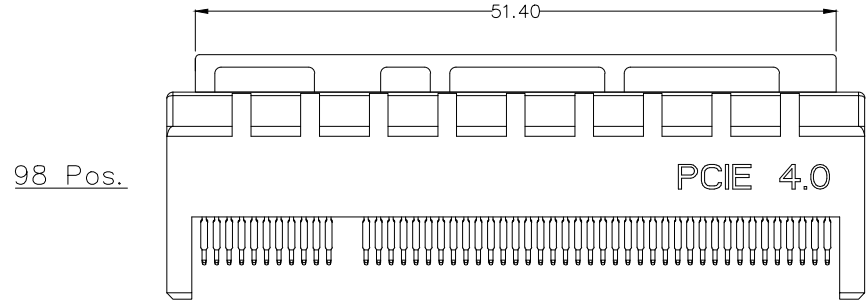
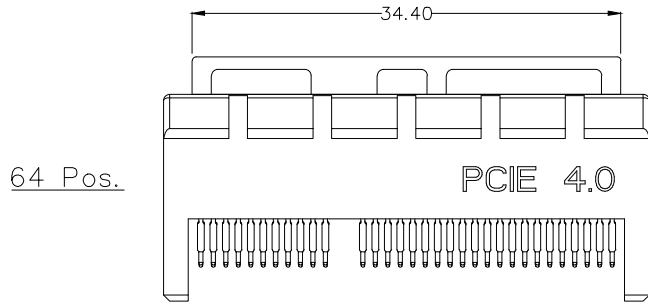
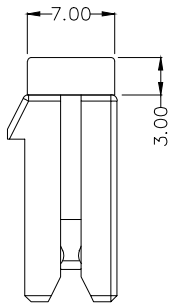
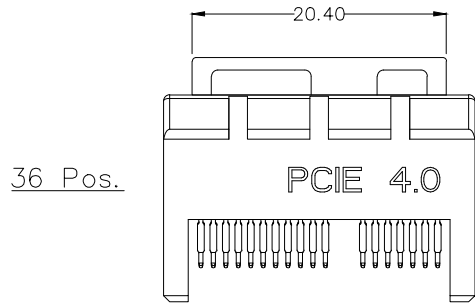

<p>THIRD ANGLE PROJECTION</p>	GENERAL TOLERANCES (UNLESS SPECIFIED)		APPROVE BY	DATE	PART NO.	ITEM NO.	<p>Building Technology Cornerstone</p>		
	X. ±0.30	X.' ±5°	LEO	19/Sept/23	FPI10017-FXXS7XX5BKK	FPI10017			
	DESIGN UNITS METRIC(mm)	X.X ±0.20	X.X' ±2°	CHECKED BY	DATE	TITLE PCI Express Gen4.0, 180°vertical Pitch 1.0mm		REV 0	SHEET NO. 3/3
	SCALE 5:1	SIZE A4	X.XX ±0.15	X.XX' ±1°	DRAWN BY	DATE	THIS DRAWING CONTAINS INFORMATION THAT IS PROPRIETARY TO TXGA INDUSTRIAL ELECTRONICS(S.Z)CO.,LTD AND SHOULD NOT BE USED WITHOUT WRITTEN PERMISSION		
		X.XXX ±0.10	X.XXX' ±0.5°	Hejianpeng	19/Sept/23				

1 2 3 4 5 6 7 8