

1 2 3 4 5 6 7 8

REV	LOCATIONS	DESCRIPTION	DATE	REVISER	APPD
1	▲	Structural changes	02/DEC/21	MATT	CHERRY

Specifications

Electrical

Current Rating: 3 Ampere
 Insulation Resistance: 1000M ΩMin.
 Withstanding Voltage: 500V AC
 Contact Resistance: 20m ΩMax.
 Temperature Range—Operating: -40°C to +105°C

Materials

Housing: PBT (UL 94V-0) Black
 Terminal: Phosphor bronze/Nickel Plated
 *All Materials Meet The "RoHs"

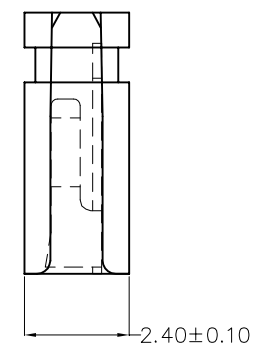
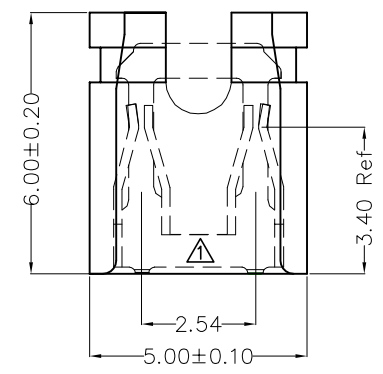

 THIRD ANGLE PROJECTION	GENERAL TOLERANCES (UNLESS SPECIFIED)		APPROVE BY	DATE	PART NO.	ITEM NO.	 Leader Of Industry
	X.±.012(0.30)	X.±5'	FRANK	26/JUN/13	FR-1YF-01	FR-1YF	
DESIGN UNITS Inch (metric)	X.X±.008(0.20)	.X'±2'	CHECKED BY	DATE	TITLE		REV 0 SHEET NO. 1/1
	X.XX±.006(0.15)	.XX'±1'	JACOB	26/JUN/13	.100' (2.54mm) PITCH Conn (Open)		
SCALE	SIZE	X.XXX±.004(0.10)	DRAWN BY	DATE	THIS DRAWING CONTAINS INFORMATION THAT IS PROPRIETARY TO TXGA INDUSTRIAL ELECTRONICS(S.Z)CO.,LTD AND SHOULD NOT BE USED WITHOUT WRITTEN PERMISSION		
5:1	A4	.XXX'±0.5'	CHERRY	26/JUN/13			

1 2 3 4 5 6 7 8