

REV	LOCATIONS	DESCRIPTION	DATE	REVISER	APPD

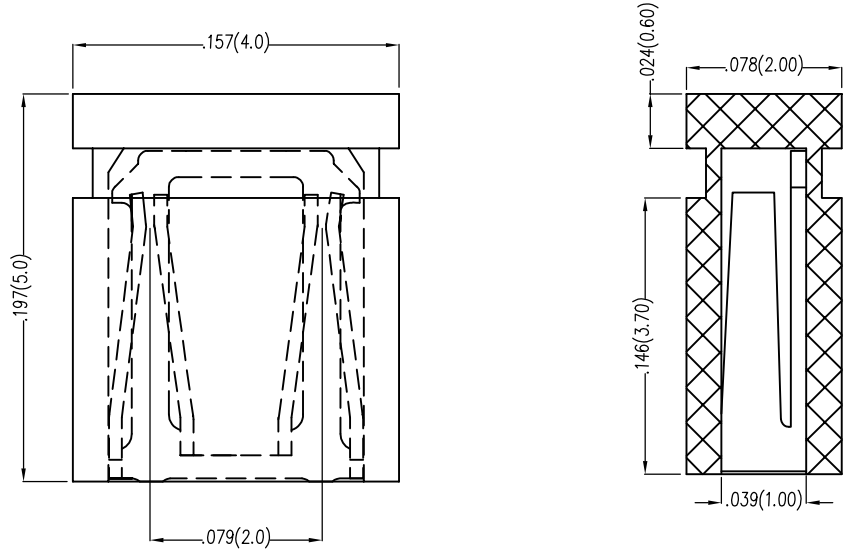

**SPECIFICATIONS**

Current Rating : 1.5Amps  
 Contact Resistance : 20m Ω Max  
 Insulation Resistance : 1000M Ω Min  
 Withstanding Voltage : AC 500V  
 Operating Temperature: -40°to+ 105°  
 Contact Material : Phosphor bronze  
 Contact plating : Au or over 50u" Ni  
 Insulator Material : Polyester,UL 94V-0  
 Standard : P.B.T

闭口

 Third Angle Projection	<b>TOLERANCE</b> (Expect as noted)		APPROVE	Frank	PART NO:		TITLE:	ITEM NO:	
	UNIT: in(mm)	X.±.012(0.30)	X.*5'	CHECK	FAN	FR-1YF-04		Mini jump	
SCALE: 1:1	X.XX±.006(0.15)	.XX±1'	DRAWN	Cherry	DATE	13/JUN/11	REQUIRED DOCUMENTS:		REV: 0
	X.XXX±.004(0.10)	.XXX±0.5'					Mini jump Pitch: 2.00mm		