

1 2 3 4 5 6 7 8

REV	LOCATIONS	DESCRIPTION	DATE	REVISER	APPD

SPECIFICATIONS

Electrical
 Current Rating: 1.5A AC(rms)/DC
 Voltage Rating: 125V AC(rms)/DC
 Contact Resistance: 30 mΩ Max
 Insulation Resistance: 500 MΩ Min / DC 500V
 Withstanding Voltage: 1000V AC r.m.s
 Operating Temperature: -40°C~+85°C

Mechanical
 Durability: 750 cycles Min.
 Mating force: 2.2KG.F Max.
 Retention force: 7.7KG.F between jack and plug

Material and plating
 Housing: PBT (UL 94V-0), Black
 Contact: Phosphor Bronze/ Selective gold in contact area, tin on tail

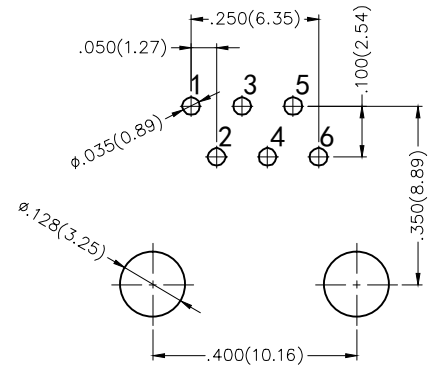
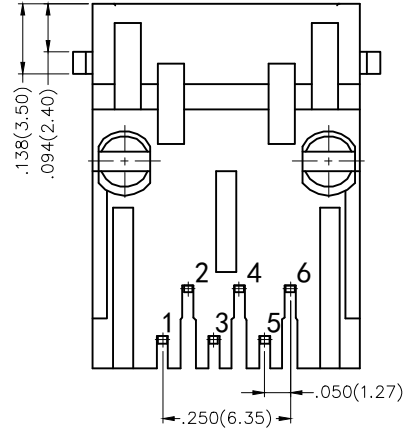
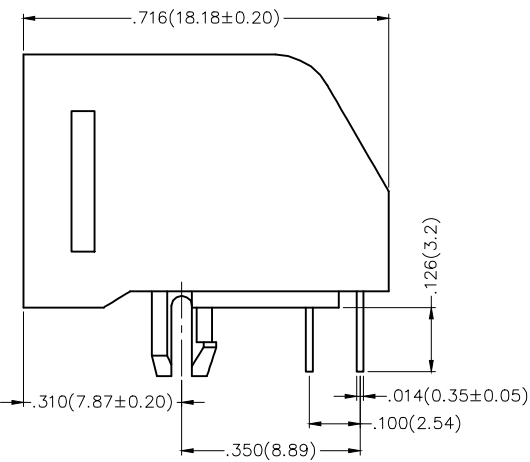
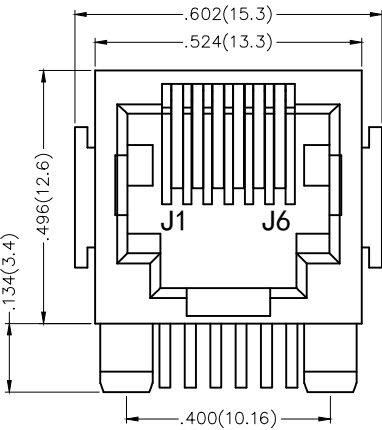

Recommended P.C.Board Layout
 Tolerances: ±.002(0.05)

Ordering Information

FRJ11 009 — 1 3 XX K6 K 1 0
 1 2 3 4 5 6 7 8

1 <u>Category</u> FRJ11-RJ11 Connector	2 <u>Distinction No.</u> 009	3 <u>Ports options</u> 1-1 Port	4 <u>Plating</u> 3-Selective gold in contact area, tin on tail
5 <u>Thickness of plating</u> 00-Gold flash 03-3μ" Custom plate available	6 <u>Color-Resin</u> K6-Black	7 <u>Packaging</u> K-Tray	8 <u>Contact type</u> 1-Square pin

A
B
C
D
E
F

A
B
C
D
E
F

<p>THIRD ANGLE PROJECTION</p>	GENERAL TOLERANCES (UNLESS SPECIFIED) X.±.012(0.30) X'±5' X.X±.008(0.20) X'±2' X.XX±.006(0.15) .XX'±1' X.XXX±.004(0.10) .XXX'±0.5'		APPROVE BY FRANK DATE 16/DEC/17	PART NO. FRJ11009-13XXK6K10 ITEM NO. FRJ11009	<p>Leader Of Industry</p>
	DESIGN UNITS Inch (metric)	CHECKED BY CHERRY DATE 16/DEC/17	TITLE RJ11 Connector 6P6C 90° Angle	REV 0 SHEET NO. 1/1	
SCALE 5:1	SIZE A4	DRAWN BY KATE DATE 16/DEC/17	THIS DRAWING CONTAINS INFORMATION THAT IS PROPRIETARY TO TXGA INDUSTRIAL ELECTRONICS(S.Z)CO.,LTD AND SHOULD NOT BE USED WITHOUT WRITTEN PERMISSION		

1 2 3 4 5 6 7 8