

REV	LOCATIONS	DESCRIPTION	DATE	REVISER	APPD

SPECIFICATIONS

Electrical
 Current Rating: 1.5A AC(rms)/DC
 Voltage Rating: 125V AC(rms)/DC
 Contact Resistance: 30 mΩ Max
 Insulation Resistance: 500 MΩ Min / DC 500V
 Withstanding Voltage: 1000V AC r.m.s
 Operating Temperature: -40°C~+85°C

Mechanical
 Durability: 750 cycles Min.
 Mating force: 2.2KG.F Max.
 Retention force: 7.7KG.F between jack and plug

Material and plating
 Housing: PBT (UL 94V-0), Black
 Terminals bracket: PBT (UL 94V-0), Red
 Terminal: Phosphor Bronze/ Selective gold on contact area and bright tin on tails area

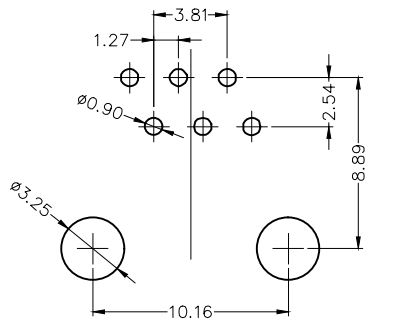
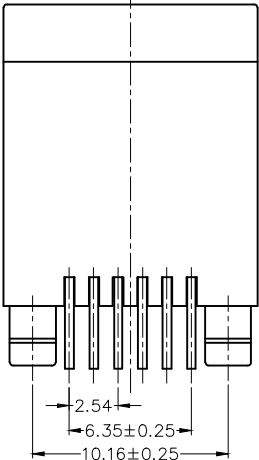
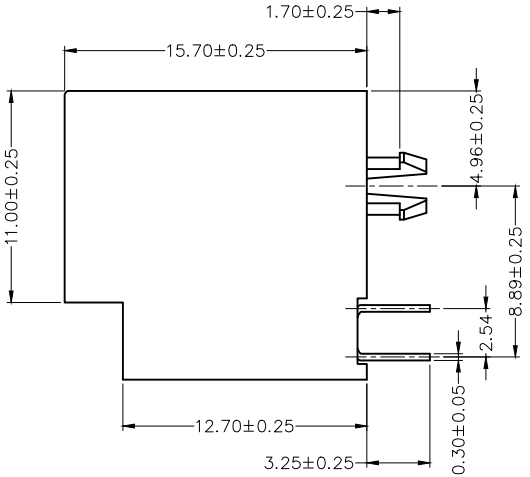
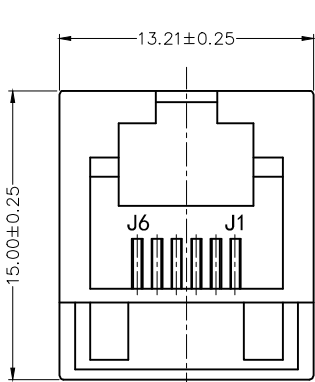

Ordering Information

FRJ11 011 — 1 3 XX BK K 1 0
 1 2 3 4 5 6 7 8

1 Category FRJ11-RJ11 Connector	2 Distinction No. 011	3 Ports options 1-1 Port	4 Plating 3-Selective gold on contact area, bright tin on tail
5 Thickness of plating 00-Gold flash 06-6μ" Custom plate available	6 Color-Resin BK-Black	7 Packaging K-Tray	8 Contact type 1-Square pin

<p>THIRD ANGLE PROJECTION</p>	GENERAL TOLERANCES (UNLESS SPECIFIED)		APPROVE BY FRANK	DATE 25/JUN/21	PART NO. FRJ11011-13XXBKK10	ITEM NO. FRJ11011	<p>Leader Of Industry</p>		
	X. ±0.30	X.' ±5'	CHECKED BY CHERRY	DATE 25/JUN/21	TITLE RJ11 Connector 6P6C 180° Vertical			REV 0	SHEET NO. 1/1
	X.X ±0.20	X.X' ±2'	DRAWN BY KATE	DATE 25/JUN/21	THIS DRAWING CONTAINS INFORMATION THAT IS PROPRIETARY TO TXGA INDUSTRIAL ELECTRONICS(S.Z)CO.,LTD AND SHOULD NOT BE USED WITHOUT WRITTEN PERMISSION				
DESIGN UNITS Metric	X.XX ±0.15	X.XX' ±1'							
SCALE 5:1	SIZE A4	X.XXX ±0.10	X.XXX' ±0.5'						