

REV	LOCATIONS	DESCRIPTION	DATE	REVISER	APPD

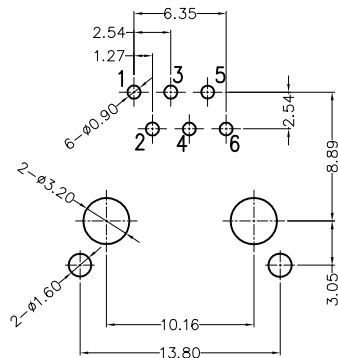
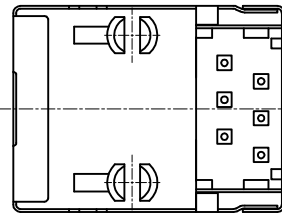
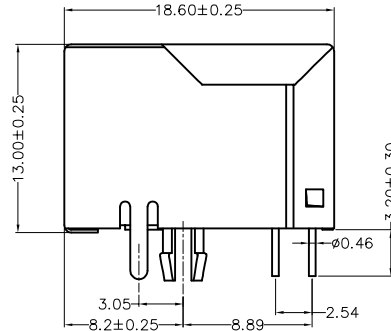
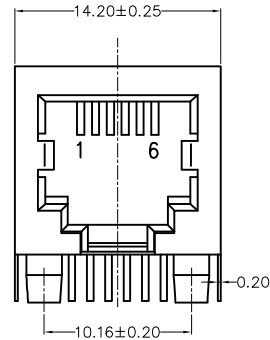
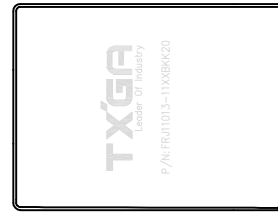

Recommended P.C.Board Layout
Tolerances: ±0.05

SPECIFICATIONS

Electrical Performances

- Current Rating: 1.5A AC(rms)/DC
- Voltage Rating: 125V AC(rms)/DC
- Contact Resistance: 50 mΩ Max
- Insulation Resistance: 500 MΩ Min
- Withstanding Voltage: 1000V AC r.m.s
- Temperature Range-Operating: -40°C~+85°C
- Durability: 750 Cycles Min.
- Mating force: 2.2KG.F Max.
- Retention force: 7.7KG.F between jack and plug

Material and Plating

- Housing: PBT (UL 94V-0) Black
- Contact: Phosphor Bronze/ Gold plated
- Shell: Copper Alloy/ Nickel plated

Ordering Information

FRJ11 013 - 1 1 XX BK K 2 0
1 2 3 4 5 6 7 8

1 Category FRJ11-RJ11 Connector	2 Distinction No. 013	3 Ports options 1-1 Port	4 Plating 1-Gold Plated
5 Thickness of plating 00-Gold flash 03-3μ" Custom plate available	6 Color-Resin BK-Black	7 Packaging K-Tray	8 Contact type 2-Round pin

 THIRD ANGLE PROJECTION	GENERAL TOLERANCES (UNLESS SPECIFIED)		APPROVE BY FRANK	DATE 31/AUG/22	PART NO. FRJ11013-11XXBKK20	ITEM NO. FRJ11013	
	X.±0.30	X.±5°	CHECKED BY CHERRY	DATE 31/AUG/22	TITLE RJ11 Connector 6P6C 90° Angle (DIP)		
DESIGN UNITS Metric	X.X±0.20	.X'±2°	DRAWN BY MATT	DATE 31/AUG/22	THIS DRAWING CONTAINS INFORMATION THAT IS PROPRIETARY TO TXGA INDUSTRIAL ELECTRONICS(S.Z)CO.,LTD AND SHOULD NOT BE USED WITHOUT WRITTEN PERMISSION		
SCALE 5:1	SIZE A4	X.XX±0.15	.XX'±1°				
		X.XXX±0.10	.XXX'±0.5°				