

REV	LOCATIONS	DESCRIPTION	DATE	REVISER	APPD
1	△	Part No.: Change FRJ45145 into FRJ45015	31/MAY/18	KATE	ERIC
2	△	1. Size changes 2. Specifications changes	08/MAR/21	KATE	CHERRY

**SPECIFICATIONS**

**Electrical**

Current Rating: 1.5A AC(rms)/DC  
Voltage Rating: 125V AC(rms)/DC  
Contact Resistance: 20 mΩ Max  
Insulation Resistance: 500 MΩ Min / DC 500V  
Withstanding Voltage: 500V AC r.m.s  
Operating Temperature: -40°C~+85°C  
Durability: 750 Cycles Min  
Mating Force: 23N Max

**Material and Plating**  
Housing: PBT (UL 94V-0) Black  
Contact: Phosphor Bronze/ Selective gold in contact area, tin on tail  
Shell: Brass/Nickel Plated

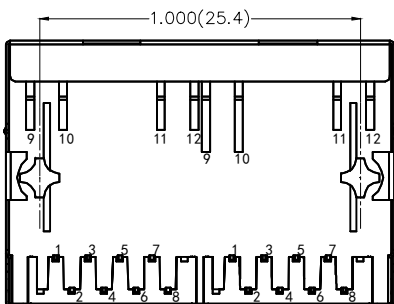
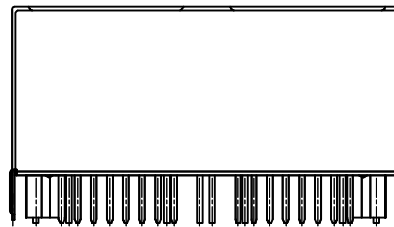
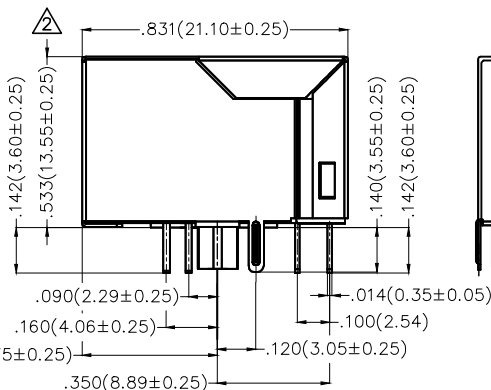
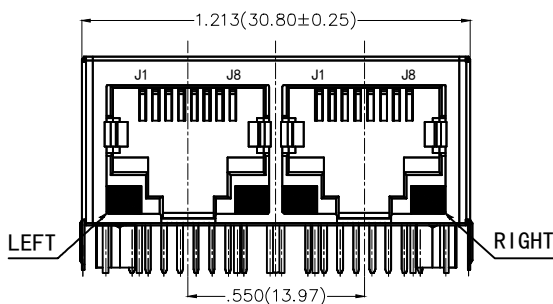
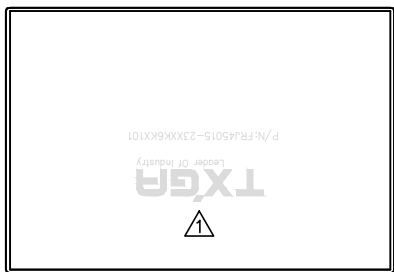

**Ordering Information**

FRJ45 015 - 2 3 XX K6 K X 1 0 1  
1 2 3 4 5 6 7 8 9 10

1   Category FRJ45-RJ45 Connector	2   Distinction No. 015	3   Ports options 2-2 Ports	4   Plating 3-Selective gold in contact area, tin on tail	5   Thickness of plating 00-Gold flash 03-3μ" Custom plate available
6   Color-Resin K6-Black	7   Packaging K-Tray	8   LED style 1-L: Yellow R: Green 2-L: Green R: Yellow	9   Contact type 1-Square pin	10   Pin circuits 1-100Base-T

<p>THIRD ANGLE PROJECTION</p>	GENERAL TOLERANCES (UNLESS SPECIFIED)		APPROVE BY VERNON	DATE 07/AUG/17	PART NO. △ FRJ45015-23XXK6KX101	ITEM NO. FRJ45015	<p>Leader Of Industry</p>
	DESIGN UNITS Inch (metric)	X.±.010(0.25) X.X±.008(0.20) X.XX±.004(0.10) X.XXX±.002(0.05)	X'.±3' .X'±2' .XX'±1.5' .XXX'±1.0'	CHECKED BY KATE	DATE 07/AUG/17	TITLE RJ45 Connector 8P8C 90°Angle(100Base-T)	
SCALE 5:1	SIZE A4		DRAWN BY LXF	DATE 07/AUG/17	THIS DRAWING CONTAINS INFORMATION THAT IS PROPRIETARY TO TXGA INDUSTRIAL ELECTRONICS(S.Z)CO.,LTD AND SHOULD NOT BE USED WITHOUT WRITTEN PERMISSION		REV 2   SHEET NO. 1/2

REV	LOCATIONS	DESCRIPTION	DATE	REVISER	APPD

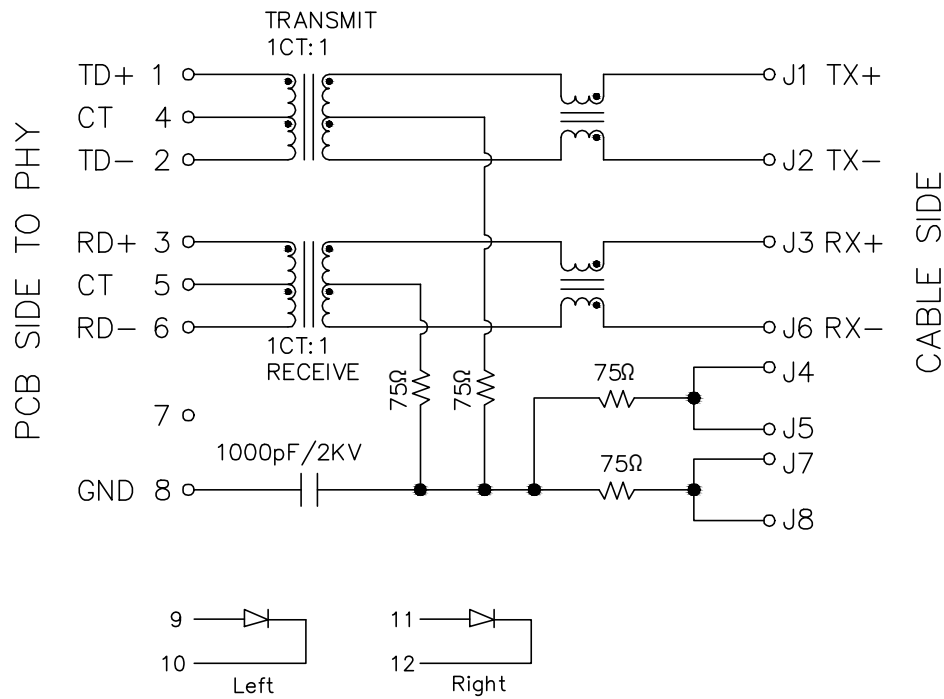

⚠

Electrical Specifications@25°C±5°C							
Turns Ratio(±2%)		OCL(μH Min) @100KHz/0.1V	Insertion Loss (dB Max)	HI-Pot (V AC rms)			
TX	RX	With 8mA DC Bias	1-100MHz	2250V DC 6S 1mA			
1CT:1CT	1CT:1CT	350	-1.0	1500			
Retrun Loss (dB Min)				Cross talk (dB Min)			CMR (dB Min)
1-10MHz	10-30MHz	30-60MHz	60-80MHz	1-30MHz	30-60MHz	60-100MHz	1-100MHz
-20	-16	-12	-10	-40	-35	-30	-30

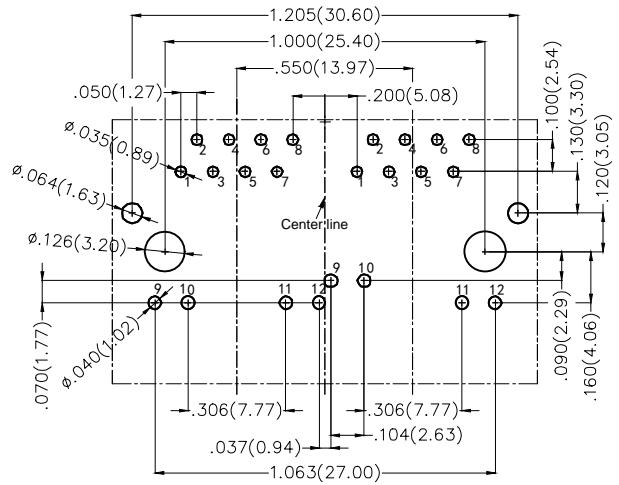

Recommended P.C.Board Layout

⚠ Specification LED

Standard LED Color	LED Wavelength	Foward(A)	Foward(V)
Green	568mm	20mA	1.85-2.45V
Yellow	585mm	20mA	1.8-2.8V

 THIRD ANGLE PROJECTION	GENERAL TOLERANCES (UNLESS SPECIFIED)		APPROVE BY VERNON	DATE 07/AUG/17	PART NO. FRJ45015-23XXK6KX101	ITEM NO. FRJ45015	 Leader Of Industry	
	X.±.010(0.25)	X.±3'	CHECKED BY KATE	DATE 07/AUG/17	TITLE RJ45 Connector 8P8C 90°Angle(100Base-T)			
DESIGN UNITS Inch (metric)	X.X±.008(0.20)	X'±2'	DRAWN BY LXF	DATE 07/AUG/17	THIS DRAWING CONTAINS INFORMATION THAT IS PROPRIETARY TO TXGA INDUSTRIAL ELECTRONICS(S.Z)CO.,LTD AND SHOULD NOT BE USED WITHOUT WRITTEN PERMISSION		REV 2	SHEET NO. 2/2
SCALE 5:1	SIZE A4	X.XX±.004(0.10)						
		X.XXX±.002(0.05)						