

REV	LOCATIONS	DESCRIPTION	DATE	REVISER	APPD
1	△	1. Dimension: Change 15.70 into 15.90mm 2. Part No.: Change FRJ4537 into FRJ45037	01/JUN/18	Vandy	Eric
2	△	Size change	23/MAR/20	KATE	CHERRY
3	△	Size change	09/MAY/22	MATT	CHERRY

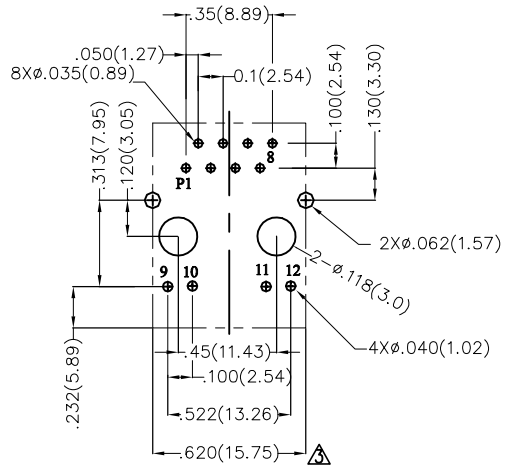
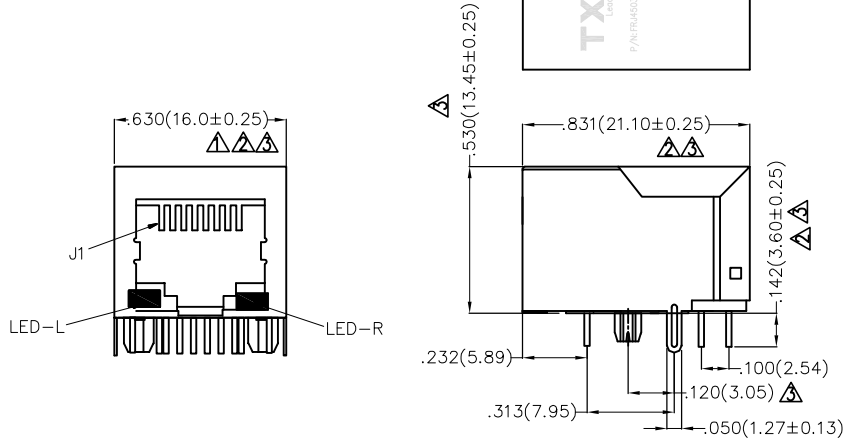

Recommended P.C.Board Layout

SPECIFICATIONS

Complies With IEEE Standards And All 10/100 Ethernet Specifications Including 350uH With 8mA DC Bias

Electrical Performances
 Current Rating: 1.5A AC(rms)/DC
 Voltage Rating: 125V AC(rms)/DC
 Contact Resistance: 30 mΩ Max
 Insulation Resistance: 500 MΩ MIN
 Withstanding Voltage: 1000V AC r.m.s

Material and Plating
 Housing: PBT UL 94V-0
 Contact: Phosphor Bronze/ Plated Nickel 30u Min, Gold plated On Content Area
 Shell: Copper Alloy/Nickel Plated

Mechanical Performances
 Mating/Unmating Force: 30N Max
 Retention Strength: 50N For 60s±5s
 Durability: 750 Cycles Min.

Environmental Characteristics
 Temperature Range-Operating: -40°C~+85°C

Ordering Information

FRJ45 037 — 1 3 XX K6 K X 1 0 1
 1 2 3 4 5 6 7 8 9 10

1 Category FRJ45-RJ45 Connector	2 Distinction No. 037	3 Ports options 1-1 Port	4 Plating 3-Selective gold in contact area, tin on tail	5 Thickness of plating 00-Gold flash 03-3μ" Custom plate available
6 Color-Resin K6-Black	7 Packaging K-Tray	8 LED style 1-L: Yellow R:Green 2-L: Green R: Yellow	9 Contact type 1-Square pin	10 Pin circuits 1-100Base-T

 THIRD ANGLE PROJECTION	GENERAL TOLERANCES (UNLESS SPECIFIED)		APPROVE BY FRANK	DATE 1/AUG/13	PART NO. △ FRJ45037-13XXK6KX101	ITEM NO. FRJ45037	
	DESIGN UNITS Inch (metric)	X.±.012(0.30)	X:±5'	CHECKED BY CHERRY	DATE 1/AUG/13	TITLE RJ45 Connectors 8P8C 90°Angle(100Base-T)	
SCALE 5:1	SIZE A4	X.XX±.006(0.15)	.XX'±1'	DRAWN BY JACOB	DATE 1/AUG/13	THIS DRAWING CONTAINS INFORMATION THAT IS PROPRIETARY TO TXGA INDUSTRIAL ELECTRONICS(S.Z)CO.,LTD AND SHOULD NOT BE USED WITHOUT WRITTEN PERMISSION	
		X.XXX±.004(0.10)	.XX'±0.5'			REV 3	SHEET NO. 1/2

REV	LOCATIONS	DESCRIPTION	DATE	REVISER	APPD

SCHEMATIC

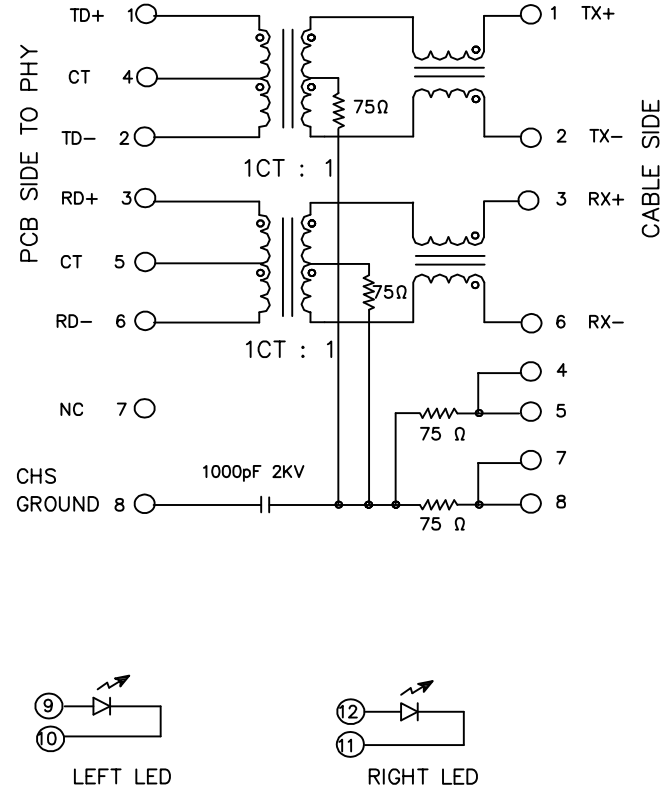

Electrical Specifications: (25°C)

- Turns Ratio:
TX & Rx= 1:1±3%
- Insertion Loss:
@1~100MHz: -1.0dB Max
- Return Loss:
@1~10MHz : -20dB Min
@10~30MHz : -16dB Min
@30~60MHz : -12dB Min
@60~100MHz : -10dB Min
- Common Mode Rejection:
@1~100MHz: -30dB Min
- Crosstalk:
@1~30MHz : -40dB Min
@30~60MHz : -35dB Min
@60~100MHz : -30dB Min
- OCL: @100KHz, 0.1V
8mADC : 350uH Min
- Hi-Pot : 1500VAC, 1mA, 1Sec

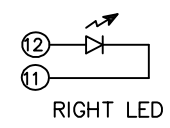
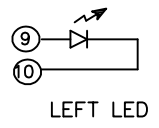

 THIRD ANGLE PROJECTION	GENERAL TOLERANCES (UNLESS SPECIFIED)		APPROVE BY FRANK	DATE 1/AUG/13	PART NO. FRJ45037-13XXK6KX101	ITEM NO. FRJ45037	 Leader Of Industry
	DESIGN UNITS Inch (metric)	X.±.012(0.30)	X'.±5'	CHECKED BY CHERRY	DATE 1/AUG/13	TITLE RJ45 Connectors 8P8C 90°Angle(100Base-T)	
SCALE 5:1	SIZE A4	X.XX±.006(0.15)	.XX'±1'	DRAWN BY JACOB	DATE 1/AUG/13	THIS DRAWING CONTAINS INFORMATION THAT IS PROPRIETARY TO TXGA INDUSTRIAL ELECTRONICS(S.Z)CO.,LTD AND SHOULD NOT BE USED WITHOUT WRITTEN PERMISSION	
		X.XXX±.004(0.10)	.XXX'±0.5'				