

REV	LOCATIONS	DESCRIPTION	DATE	REVISER	APPD
1	△	Part No.: Change FRJ45112 into FRJ45042	31/MAY/18	KATE	ERIC
2	△	The color of LED and Material Changes	19/APR/22	MATT	KATE

A
B
C
D
E
F

A
B
C
D
E
F

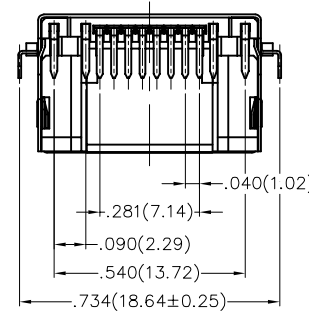
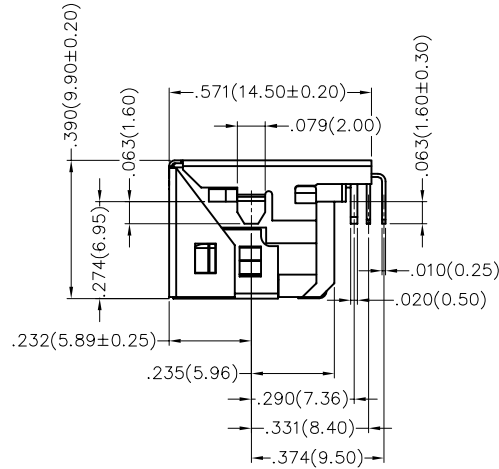
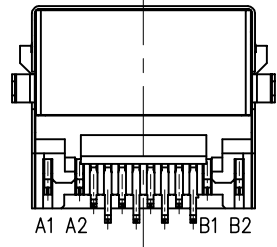
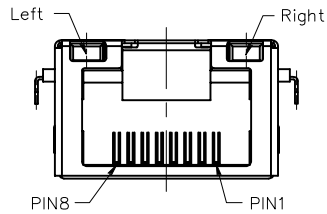
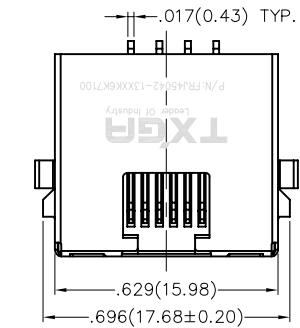

Left
A1(+)
A2(-)
B1(+)
B2(-)
Right

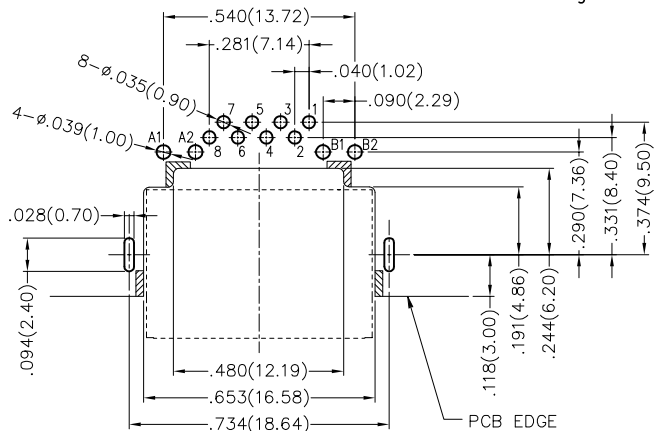

Recommended P.C.Board Layout

SPECIFICATIONS

Electrical

Current Rating: 1.5A AC(rms)/DC
Voltage Rating: 125V AC(rms)/DC
Contact Resistance: 40 mΩ Max
Insulation Resistance: 500 MΩ Min / DC 500V
Withstanding Voltage: 1000V AC r.m.s
Operating Temperature: -20°C~+75°C

Material and Plating

Housing: PA10T (UL 94V-0), Black
Contact: Phosphor Bronze/Selective gold on contact area, tin on tail
Shell: Brass/Nickel Plated

Ordering Information

FRJ45 042 - 1 3 XX K6 K 7 1 0 0
1 2 3 4 5 6 7 8 9

1 Category FRJ45-RJ45 Connector	2 Distinction No. 042	3 Ports options 1-1 Port	4 Plating 3-Selective gold in contact area, tin on tail	5 Thickness of plating 00-Gold flash 02-2μ" Custom plate available
6 Color-Resin K6-Black	7 Packaging K-Tray	8 LED style 7-L: Yellow R: Green △	9 Contact type 1-Square pin	

THIRD ANGLE PROJECTION	GENERAL TOLERANCES (UNLESS SPECIFIED)		APPROVE BY FRANK	DATE 18/JUN/13	PART NO. △ FRJ45042-13XXK6K7100	ITEM NO. FRJ45042	 Leader Of Industry	
	DESIGN UNITS Inch (metric)	X.±.012(0.30) X.X±.008(0.20) X.XX±.006(0.15) X.XXX±.004(0.10)	X.±5° .X±2° .XX±1° .XXX±0.5°	CHECKED BY CHERRY	DATE 18/JUN/13	TITLE RJ45 Connectors 8P8C 90°Angle		REV 1
SCALE 5:1	SIZE A4		DRAWN BY KATE	DATE 18/JUN/13	THIS DRAWING CONTAINS INFORMATION THAT IS PROPRIETARY TO TXGA INDUSTRIAL ELECTRONICS(S.Z)CO.,LTD AND SHOULD NOT BE USED WITHOUT WRITTEN PERMISSION			

1 2 3 4 5 6 7 8

REV	LOCATIONS	DESCRIPTION	DATE	REVISER	APPD

A
B
C
D
E
F

A
B
C
D
E
F

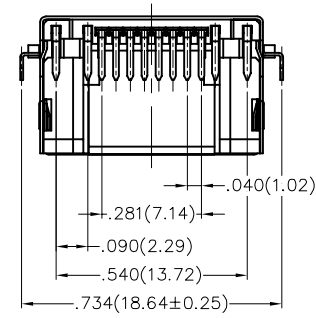
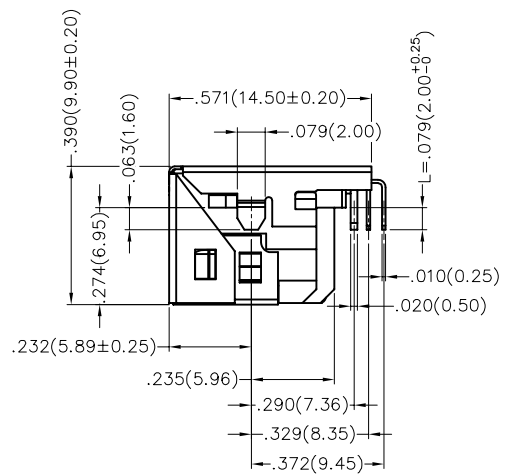
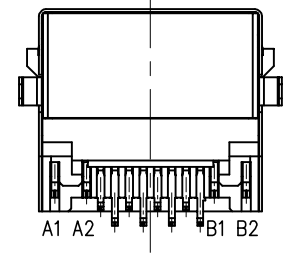
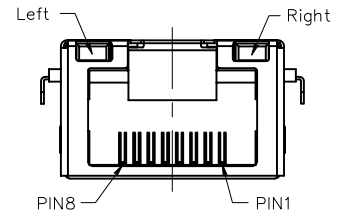
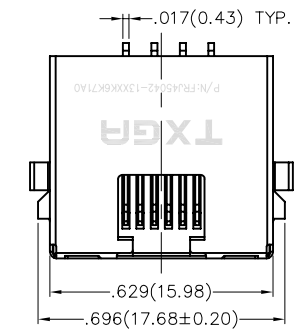

Left
A1(+) ← A2(-)
B1(+) ← B2(-)
Right

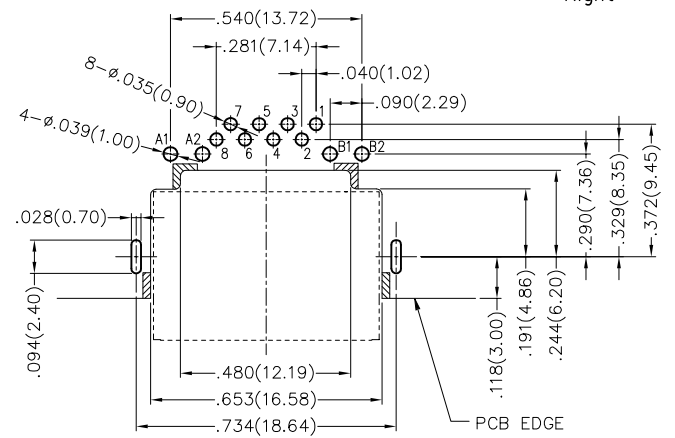

Recommended P.C.Board Layout

SPECIFICATIONS

Electrical
 Current Rating: 1.5A AC(rms)/DC
 Voltage Rating: 125V AC(rms)/DC
 Contact Resistance: 40 mΩ Max
 Insulation Resistance: 500 MΩ Min / DC 500V
 Withstanding Voltage: 1000V AC r.m.s
 Operating Temperature: -20°C~+75°C

Material and Plating
 Housing: PA10T (UL 94V-0), Black
 Contact: Phosphor Bronze/Selective gold on contact area, tin on tail
 Shell: Brass/Nickel Plated

Ordering Information

FRJ45 042 - 1 3 XX K6 K 7 1 A 0
 1 2 3 4 5 6 7 8 9 10

1 Category FRJ45-RJ45 Connector	2 Distinction No. 042	3 Ports options 1-1 Port	4 Plating 3-Selective gold in contact area, tin on tail	5 Thickness of plating 00-Gold flash 02-2μ" Custom plate available
6 Color-Resin K6-Black	7 Packaging K-Tray	8 LED style 7-L: Orange R: Green	9 Contact type 1-Square pin	10 Type A-Longer Pin L=2.0mm

 THIRD ANGLE PROJECTION	GENERAL TOLERANCES (UNLESS SPECIFIED)		APPROVE BY FRANK	DATE 28/SEP/22	PART NO. FRJ45042-13XXK6K71A0	ITEM NO. FRJ45042	 Leader Of Industry	
	X.±.012(0.30)	X.±5'	CHECKED BY CHERRY	DATE 28/SEP/22	TITLE RJ45 Connectors 8P8C 90°Angle			REV 0
DESIGN UNITS Inch (metric)	X.X±.008(0.20)	.X'±2"	DRAWN BY MATT	DATE 28/SEP/22	THIS DRAWING CONTAINS INFORMATION THAT IS PROPRIETARY TO TXGA INDUSTRIAL ELECTRONICS(S.Z)CO.,LTD AND SHOULD NOT BE USED WITHOUT WRITTEN PERMISSION			
SCALE 5:1	SIZE A4	X.XX±.006(0.15)						
		X.XXX±.004(0.10)						