

REV	LOCATIONS	DESCRIPTION	DATE	REVISER	APPD
1	▲	Structure change	26/APR/20	KATE	CHERRY



**SPECIFICATIONS**

**Electrical**  
 Current Rating: 1.5A AC(rms)/DC  
 Voltage Rating: 125V AC(rms)/DC  
 Contact Resistance: 30 mΩ Max  
 Insulation Resistance: 500 MΩ Min / DC 500V  
 Withstanding Voltage: 1000V AC r.m.s  
 Operating Temperature: -40°C~+85°C

**Mechanical**  
 Durability: 750 cycles Min.  
 Mating force: 2.2KG.F Max.  
 Retention force: 7.7KG.F between jack and plug

**Material and plating**  
 Housing: PA46 (UL 94V-0), Black  
 Contact: Phosphor Bronze/ Gold plated  
 Shell: Brass/ Nickel plated

**LED Specification**

Standard LED Color	LED Wavelength	Foward(A)	Foward(V)
Green	568nm	20mA	1.8-2.8V
Yellow	585nm	20mA	1.8-2.8V

**Ordering Information**

FRJ45 077 - 1 1 XX K6 K X 2 0 0  
 1 2 3 4 5 6 7 8 9

- 1 Category: FRJ45-RJ45 Connector
- 2 Distinction No.: 077
- 3 Ports options: 1-1 Port
- 4 Plating: 1-Gold Plated
- 5 Thickness of plating: 00-Gold flash, 03-3μ", Custom plate available
- 6 Color-Resin: K6-Black
- 7 Packaging: K-Tray
- 8 LED style: 1-L: Yellow R: Green, 2-L: Green R: Yellow
- 9 Contact type: 2-Round pin

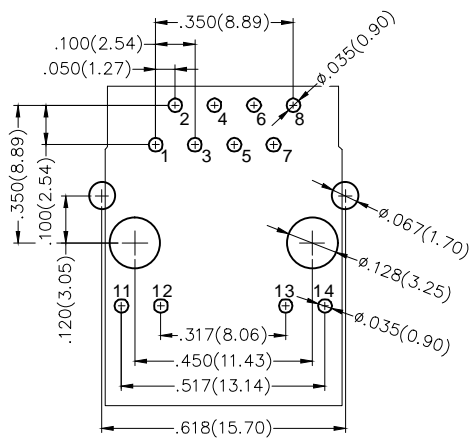
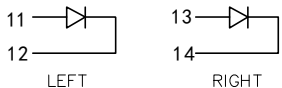
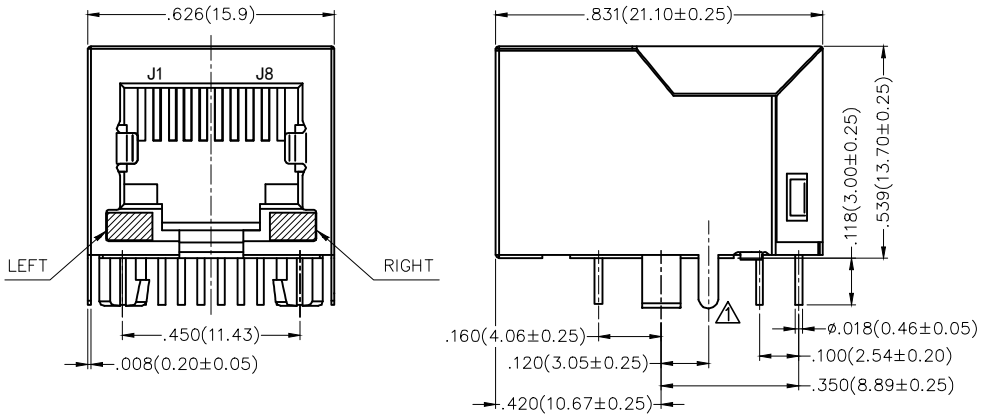

**Recommended P.C.Board Layout**  
 Tolerances: ±.002(0.05)

<p>THIRD ANGLE PROJECTION</p>	GENERAL TOLERANCES (UNLESS SPECIFIED) X.±.012(0.30) X.±5° X.X±.008(0.20) X.±2° X.XX±.006(0.15) X.X±1° X.XXX±.004(0.10) X.XX±0.5°		APPROVE BY FRANK	DATE 16/APR/17	PART NO. FRJ45077-11XXK6KX200	ITEM NO. FRJ45077	<p>Leader Of Industry</p>
	DESIGN UNITS Inch (metric)	CHECKED BY CHERRY	DATE 16/APR/17	TITLE RJ45 Connector 8P8C 90° Angle		REV 1	
SCALE 5:1	SIZE A4	DRAWN BY KATE	DATE 16/APR/17	THIS DRAWING CONTAINS INFORMATION THAT IS PROPRIETARY TO TXGA INDUSTRIAL ELECTRONICS(S.Z)CO.,LTD AND SHOULD NOT BE USED WITHOUT WRITTEN PERMISSION			