

REV	LOCATIONS	DESCRIPTION	DATE	REVISER	APPD
1	△	Update dimensions and LED Specification	17/MAR/25	MATT	LEO
2	△	Modify PIN code length	06/Feb/26	HJP	LEO

SPECIFICATIONS

Electrical

Current Rating: 1.5A AC(rms)/DC
Voltage Rating: 125V AC(rms)/DC
Contact Resistance: 30 mΩ Max
Insulation Resistance: 500 MΩ Min / DC 500V
Withstanding Voltage: 500V AC r.m.s
Operating Temperature: -40°C~+85°C

Material and plating

Housing: PBT (UL 94V-0), Black
Contact: Phosphor Bronze/ Selective gold in contact area, tin on tail
Shell: Brass/ Nickel plated

Ordering Information

FRJ45 090 - 4 3 XX K6 K X 1 0 2
1 2 3 4 5 6 7 8 9 10

1 <u>Category</u> FRJ45-RJ45 Connector	2 <u>Distinction No.</u> 090	3 <u>Ports options</u> 4-4 Ports	4 <u>Plating</u> 3-Selective gold in contact area, tin on tail	5 <u>Thickness of plating</u> 00-Gold flash 03-3μ" Custom plate available
6 <u>Color-Resin</u> K6-Black	7 <u>Packaging</u> K-Tray	8 <u>LED style</u> 1-L: Yellow R: Green 2-L: Green R: Yellow	9 <u>Contact type</u> 1-Square pin	10 <u>Pin circuits</u> 2-1000Base-T

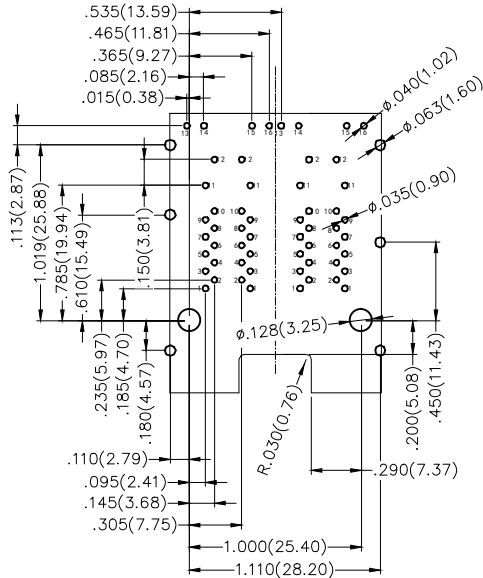
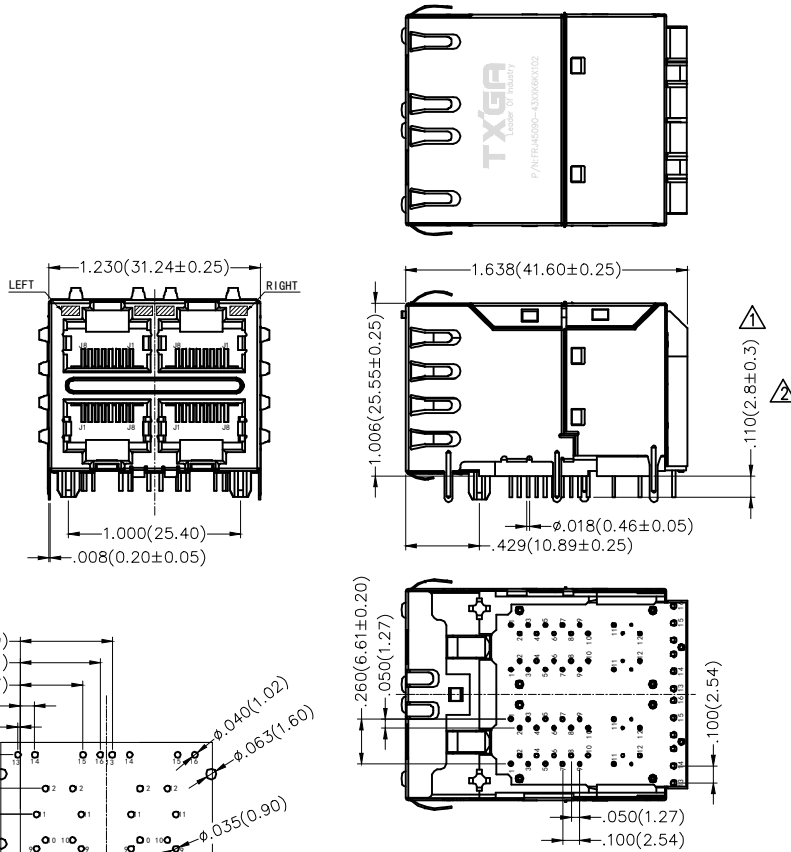

Recommended P.C.Board Layout
Tolerances: ±.002(0.05)

THIRD ANGLE PROJECTION	GENERAL TOLERANCES (UNLESS SPECIFIED)		APPROVE BY FRANK	DATE 16/APR/18	PART NO. FRJ45090-43XXK6KX102	ITEM NO. FRJ45090	
	X.±.012(0.30)	X.±5'	CHECKED BY CHERRY	DATE 16/APR/18	TITLE RJ45 Connector 10P8C 90° Angle (1000Base-T)		
DESIGN UNITS Inch (metric)	X.X±.008(0.20)	.X'±2'	DRAWN BY KATE	DATE 16/APR/18	THIS DRAWING CONTAINS INFORMATION THAT IS PROPRIETARY TO TXGA INDUSTRIAL ELECTRONICS(S.Z)CO.,LTD AND SHOULD NOT BE USED WITHOUT WRITTEN PERMISSION		REV 2
SCALE 5:1	SIZE A4	X.XX±.006(0.15)					SHEET NO. 1/2
		X.XXX±.004(0.10)					

REV	LOCATIONS	DESCRIPTION	DATE	REVISER	APPD

SCHEMATIC

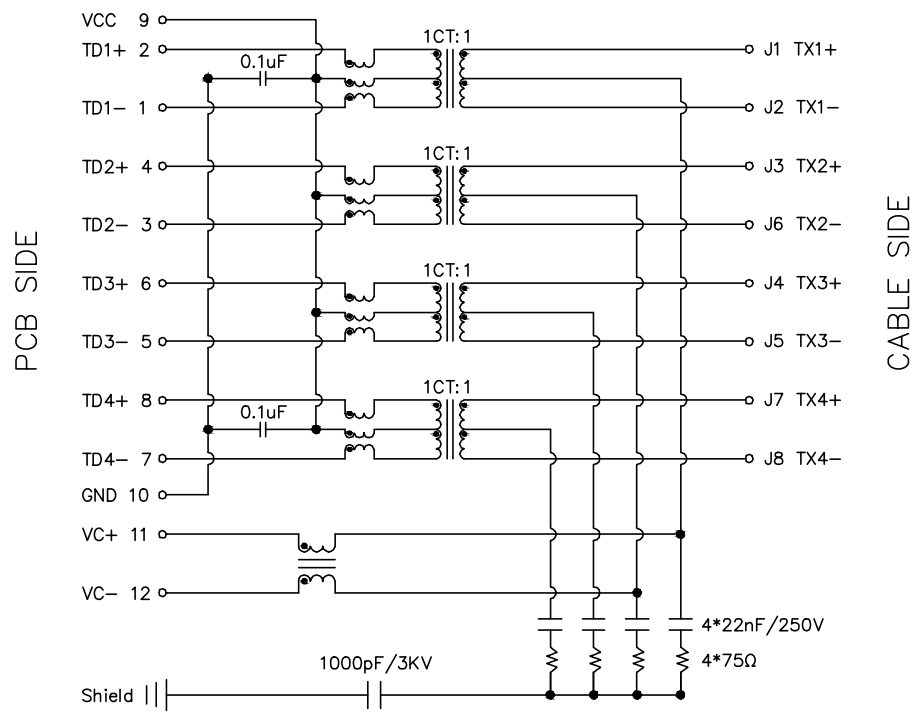

CABLE SIDE

Electrical Specifications

- Turn ratio: 2~1: J1~J2=1CT:1CT(±2%)
4~3: J3~J6=1CT:1CT(±2%)
6~5: J4~J5=1CT:1CT(±2%)
8~7: J7~J8=1CT:1CT(±2%)
- OCL: 350uH Min.@100KHz/100mV
RMS(4Channel) 15mA DC BIAS
- Insertion Loss: -1.0dB Max@1~100MHz
- Return loss: -20dB Min@1~10MHz
-16dB Min@10~30MHz
-12dB Min@30~60MHz
-10dB Min@60~80MHz
-8dB Min@80~100MHz
- Cross talk: -40dB Min@1~30MHz
-35dB Min@30~60MHz
-30dB Min@60~100MHz
- CMR: -30dB Min@1~100MHz
- Hi-Pot: 2250V DC 6S 1mA PRI TO SEC
- Single port magnetic jack POE magnetics acc. To IEEE802.3at for PSE or PD applications.
- 100% of production tested to comply with IEEE 802.3 isolation requirements balanced DC line current 720mA max. @57V DC continuous.

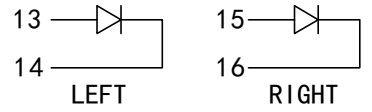

LED Specification

Standard LED Color	LED Wavelength	Foward(A)	Foward(V)
Green	565nm	20mA	2.2-2.4V
Yellow	585nm	20mA	2.1-2.5V

 THIRD ANGLE PROJECTION	GENERAL TOLERANCES (UNLESS SPECIFIED)		APPROVE BY	DATE	PART NO.	ITEM NO.	 Building Technology Cornerstone
	X.±.012(0.30)	X.±5'	FRANK	16/APR/18	FRJ45090-43XXK6KX102	FRJ45090	
DESIGN UNITS Inch (metric)	X.XX±.008(0.20)	.X'±2'	CHECKED BY	DATE	TITLE		REV 2
SCALE	X.XX±.006(0.15)	.XX'±1'	CHERRY	16/APR/18	RJ45 Connector 10P8C 90° Angle (1000Base-T)		
SIZE A4	X.XXX±.004(0.10)	.XXX'±0.5'	DRAWN BY	DATE	THIS DRAWING CONTAINS INFORMATION THAT IS PROPRIETARY TO TXGA INDUSTRIAL ELECTRONICS(S,Z)CO.,LTD AND SHOULD NOT BE USED WITHOUT WRITTEN PERMISSION		
5:1			KATE	16/APR/18			