

REV	LOCATIONS	DESCRIPTION	DATE	REVISER	APPD
1	△	Size changes	25/AUG/21	KATE	CHERRY
2	△	Update Structure	30/AUG/24	MATT	LEO

SPECIFICATIONS

Electrical

Current Rating: 1.5A AC(rms)/DC
Voltage Rating: 150V AC(rms)/DC
Contact Resistance: 40 mΩ Max
Insulation Resistance: 500 MΩ Min / DC 500V
Withstanding Voltage: 500V AC r.m.s
Operating Temperature: -40°C~+85°C

Mechanical

Durability: 750 cycles Min.

Material and plating

Housing: PBT (UL 94V-0), Black
Contact: Phosphor Bronze/ Selective gold on contact area, tin on tail
Shell: Brass/ Nickel plated

Ordering Information

FRJ45 093 — 1 3 XX K6 K 0 1 0 0
1 2 3 4 5 6 7 8

1	Category FRJ45-RJ45 Connector	2	Distinction No. 093	3	Ports options 1-1 Port	4	Plating 3-Selective gold on contact area, tin on tail
5	Thickness of plating 00-Gold flash 06-6μ" Custom plate available	6	Color-Resin K6-Black	7	Packaging K-Tray	8	Contact type 1-Square pin

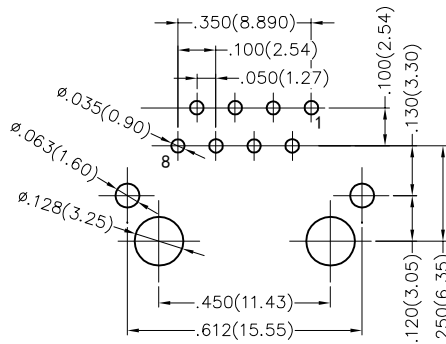
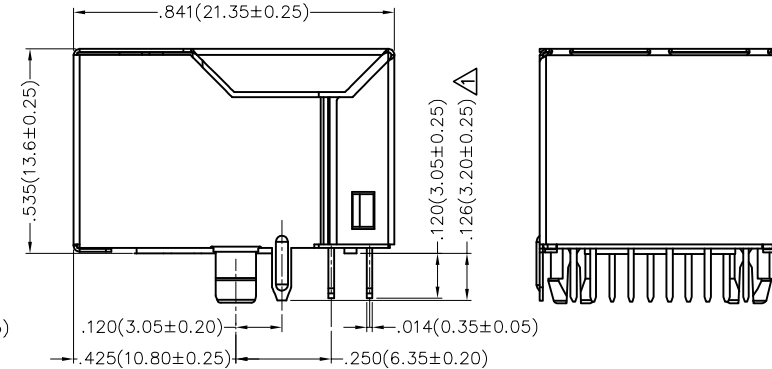

Recommended P.C.Board Layout

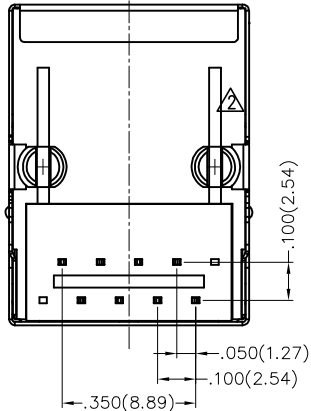
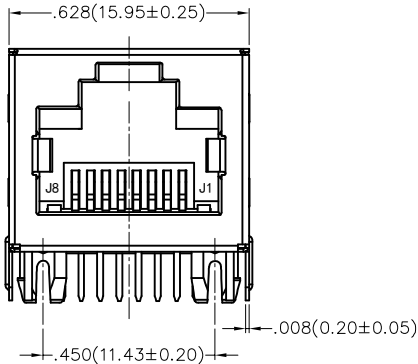
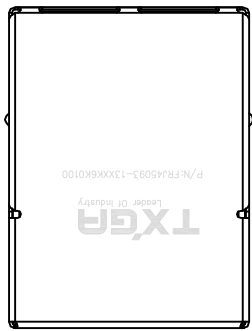

 THIRD ANGLE PROJECTION	GENERAL TOLERANCES (UNLESS SPECIFIED)		APPROVE BY FRANK	DATE 16/SEP/18	PART NO. FRJ45093-13XXK6K0100	ITEM NO. FRJ45093	 Building Technology Cornerstone
	X.±.012(0.30)	X.±5°	CHECKED BY CHERRY	DATE 16/SEP/18	TITLE RJ45 Connector 8P8C 90° Angle		
DESIGN UNITS Inch (metric)	X.X±.008(0.20)	.X'±2°	DRAWN BY KATE	DATE 16/SEP/18	THIS DRAWING CONTAINS INFORMATION THAT IS PROPRIETARY TO TXGA INDUSTRIAL ELECTRONICS(S.Z)CO.,LTD AND SHOULD NOT BE USED WITHOUT WRITTEN PERMISSION		
SCALE 5:1	SIZE A4	X.XX±.006(0.15)					
		X.XXX±.004(0.10)					