

REV	LOCATIONS	DESCRIPTION	DATE	REVISER	APPD

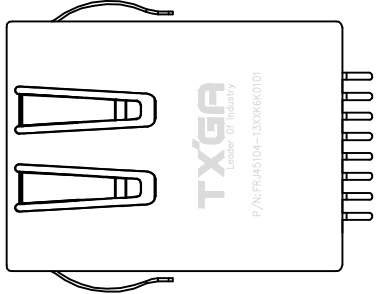

SPECIFICATIONS

Electrical
 Current Rating: 1.5A AC(rms)/DC
 Voltage Rating: 125V AC(rms)/DC
 Contact Resistance: 30 mΩ Max
 Insulation Resistance: 500 MΩ Min / DC 500V
 Withstanding Voltage: 500V AC r.m.s
 Operating Temperature: -40°C~+85°C

Material and plating
 Housing: PA46 (UL 94V-0), Black
 Contact: Phosphor Bronze/ Selective gold in contact area, tin on tail
 Shell: Brass/ Nickel plated

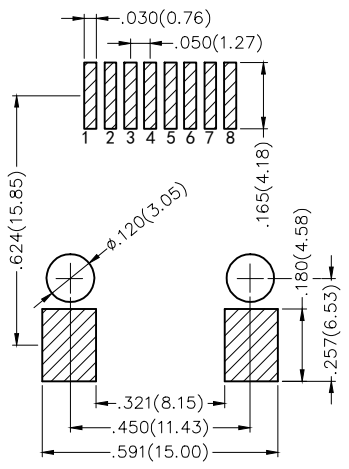
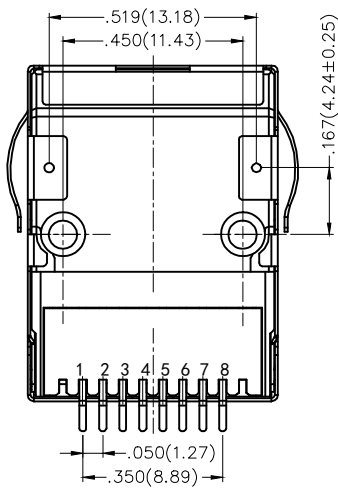
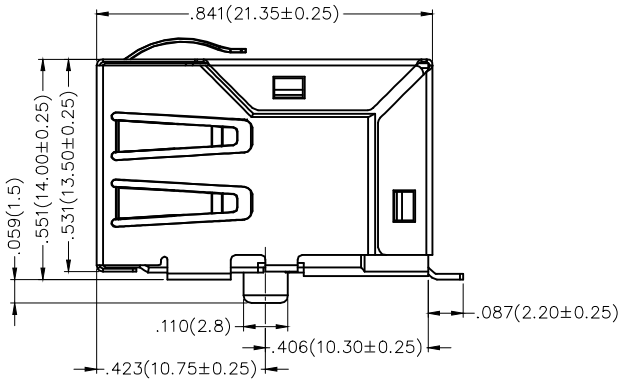
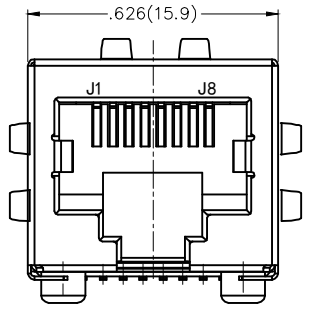

Recommended P.C.Board Layout

Ordering Information

FRJ45 104 — 1 3 XX K6 K 0 1 0 1
 1 2 3 4 5 6 7 8 9

1 Category FRJ45-RJ45 Connector	2 Distinction No. 104	3 Ports options 1-1 Port	4 Plating 3-Selective gold in contact area, tin on tail
5 Thickness of plating 00-Gold flash 06-6μ" 30-30μ" Custom plate available	6 Color-Resin K6-Black	7 Packaging K-Tray	8 Contact type 1-Square pin
			9 Pin circuits 1-100Base-T

<p>THIRD ANGLE PROJECTION</p>	GENERAL TOLERANCES (UNLESS SPECIFIED)		APPROVE BY FRANK	DATE 16/OCT/18	PART NO. FRJ45104-13XXK6K0101	ITEM NO. FRJ45104	<p>Leader Of Industry</p>	
	X.±.012(0.30)	X.±5'	CHECKED BY CHERRY	DATE 16/OCT/18	TITLE RJ45 Connector 8P8C 90° Angle (100Base-T)			REV 0
DESIGN UNITS Inch (metric)	X.X±.008(0.20)	X.±2'	DRAWN BY KATE	DATE 16/OCT/18	THIS DRAWING CONTAINS INFORMATION THAT IS PROPRIETARY TO TXGA INDUSTRIAL ELECTRONICS(S.Z)CO.,LTD AND SHOULD NOT BE USED WITHOUT WRITTEN PERMISSION			
SCALE 5:1	SIZE A4	X.XX±.006(0.15)						
		X.XXX±.004(0.10)						

REV	LOCATIONS	DESCRIPTION	DATE	REVISER	APPD

A
B
C
D
E
F

A
B
C
D
E
F

SCHEMATIC

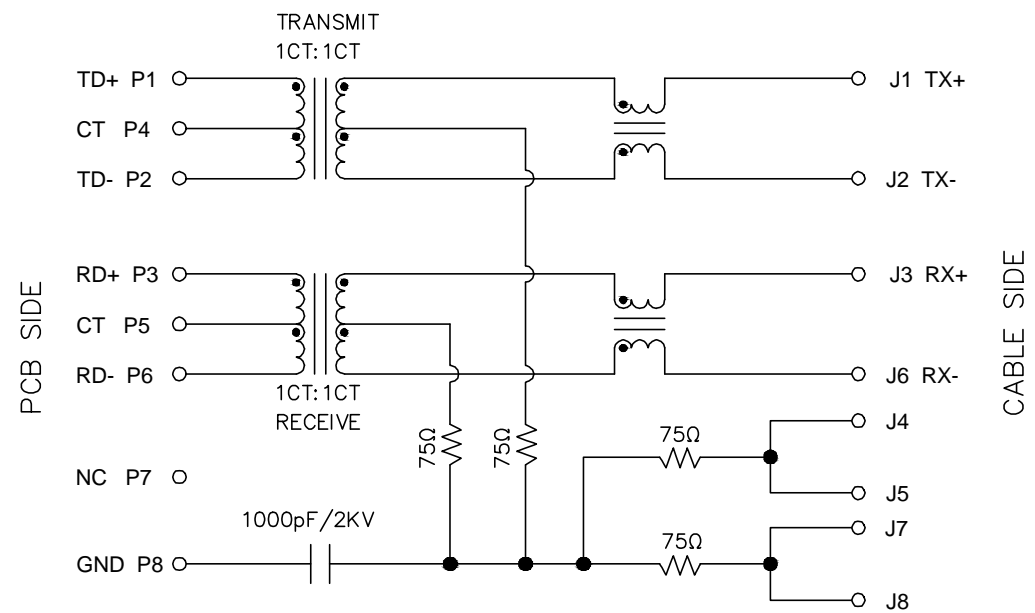

SPECIFICATIONS

- Turn ratio: 1~2: J1~J2=1CT:1CT (±2%)
3~6: J3~J6=1CT:1CT (±2%)
- Inductance(OCL):
350uH Min. @ 100KHz/100mV with 8mA DC bias
- Insertion Loss: -1.0dB Max. 1~100MHz.
- Return loss: -20dB Min. at 1~10MHz.
-16dB Min. at 10~30MHz.
-12dB Min. at 30~60MHz.
-10dB Min. at 60~80MHz.
- Cross talk: -40dB Min. at 1~30MHz.
-35dB Min. at 30~60MHz.
-30dB Min. at 60~100MHz.
- CMR: -30dB Min. at 1~100MHz.
- Hi-pot: 1500V AC & 2250V DC
6S 1mA PRI TO SEC

<p>THIRD ANGLE PROJECTION</p>	GENERAL TOLERANCES (UNLESS SPECIFIED)		APPROVE BY FRANK	DATE 16/OCT/18	PART NO. FRJ45104-13XXK6K0101	ITEM NO. FRJ45104	<p>Leader Of Industry</p>	
	DESIGN UNITS Inch (metric)	X.X±.012(0.30) X.X±.008(0.20)	X'±5' .X'±2'	CHECKED BY CHERRY	DATE 16/OCT/18	TITLE RJ45 Connector 8P8C 90° Angle (100Base-T)		
	SCALE 5:1	SIZE A4	X.XX±.006(0.15) X.XXX±.004(0.10)	DRAWN BY KATE	DATE 16/OCT/18	THIS DRAWING CONTAINS INFORMATION THAT IS PROPRIETARY TO TXGA INDUSTRIAL ELECTRONICS(S.Z)CO.,LTD AND SHOULD NOT BE USED WITHOUT WRITTEN PERMISSION		