

REV	LOCATIONS	DESCRIPTION	DATE	REVISER	APPD
1	Page 3	Add reel packaging specification	13/JUL/22	KATE	CHERRY

SPECIFICATIONS

Electrical

Current Rating: 1.5A AC(rms)/DC
Voltage Rating: 125V AC(rms)/DC
Contact Resistance: 30 mΩ Max
Insulation Resistance: 500 MΩ Min / DC 500V
Withstanding Voltage: 1000V AC r.m.s
Operating Temperature: -40°C~+85°C

Mechanical

Durability: 750 cycles Min.
Insertion force: 23 N Max.

Material and plating

Housing: LCP (UL 94V-0), Black
Contact: Phosphor Bronze/ Selective gold on contact area, matte tin on tail
Shell: Brass T=0.20mm/ Nickel plated

Ordering Information

FRJ45 173 — 1 3 XX BK X 0 1 0 2
1 2 3 4 5 6 7 8 9

1	Category FRJ45-RJ45 Connector	2	Distinction No. 173	3	Ports options 1-1 Port	4	Plating 3-Selective gold on contact area, tin on tail
5	Thickness of plating 00-Gold flash 06-6 μ" Custom plate available	6	Color-Resin BK-Black	7	Packaging K-Tray M-Reel	8	Contact type 1-Square pin
						8	Pin circuits 2-1000Base-T

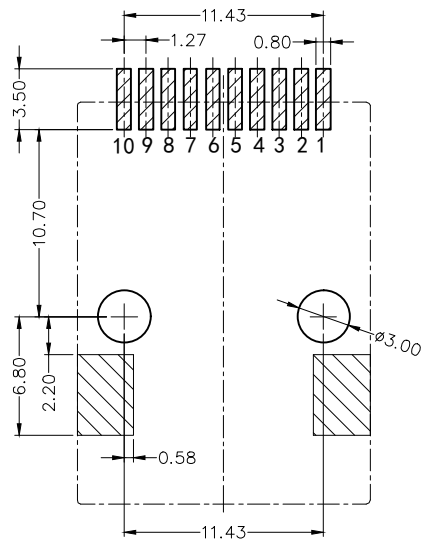
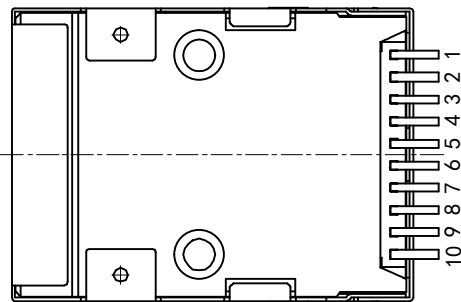
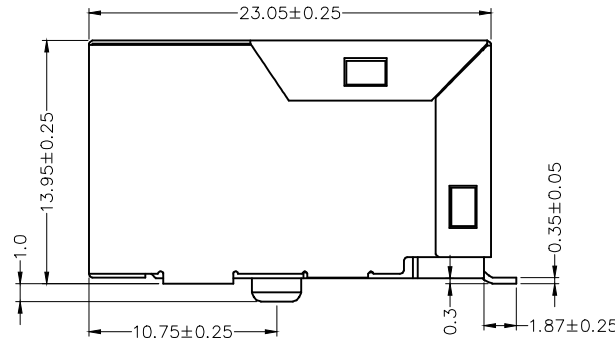
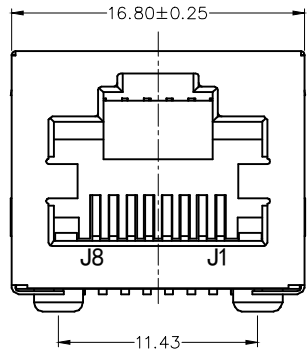

Recommended P.C.Board Layout
Tolerances: ±0.05

 THIRD ANGLE PROJECTION	GENERAL TOLERANCES (UNLESS SPECIFIED)		APPROVE BY FRANK	DATE 20/AUG/21	PART NO. FRJ45173-13XXBKX0102	ITEM NO. FRJ45173	 Leader Of Industry	
	X. ±0.30	X.° ±5°	CHECKED BY CHERRY	DATE 20/AUG/21	TITLE RJ45 Connector 10P8C 90° Angle			REV 1
DESIGN UNITS Metric	X.X ±0.20	X.X° ±2°	DRAWN BY KATE	DATE 20/AUG/21	THIS DRAWING CONTAINS INFORMATION THAT IS PROPRIETARY TO TXGA INDUSTRIAL ELECTRONICS(S.Z)CO.,LTD AND SHOULD NOT BE USED WITHOUT WRITTEN PERMISSION			
SCALE 5:1	SIZE A4	X.XX ±0.15						
		X.XXX ±0.10						

REV	LOCATIONS	DESCRIPTION	DATE	REVISER	APPD

Electrical Specifications

- Turn ratio: 2~3: J1~J2=1CT:1CT(±5%)
4~7: J3~J6=1CT:1CT(±5%)
5~6: J4~J5=1CT:1CT(±5%)
8~9: J7~J8=1CT:1CT(±5%)
- OCL: 350uH Min. at 100KHz 100mV 8mA DC
- Insertion loss: -1.0dB Max. 1MHz~100MHz
-1.2dB Max. 100MHz~125MHz
- Return loss: -16dB Min. 1MHz~40MHz
-12dB Min. 40MHz~60MHz
-10dB Min. 60MHz~80MHz
-8dB Min. 80MHz~100MHz
- Cross talk: -30dB Min. 1MHz~100MHz
- CMR: -30dB Min. 1MHz~100MHz
- Hi-Pot: 2250V DC 6S 1mA PRI TO SEC

SCHEMATIC

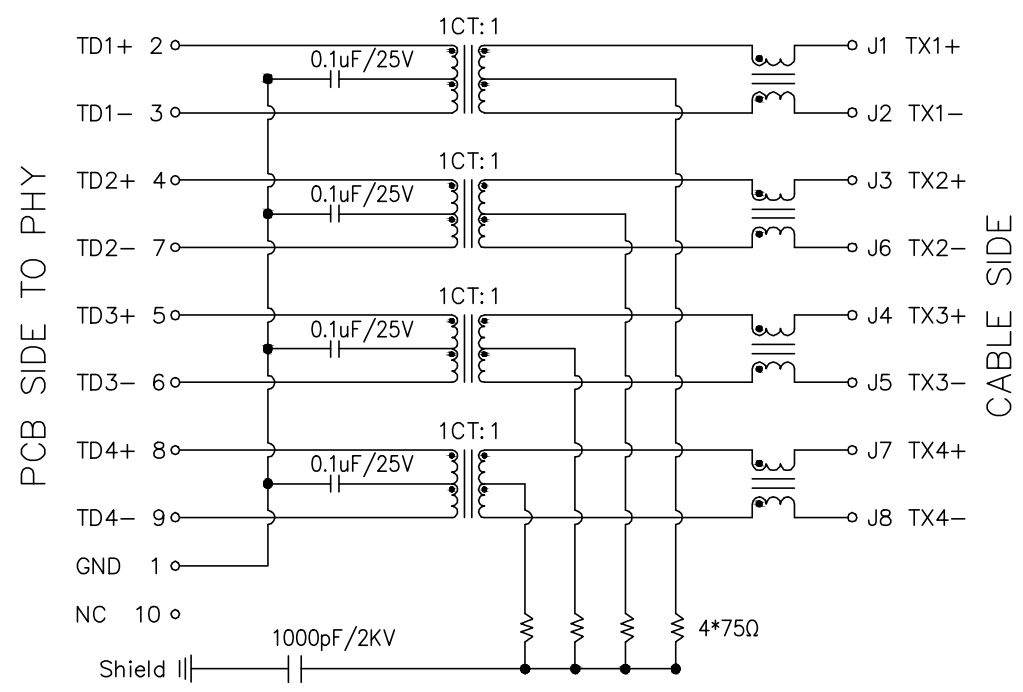

<p>THIRD ANGLE PROJECTION</p>	GENERAL TOLERANCES (UNLESS SPECIFIED)		APPROVE BY	DATE	PART NO.	ITEM NO.	<p>Leader Of Industry</p>
	X. ±0.30	X.* ±5°	FRANK	20/AUG/21	FRJ45173-13XXBKX0102	FRJ45173	
	X.X ±0.20	X.X* ±2°	CHECKED BY	DATE	TITLE		
	X.XX ±0.15	X.XX* ±1°	CHERRY	20/AUG/21	RJ45 Connector 10P8C 90° Angle		
SCALE	SIZE	X.XXX ±0.10	X.XXX* ±0.5°	DRAWN BY	DATE	THIS DRAWING CONTAINS INFORMATION THAT IS PROPRIETARY TO TXGA INDUSTRIAL ELECTRONICS(S.Z)CO.,LTD AND SHOULD NOT BE USED WITHOUT WRITTEN PERMISSION	
5:1	A4			KATE	20/AUG/21	REV 1	SHEET NO. 2/3

REV	LOCATIONS	DESCRIPTION	DATE	REVISER	APPD

Note:

- 10 sprocket hole cumulative tolerance ± 0.2
- Carrier camber is within 1.0mm in 250mm
- Material: Black conductive polystyrene Alloy 100% recyclable
- All dimensions meet EIA-481-D requirements
- Peel off force of cover tape & carrier tape: 20g~130g (0.2N~1.3N)
- Component load per 13" reel: 100 pcs

A
B
C
D
E
F

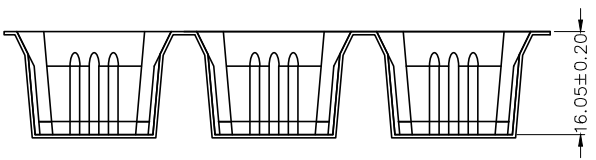
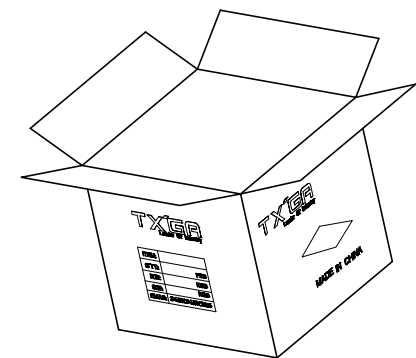
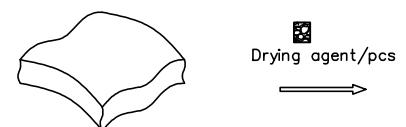
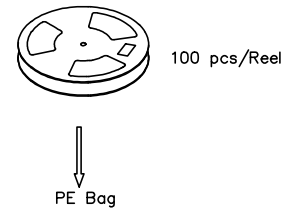
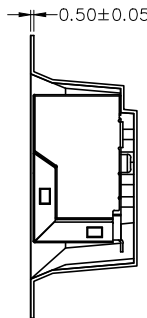
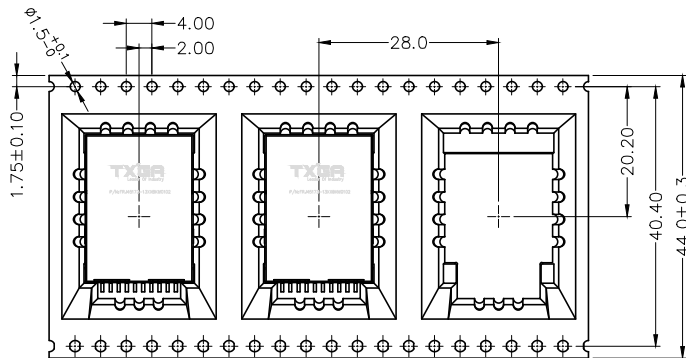
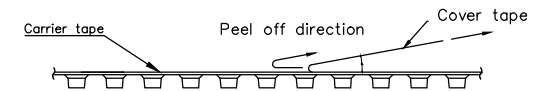
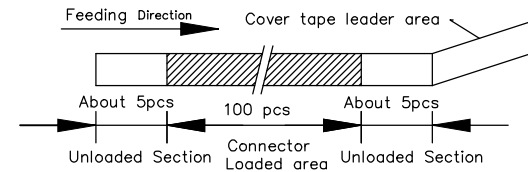
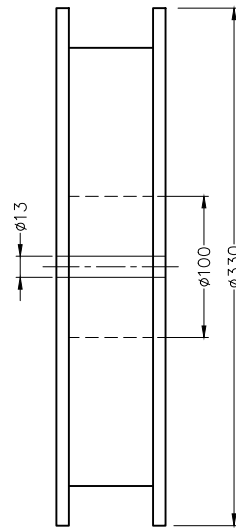
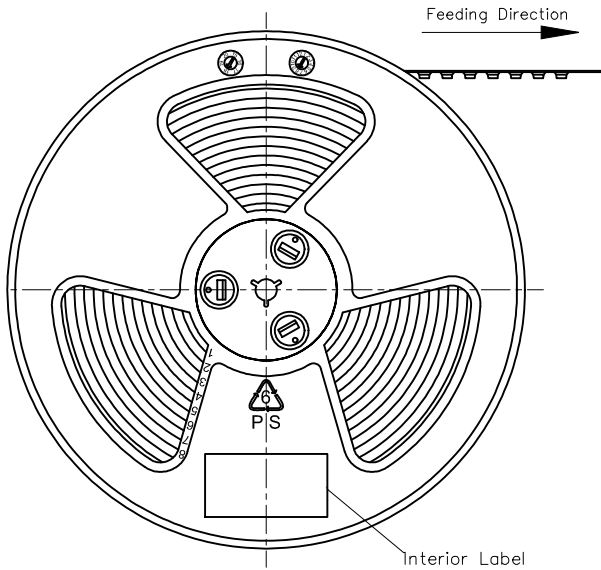

 THIRD ANGLE PROJECTION	GENERAL TOLERANCES (UNLESS SPECIFIED)		APPROVE BY FRANK	DATE 20/AUG/21	PART NO. FRJ45173-13XXBKM0102	ITEM NO. FRJ45173	 Leader Of Industry	
	X. ± 0.30	X.* $\pm 5^\circ$	CHECKED BY CHERRY	DATE 20/AUG/21	TITLE RJ45 Connector 10P8C 90° Angle			
DESIGN UNITS Metric	X.X ± 0.20	X.X* $\pm 2^\circ$	DRAWN BY KATE	DATE 20/AUG/21	THIS DRAWING CONTAINS INFORMATION THAT IS PROPRIETARY TO TXGA INDUSTRIAL ELECTRONICS(S.Z)CO.,LTD AND SHOULD NOT BE USED WITHOUT WRITTEN PERMISSION		REV 1	SHEET NO. 3/3
SCALE 5:1	SIZE A4	X.XX ± 0.15	X.XX* $\pm 1^\circ$					
		X.XXX ± 0.10	X.XXX* $\pm 0.5^\circ$					

1 2 3 4 5 6 7 8