

REV	LOCATIONS	DESCRIPTION	DATE	REVISER	APPD

**SPECIFICATIONS**

**Electrical**  
 Current Rating: 1.5A AC(rms)/DC  
 Voltage Rating: 125V AC(rms)/DC  
 Contact Resistance: 50 mΩ Max  
 Insulation Resistance: 500 MΩ Min / DC 500V  
 Withstanding Voltage: 1000V AC r.m.s  
 Operating Temperature: -20°C~+85°C

**Material and plating**  
 Housing: Thermoplastic (UL 94V-0), Black  
 Contact: Phosphor Bronze/ Gold plated

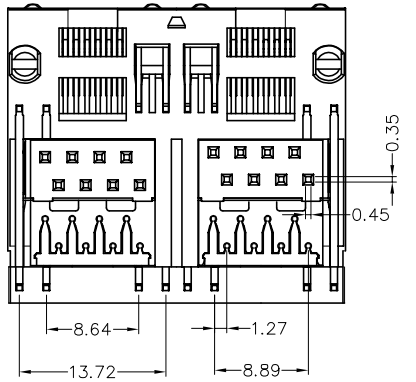
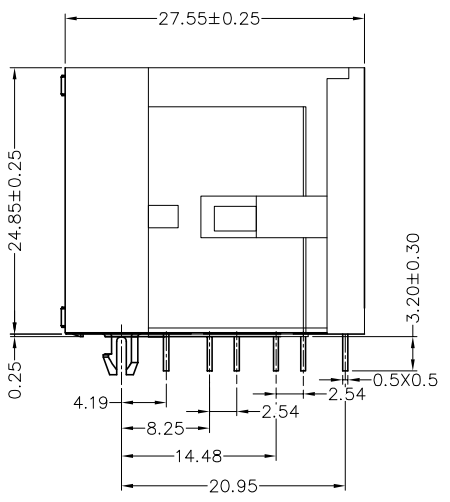
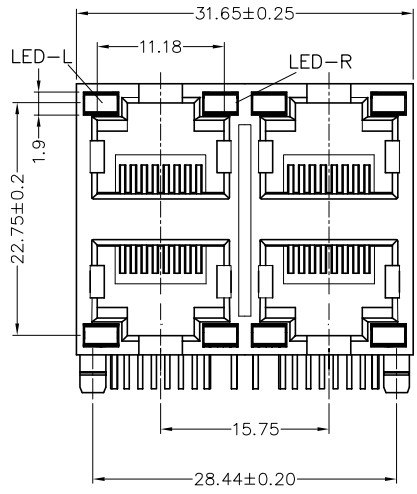

**Ordering Information**

FRJ45 185 - 4 1 XX BK K X 1 0 0  
 1 2 3 4 5 6 7 8 9

1 Category FRJ45-RJ45 Connector	2 Distinction No. 185	3 Ports options 4-4 Ports	4 Plating 1-Gold Plated	5 Thickness of plating 00-Gold flash 02-2μ" Custom plate available
6 Color-Resin BK-Black	7 Packaging K-Tray	8 LED style 1-L: Yellow R: Green 2-L: Green R: Yellow	9 Contact type 1-Square pin	

<p>THIRD ANGLE PROJECTION</p>	GENERAL TOLERANCES (UNLESS SPECIFIED)		APPROVE BY FRANK	DATE 31/MAY/22	PART NO. FRJ45185-41XXBKXX100	ITEM NO. FRJ45185	<p>Leader Of Industry</p>	
	X.±0.30	X.±5°	CHECKED BY CHERRY	DATE 31/MAY/22	TITLE RJ45 Connector 8P8C 90° Angle			REV 0
DESIGN UNITS Metric	X.X±0.20	.X'±2°	DRAWN BY STAR	DATE 31/MAY/22	THIS DRAWING CONTAINS INFORMATION THAT IS PROPRIETARY TO TXGA INDUSTRIAL ELECTRONICS(S.Z)CO.,LTD AND SHOULD NOT BE USED WITHOUT WRITTEN PERMISSION			
SCALE 5:1	SIZE A4	X.XX±0.15	.XX'±1°					
		X.XXX±0.10	.XXX'±0.5°					

REV	LOCATIONS	DESCRIPTION	DATE	REVISER	APPD

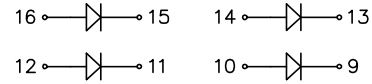
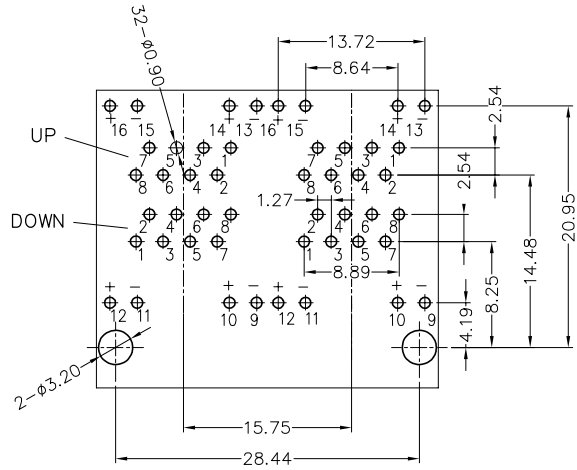

LED Style

Recommended P.C.Board Layout

 THIRD ANGLE PROJECTION	GENERAL TOLERANCES (UNLESS SPECIFIED)		APPROVE BY FRANK	DATE 31/MAY/22	PART NO. FRJ45185-41XXBKKX100	ITEM NO. FRJ45185	 Leader Of Industry
	DESIGN UNITS Metric	X.±0.30	X.±5'	CHECKED BY CHERRY	DATE 31/MAY/22	TITLE RJ45 Connector 8P8C 90° Angle	
SCALE 5:1	SIZE A4	X.XX±0.15	.XX'±1"	DRAWN BY STAR	DATE 31/MAY/22	THIS DRAWING CONTAINS INFORMATION THAT IS PROPRIETARY TO TXGA INDUSTRIAL ELECTRONICS(S.Z)CO.,LTD AND SHOULD NOT BE USED WITHOUT WRITTEN PERMISSION	
		X.XXX±0.10	.XXX'±0.5'			REV 0	SHEET NO. 2/2