

1 2 3 4 5 6 7 8

REV	LOCATIONS	DESCRIPTION	DATE	REVISER	APPD

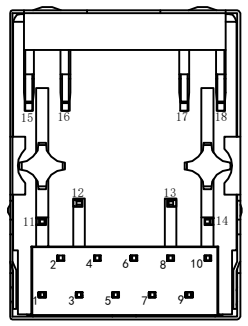
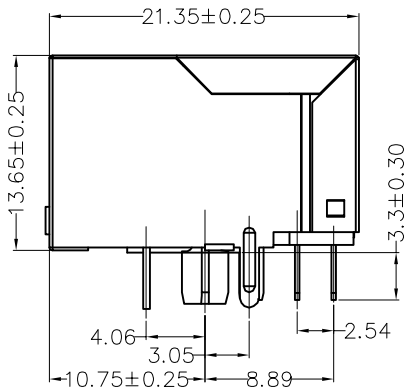
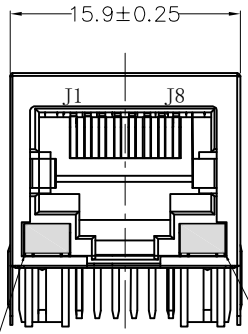

SPECIFICATIONS

Electrical
 Current Rating: 1.5A AC(rms)/DC
 Voltage Rating: 125V AC(rms)/DC
 Contact Resistance: 30 mΩ Max
 Insulation Resistance: 500 MΩ Min
 Withstanding Voltage: 1000V AC r.m.s

Mechanical
 Durability: 750 Cycles Min
 Mating Force: 23N Max
 Operating Temperature: -40°C~+85°C

Material and plating
 Housing: PA66(UL 94V-0),Black
 Terminals Bracket:PBT(UL 94V-0),Black
 Contacts:Phosphor Bronze/Selective gold on contact area, tin on tail
 Shell:Copper Alloy/Nickel Plated

Ordering Information

FRJ45 205 — 1 3 XX BK K X 1 0 2
 1 2 3 4 5 6 7 8 9 10

1 Category FRJ45-RJ45 Connector	2 Distinction No. 205	3 Ports options 1-1 Port	4 Plating 3-Selective gold on contact area, tin on tail	5 Thickness of plating 06-6μ" Custom plate available
6 Color-Resin BK-Black	7 Packaging K-Tray	8 LED style 1-L: Yellow R: Green 2-L: Green R: Yellow	9 Contact type 1-Square pin	10 Pin circuits 2-1000Base-T

 THIRD ANGLE PROJECTION DESIGN UNITS METRIC(mm) SCALE 5:1 SIZE A4	GENERAL TOLERANCES (UNLESS SPECIFIED)		APPROVE BY LEO	DATE 30/JAN/22	PART NO. FRJ45205-13XXBKX102	ITEM NO. FRJ45205	 Building Technology Cornerstone	
	X. ±0.30	X.° ±5°	CHECKED BY GISELLE	DATE 30/JAN/22	TITLE RJ45 Connector 14P8C 90°Angle(1000Base-T)POE+			REV 0
	X.X ±0.20	X.X° ±2°	DRAWN BY MATT	DATE 30/JAN/22	THIS DRAWING CONTAINS INFORMATION THAT IS PROPRIETARY TO TXGA INDUSTRIAL ELECTRONICS(S.Z)CO.,LTD AND SHOULD NOT BE USED WITHOUT WRITTEN PERMISSION			
	X.XX ±0.15	X.XX° ±1°						
X.XXX ±0.10	X.XXX° ±0.5°							

1 2 3 4 5 6 7 8

REV	LOCATIONS	DESCRIPTION	DATE	REVISER	APPD

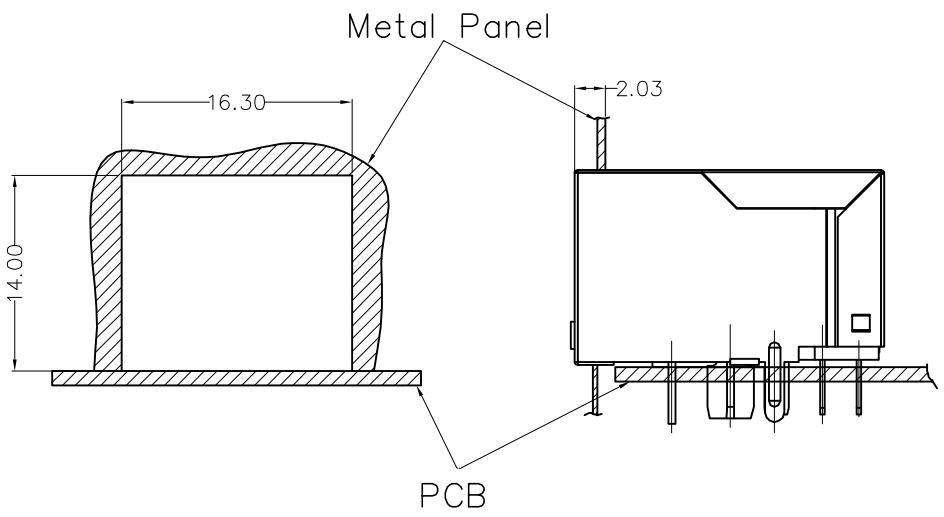

Recommended Panel cutout

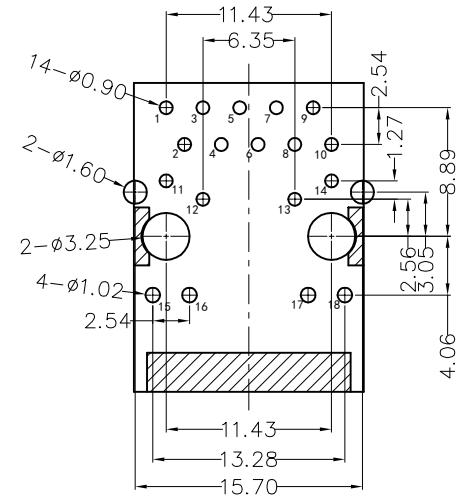

Recommended P.C.Board Layout
General tolerances $\pm 0.05\text{mm}$

 THIRD ANGLE PROJECTION	GENERAL TOLERANCES (UNLESS SPECIFIED)		APPROVE BY	DATE	PART NO.	ITEM NO.	 Building Technology Cornerstone
	X. ± 0.30	X.* $\pm 5^\circ$	LEO	30/JAN/22	FRJ45205-13XXBKKX102	FRJ45205	
	X.X ± 0.20	X.X* $\pm 2^\circ$	CHECKED BY	DATE	TITLE		
	X.XX ± 0.15	X.XX* $\pm 1^\circ$	GISELLE	30/JAN/22	RJ45 Connector 14P8C 90°Angle(1000Base-T)POE+	REV 0	
SCALE	SIZE	X.XXX ± 0.10	X.XXX* $\pm 0.5^\circ$	DRAWN BY	DATE	THIS DRAWING CONTAINS INFORMATION THAT IS PROPRIETARY TO TXGA INDUSTRIAL ELECTRONICS(S.Z)CO.,LTD AND SHOULD NOT BE USED WITHOUT WRITTEN PERMISSION	
5:1	A4			MATT	30/JAN/22		

REV	LOCATIONS	DESCRIPTION	DATE	REVISER	APPD

A

B

C

D

E

F

PCB SIDE TO PHY

CABLE SIDE

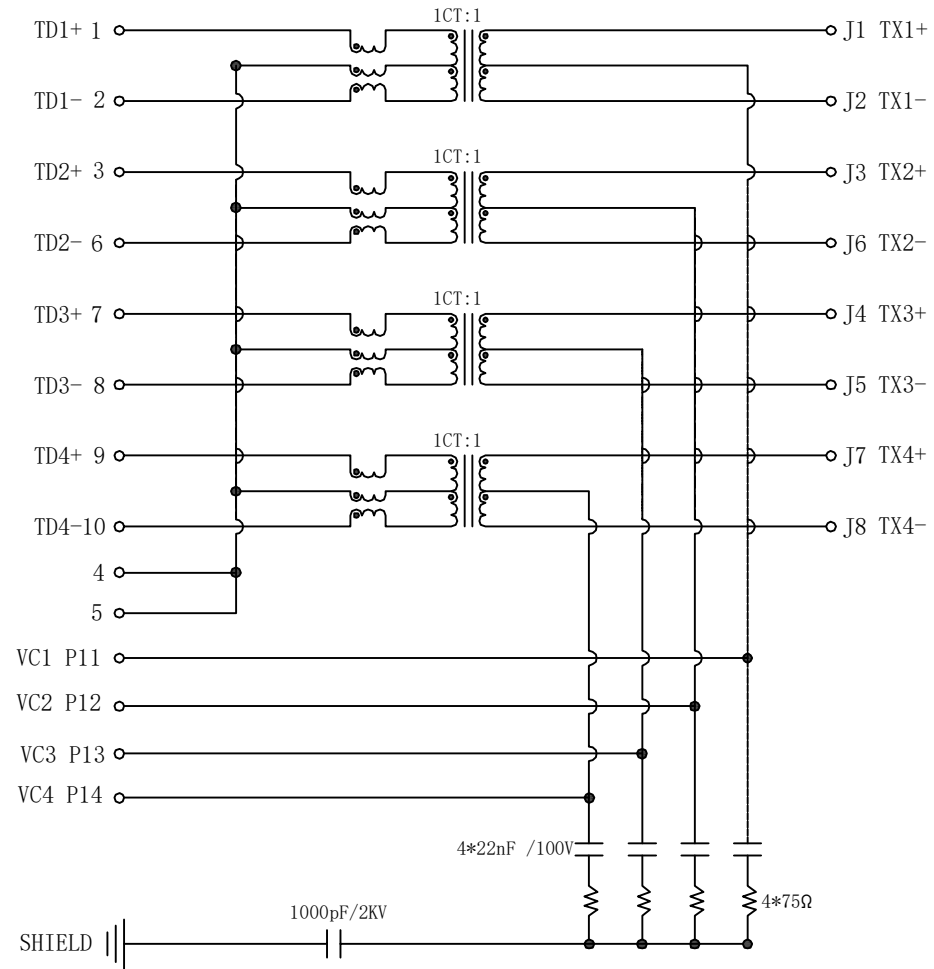

Electrical Specifications

- Turn ratio: TX & Rx= 1:1±2%
- OCL: 350uH Min. at 100KHz 100mV 8mA DC
- Insertion loss: -1.0dB Max. 1MHz~100MHz
- Return loss: -18dB Min. 1MHz~30MHz
-14dB Min. 30MHz~60MHz
-12dB Min. 60MHz~80MHz
-10dB Min. 80MHz~100MHz
- Cross talk: -40dB Min. 1MHz~30MHz
-35dB Min. 30MHz~60MHz
-30dB Min. 60MHz~100MHz
- CMR: -30dB Min. 1MHz~100MHz
- Hi-Pot: 2250V DC 1mA 1Sec
- Single port magnetic jack POE magnetics acc. To IEEE802.3at for PSE or PD applications.
- 100% of production tested to comply with IEEE 802.3 isolation equipments balanced DC line current 600mA max. 57V DC continuous.

Standard LED Color	LED Wavelength	Foward(A)	Foward(V)
Green	568nm	20mA	1.85-2.45V
Yellow	585nm	20mA	1.7-2.2V

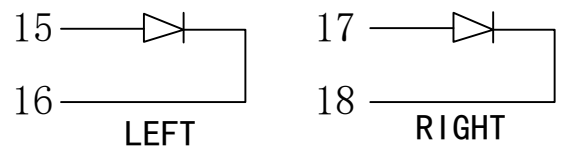

<p>THIRD ANGLE PROJECTION</p>	GENERAL TOLERANCES (UNLESS SPECIFIED)		APPROVE BY	DATE	PART NO.	ITEM NO.	<p>Building Technology Cornerstone</p>
	X. ±0.30	X.* ±5°	LEO	30/JAN/22	FRJ45205-13XXBKKX102	FRJ45205	
	X.X ±0.20	X.X* ±2°	CHECKED BY	DATE	TITLE		
	X.XX ±0.15	X.XX* ±1°	GISELLE	30/JAN/22	RJ45 Connector 14P8C 90°Angle(1000Base-T)POE+	REV 0	
SCALE	SIZE	X.XXX ±0.10	X.XXX* ±0.5°	DRAWN BY	DATE	THIS DRAWING CONTAINS INFORMATION THAT IS PROPRIETARY TO TXGA INDUSTRIAL ELECTRONICS(S.Z)CO.,LTD AND SHOULD NOT BE USED WITHOUT WRITTEN PERMISSION	
5:1	A4			MATT	30/JAN/22		