

REV	LOCATIONS	DESCRIPTION	DATE	REVISER	APPD

SPECIFICATION

Electrical Performance

Current Rating: 1.5A AC(rms)/DC
 Voltage Rating: 125V AC(rms)/DC
 Contact Resistance: 30mΩ Max
 Insulation Resistance: 500MΩ MIN
 Withstanding Voltage: 1000V AC r.m.s
 Temperature Range—Operating: -40°C~+85°C

Material and Plating

Housing: PBT, (UL 94V-0)
 Terminal: Copper alloy/Selective gold plated on contact area and matte tin plated on tails area
 Shield: Copper alloy/Nickel plating

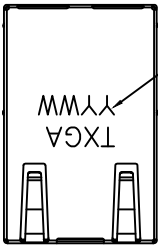

Date Code

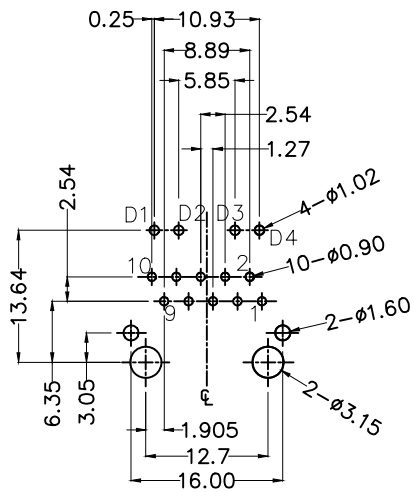

Recommended P.C.Board Layout
 General tolerances: ±0.05

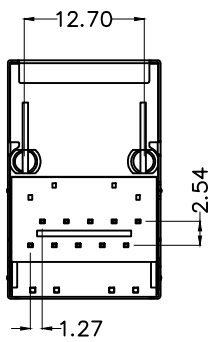
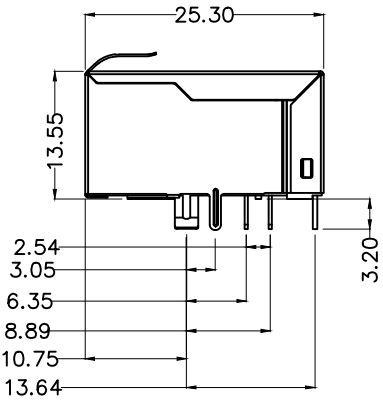
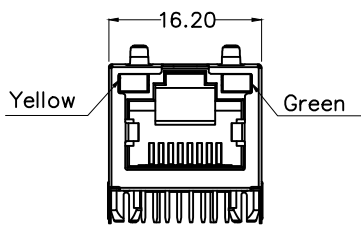

Ordering Information

FRJ45 230 - 1 7 XX BK K 1 1 0 2
 1 2 3 4 5 6 7 8 9 10

1	Category FRJ45-RJ45 Connector	2	Distinction No. 230	3	Ports options 1-1 Ports	4	Plating 7-Selective gold plated on contact area and matte tin plated on tails area	5	thickness of Gold Plating 06-6u"
6	Color-Resin BK-Black	7	Packaging K-Tray	8	LED style 1-L: Yellow R: Green	9	Contact type 1-Square pin	10	Pin circuits 2-1000Base-T

<p>THIRD ANGLE PROJECTION</p>	<p>GENERAL TOLERANCES (UNLESS SPECIFIED)</p>		<p>APPROVE BY LEO</p>	<p>DATE 19/Sept/23</p>	<p>PART NO. FRJ45230-17XXBKK1102</p>	<p>ITEM NO. FRJ45230</p>	<p>Building Technology Cornerstone</p>
	<p>X. ±0.30</p>	<p>X.* ±5*</p>	<p>CHECKED BY GISELLE</p>	<p>DATE 19/Sept/23</p>	<p>TITLE RJ45 Connector 10P8C 90°Angle(1000Base-T)</p>		
<p>DESIGN UNITS METRIC(mm)</p>	<p>X.X ±0.20</p>	<p>X.X* ±2*</p>	<p>DRAWN BY Hejianpeng</p>	<p>DATE 19/Sept/23</p>	<p>THIS DRAWING CONTAINS INFORMATION THAT IS PROPRIETARY TO TXGA INDUSTRIAL ELECTRONICS(S.Z)CO.,LTD AND SHOULD NOT BE USED WITHOUT WRITTEN PERMISSION</p>		
<p>SCALE 5:1</p>	<p>SIZE A4</p>	<p>X.XX ±0.15</p>	<p>X.XX* ±1*</p>	<p>X.XXX ±0.10</p>	<p>X.XXX* ±0.5*</p>		

REV	LOCATIONS	DESCRIPTION	DATE	REVISER	APPD

Connector Solder Side

RJ45 Contact Side

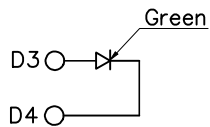
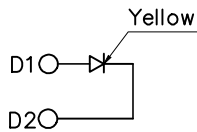
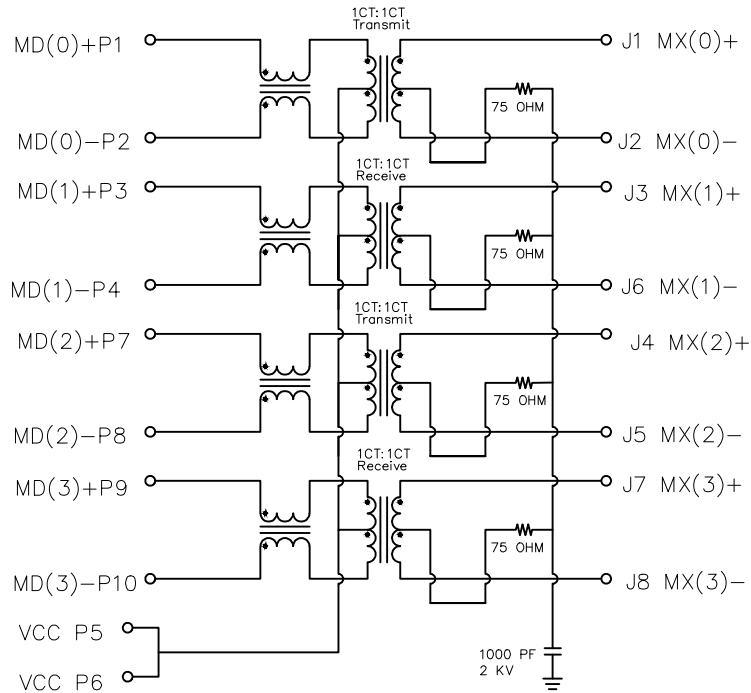

Electrical;
 Turn ratio:Input to output=1:1±3%
 LX: 350uH Min.at 100KHz 100mV 8mA DC.
 DCR:1.2 OHMS Maximum
 Insertion Loss: -1.0 dB Max 0.3~100MHz.
 Return loss: -20dB Min 1~30MHz;
 -15dB Min 30~60MHz.
 -10dB Min 60~80MHz.
 Cross talk: -30dB Min 1~100MHz;
 CMR: -30dB Min 1~100MHz;
 HIPOT:input to output=1500VAC For 60 seconds

<p>THIRD ANGLE PROJECTION</p>	GENERAL TOLERANCES (UNLESS SPECIFIED)		APPROVE BY	DATE	PART NO.	ITEM NO.	<p>Building Technology Cornerstone</p>
	X. ±0.30	X.* ±5°	LEO	19/Sept/23	FRJ45230-17XXBKK1102	FRJ45230	
	DESIGN UNITS METRIC(mm)		CHECKED BY	DATE	TITLE		REV 0
	X.X ±0.20	X.X* ±2°	GISELLE	19/Sept/23	RJ45 Connector 10P8C 90°Angle(1000Base-T)		SHEET NO. 2/2
SCALE 5:1	SIZE A4	X.XX ±0.15	X.XX* ±1°	DRAWN BY	DATE	THIS DRAWING CONTAINS INFORMATION THAT IS PROPRIETARY TO TXGA INDUSTRIAL ELECTRONICS(S.Z)CO.,LTD AND SHOULD NOT BE USED WITHOUT WRITTEN PERMISSION	
		X.XXX ±0.10	X.XXX* ±0.5°	Hejianpeng	19/Sept/23		