

Round Panel

REV	LOCATIONS	DESCRIPTION	DATE	REVISER	APPD

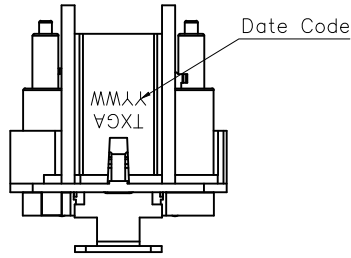

SPECIFICATION

Electrical

Current Rating: 1.5A AC(rms)/DC  
 Voltage Rating: 50V AC(rms)/DC  
 Contact Resistance: 10 mΩ Max  
 Insulation Resistance: 500 MΩ MIN  
 Withstanding Voltage: 1000V AC r.m.s  
 Temperature Range-Operating: -30°C~+80°C  
 Frequency Range: 1-100MHz

Material

Housing: PA66, (UL 94V-0) Black  
 Panel: PA66, (UL 94V-0) Black (Round Panel)  
 PA66, (UL 94V-0) Black (Square Panel)  
 Back cover: LCP, (UL 94V-0) Black  
 Terminal: Copper alloy/Selective gold plated on contact area and matte tin plated on tails area  
 Handle: SUS/Nickel plating  
 Spring steel: Mn Steel/Nickel plating  
 Internal contact spring: Copper alloy/Nickel plating

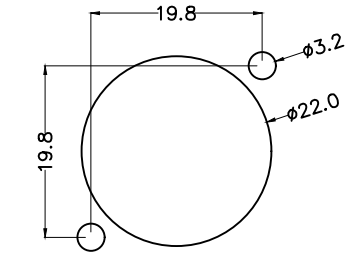
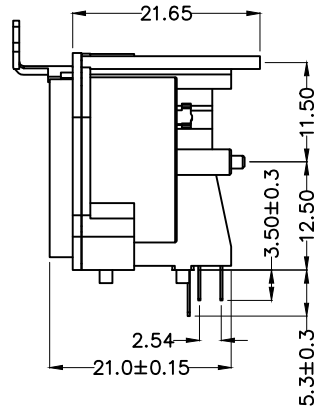
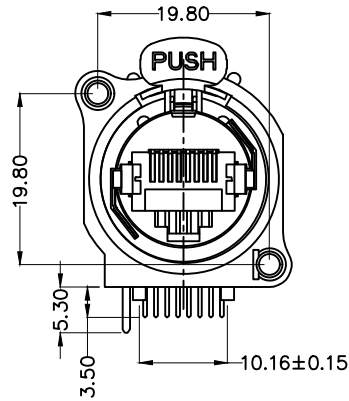

Panel cut out (rear side)

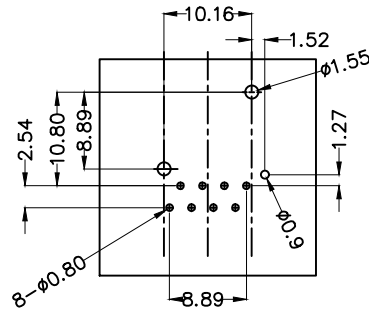
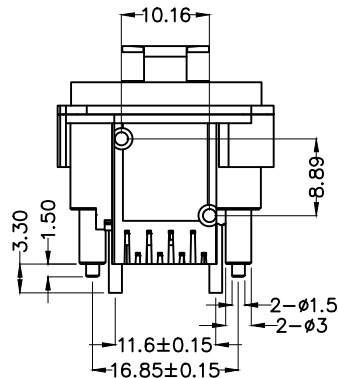

Recommended P.C. Board Layout  
 General tolerances: ±0.05

Ordering Information

FRJ45 232 - 1 7 XX BK K 0 1 X 0  
 1 2 3 4 5 6 7 8 9

1	Category FRJ45-RJ45 Connector	2	Distinction No. 232	3	Ports options 1-1 Ports	4	Plating 7-Selective gold plated on contact area and matte tin plated on tails area		
5	thickness of Gold Plating 01-1u"	6	Color-Resin BK-Black	7	Packaging K-Tray	8	Contact type 1-Square pin	9	Style 1-Round Panel 2-Square Panel

<p>THIRD ANGLE PROJECTION</p>	<p>GENERAL TOLERANCES (UNLESS SPECIFIED)</p>		<p>APPROVE BY LEO</p>	<p>DATE 19/Sept/23</p>	<p>PART NO. FRJ45232-17XXBKK01X0</p>	<p>ITEM NO. FRJ45232</p>	<p>Building Technology Cornerstone</p>
	<p>X. ±0.30</p>	<p>X.* ±5°</p>	<p>CHECKED BY GISELLE</p>	<p>DATE 19/Sept/23</p>	<p>TITLE RJ45 Connector 8P8C 90° Angle Locked</p>		
<p>DESIGN UNITS METRIC(mm)</p>	<p>X.X ±0.20</p>	<p>X.X* ±2°</p>	<p>DRAWN BY Hejianpeng</p>	<p>DATE 19/Sept/23</p>	<p>THIS DRAWING CONTAINS INFORMATION THAT IS PROPRIETARY TO TXGA INDUSTRIAL ELECTRONICS(S,Z)CO.,LTD AND SHOULD NOT BE USED WITHOUT WRITTEN PERMISSION</p>		
<p>SCALE 5:1</p>	<p>SIZE A4</p>	<p>X.XX ±0.15</p>	<p>X.XX* ±1°</p>	<p>X.XXX ±0.10</p>	<p>X.XXX* ±0.5°</p>		

Square panel

REV	LOCATIONS	DESCRIPTION	DATE	REVISER	APPD

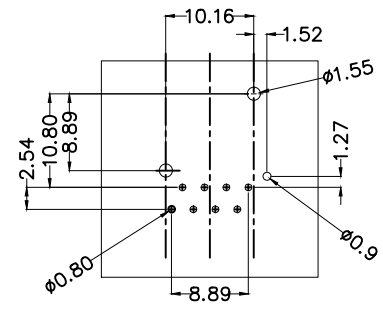
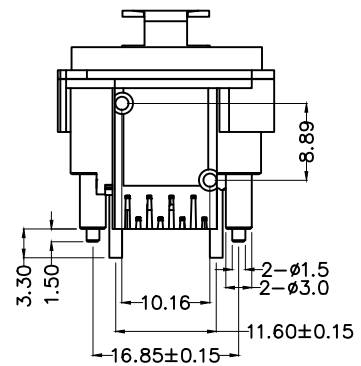
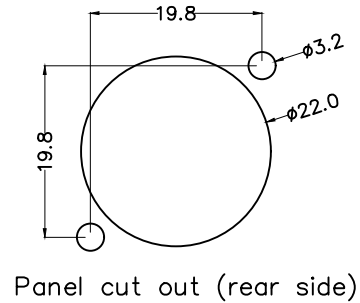
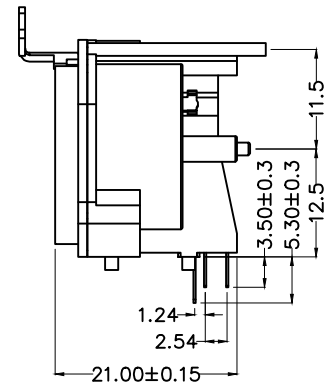
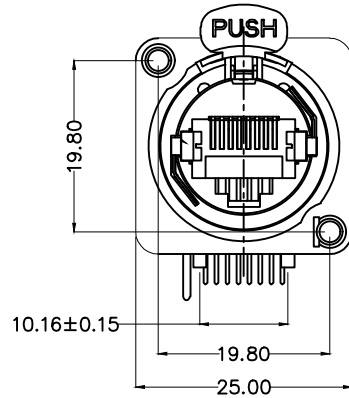
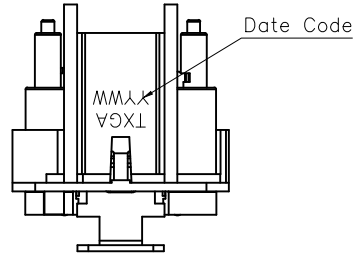

Recommended P.C.Board Layout  
General tolerances:±0.05

<p>THIRD ANGLE PROJECTION</p>	<p>GENERAL TOLERANCES (UNLESS SPECIFIED)</p>		<p>APPROVE BY</p> <p>LEO</p>	<p>DATE</p> <p>19/Sept/23</p>	<p>PART NO.</p> <p>FRJ45232-17XXBKK01X0</p>	<p>ITEM NO.</p> <p>FRJ45232</p>	<p>Building Technology Cornerstone</p>
	<p>X. ±0.30</p>	<p>X.' ±5°</p>	<p>CHECKED BY</p> <p>GISELLE</p>	<p>DATE</p> <p>19/Sept/23</p>	<p>TITLE</p> <p>RJ45 Connector 8P8C 90° Angle Locked</p>		
<p>DESIGN UNITS</p> <p>METRIC(mm)</p>	<p>X.X ±0.20</p>	<p>X.X' ±2°</p>	<p>DRAWN BY</p> <p>Hejianpeng</p>	<p>DATE</p> <p>19/Sept/23</p>	<p>THIS DRAWING CONTAINS INFORMATION THAT IS PROPRIETARY TO TXGA INDUSTRIAL ELECTRONICS(S,Z)CO.,LTD AND SHOULD NOT BE USED WITHOUT WRITTEN PERMISSION</p>		
<p>SCALE</p> <p>5:1</p>	<p>SIZE</p> <p>A4</p>	<p>X.XX ±0.15</p>	<p>X.XX' ±1°</p>	<p>X.XXX ±0.10</p>	<p>X.XXX' ±0.5°</p>		