

With handle

REV	LOCATIONS	DESCRIPTION	DATE	REVISER	APPD

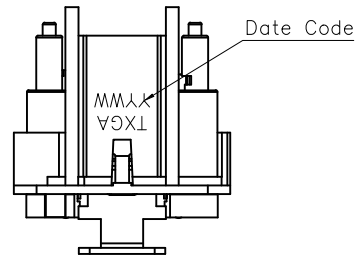

SPECIFICATION

Electrical

Current Rating: 1.5A AC(rms)/DC
 Voltage Rating: 50V AC(rms)/DC
 Contact Resistance: 10 mΩ Max
 Insulation Resistance: 500 MΩ MIN
 Withstanding Voltage: 1000V AC r.m.s
 Temperature Range-Operating: -30°C~+80°C
 Frequency Range: 1-100MHz

Material

Housing: PA66, (UL 94V-0) Black
 Panel: PBT, (UL 94V-0) Black/Yellow
 Back cover: LCP, (UL 94V-0) Black
 Terminal: Copper alloy/Selective gold plated on contact area and matte tin plated on tails area
 Handle: SUS/Nickel plating
 Spring steel: Mn Steel/Nickel plating
 Internal contact spring: Copper alloy/Metal Insert

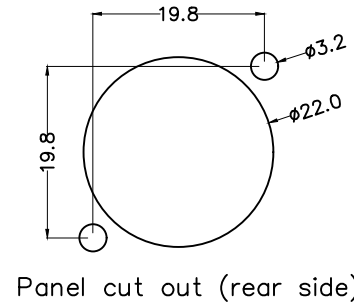
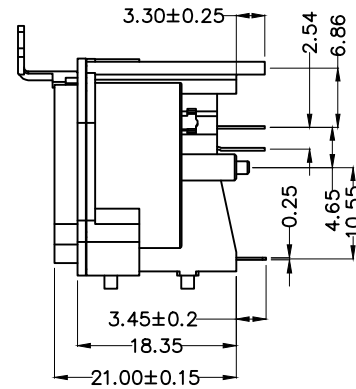
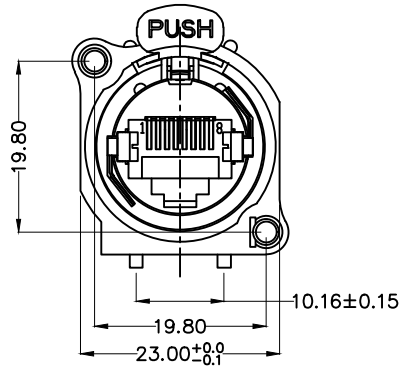

Panel cut out (rear side)

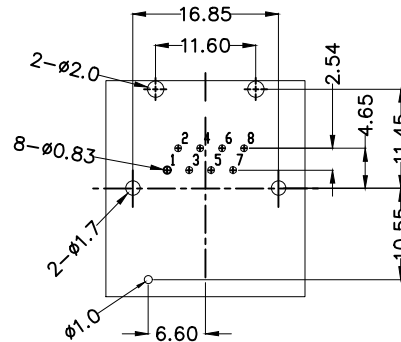
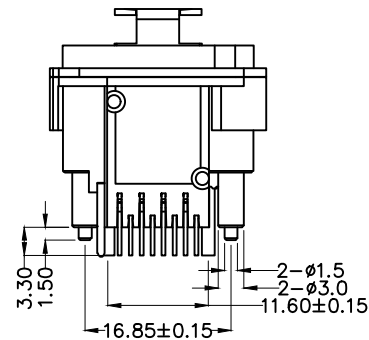

Recommended P.C.Board Layout
 General tolerances: ±0.05

Ordering Information

FRJ45 233 - 1 7 XX XX K 0 1 X 0
 1 2 3 4 5 6 7 8 9

1	Category	2	Distinction No.	3	Ports options	4	Plating		
	FRJ45-RJ45 Connector		233		1-1 Ports		7-Selective gold plated on contact area and matte tin plated on tails area		
5	thickness of Gold Plating	6	Color-Resin	7	Packaging	8	Contact type	9	Style
	03-3u"		BK-Black HSG,Black Panel KY-Black HSG,Yellow Panel		K-Tray		1-Square pin		1-With handle 2-Without handle

<p>THIRD ANGLE PROJECTION</p>	<p>GENERAL TOLERANCES (UNLESS SPECIFIED)</p>		<p>APPROVE BY</p> <p>LEO</p>	<p>DATE</p> <p>19/Sept/23</p>	<p>PART NO.</p> <p>FRJ45233-17XXXXX01X0</p>	<p>ITEM NO.</p> <p>FRJ45233</p>	<p>Building Technology Cornerstone</p>
	<p>X. ±0.30</p> <p>X.X ±0.20</p> <p>X.XX ±0.15</p> <p>X.XXX ±0.10</p>	<p>X.* ±5°</p> <p>X.X* ±2°</p> <p>X.XX* ±1°</p> <p>X.XXX* ±0.5°</p>	<p>CHECKED BY</p> <p>GISELLE</p>	<p>DATE</p> <p>19/Sept/23</p>	<p>TITLE</p> <p>RJ45 Connector 8P8C 180°Vertical</p>	<p>REV 0</p> <p>SHEET NO. 1/2</p>	
<p>SCALE</p> <p>5:1</p>	<p>SIZE</p> <p>A4</p>	<p>DRAWN BY</p> <p>Hejianpeng</p>	<p>DATE</p> <p>19/Sept/23</p>	<p>THIS DRAWING CONTAINS INFORMATION THAT IS PROPRIETARY TO TXGA INDUSTRIAL ELECTRONICS(S,Z)CO.,LTD AND SHOULD NOT BE USED WITHOUT WRITTEN PERMISSION</p>			

Without handle

REV	LOCATIONS	DESCRIPTION	DATE	REVISER	APPD

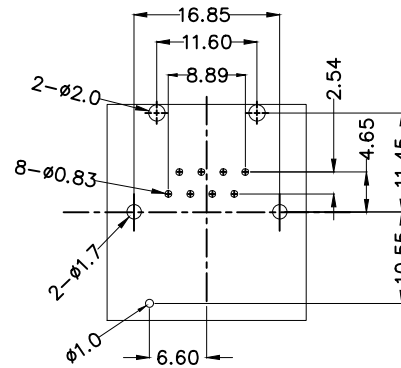
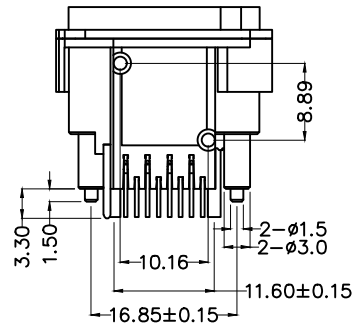
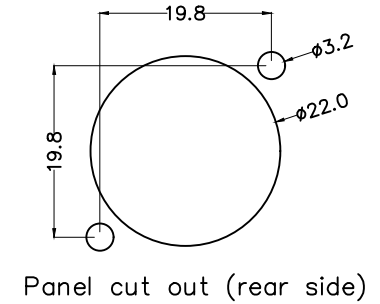
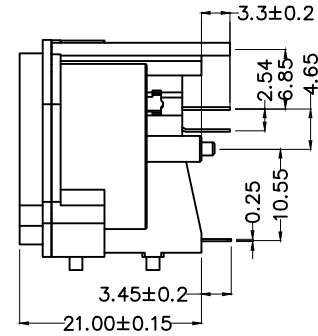
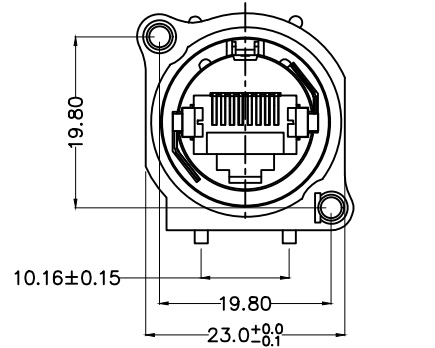
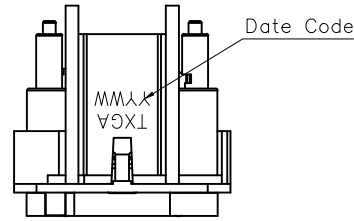

Recommended P.C.Board Layout
General tolerances:±0.05

<p>THIRD ANGLE PROJECTION</p>	GENERAL TOLERANCES (UNLESS SPECIFIED)		APPROVE BY LEO	DATE 19/Sept/23	PART NO. FRJ45233-17XXXXX01X0	ITEM NO. FRJ45233	<p>Building Technology Cornerstone</p>	
	X. ±0.30	X.' ±5°	CHECKED BY GISELLE	DATE 19/Sept/23	TITLE RJ45 Connector 8P8C 180°Vertical			REV 0
	DESIGN UNITS METRIC(mm)	X.X ±0.20	X.X' ±2°	DRAWN BY Hejianpeng	DATE 19/Sept/23	THIS DRAWING CONTAINS INFORMATION THAT IS PROPRIETARY TO TXGA INDUSTRIAL ELECTRONICS(S,Z)CO.,LTD AND SHOULD NOT BE USED WITHOUT WRITTEN PERMISSION		SHEET NO. 2/2
	SCALE 5:1	SIZE A4	X.XX ±0.15	X.XX' ±1°	X.XXX ±0.10	X.XXX' ±0.5°		