

Metal Panel

REV	LOCATIONS	DESCRIPTION	DATE	REVISER	APPD

SPECIFICATION

Electrical  
 Current Rating: 1.5A AC(rms)/DC  
 Voltage Rating: 50V AC(rms)/DC  
 Contact Resistance: 10 mΩ Max  
 Insulation Resistance: 500 MΩ MIN  
 Withstanding Voltage: 1000V AC r.m.s  
 Temperature Range—Operating: -30°C~+80°C  
 Frequency Range: 1-100MHz

Material  
 Housing: PA66,(UL 94V-0) Black  
 Back cover: LCP,(UL 94V-0) Black  
 Terminal: Phosphor Bronze/Selective gold plated on contact area and matte tin plated on tails area  
 Metal Panel: Zinc Alloy/Nickel plating  
 Handle: SUS/Nickel plating  
 Spring steel: Mn Steel/Nickel plating  
 Internal contact spring: Copper alloy/Metal Insert  
 Metal shield: Copper alloy/Nickel plating

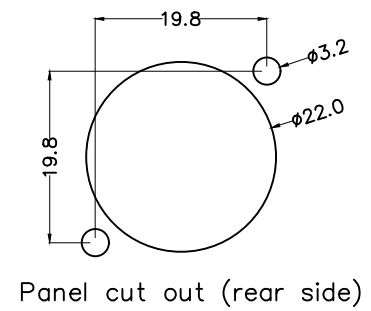
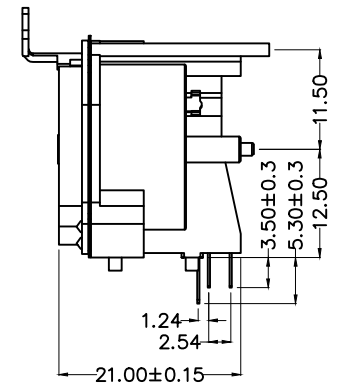
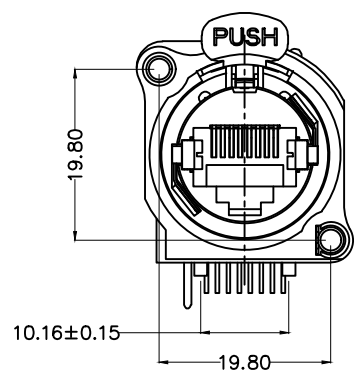
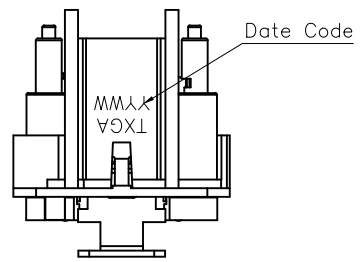

Panel cut out (rear side)

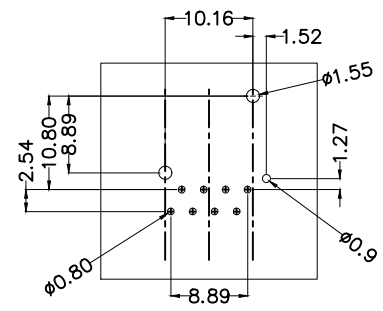
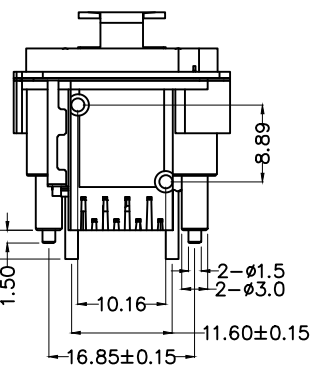

Recommended P.C.Board Layout  
 General tolerances: ±0.05

Ordering Information

FRJ45	234	—	1	7	XX	BK	K	0	1	0	0
1	2		3	4	5	6	7		8		
1	Category	2	Distinction No.	3	Ports options	4	Plating	7-Selective gold plated on contact area and matte tin plated on tails area			
	FRJ45-RJ45 Connector		234		1-1 Ports						
5	thickness of Gold Plating	6	Color-Resin	7	Packaging	8	Contact type				
	01-1u"		BK-Black		K-Tray		1-Square pin				

<p>THIRD ANGLE PROJECTION</p>	<p>GENERAL TOLERANCES (UNLESS SPECIFIED)</p>		<p>APPROVE BY</p> <p>LEO</p>	<p>DATE</p> <p>19/Sept/23</p>	<p>PART NO.</p> <p>FRJ45234-17XXBKK0100</p>	<p>ITEM NO.</p> <p>FRJ45234</p>	<p>Building Technology Cornerstone</p>
	X. ±0.30	X.* ±5°	CHECKED BY	DATE	<p>TITLE</p> <p>RJ45 Connector 8P8C 90° Angle Locked</p>		
DESIGN UNITS	X.X ±0.20	X.X* ±2°	GISELLE	19/Sept/23			
METRIC(mm)	X.XX ±0.15	X.XX* ±1°	DRAWN BY	DATE			
SCALE	5:1	X.XXX ±0.10	X.XXX* ±0.5°	Hejianpeng	19/Sept/23	<p>THIS DRAWING CONTAINS INFORMATION THAT IS PROPRIETARY TO TXGA INDUSTRIAL ELECTRONICS(S,Z)CO.,LTD AND SHOULD NOT BE USED WITHOUT WRITTEN PERMISSION</p>	