

1 2 3 4 5 6 7 8

REV	LOCATIONS	DESCRIPTION	DATE	REVISER	APPD

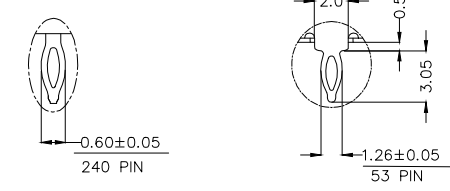

Detail A
Scale 10:1

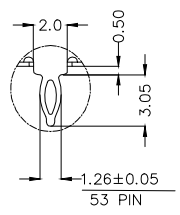

Detail B
Scale 5:1

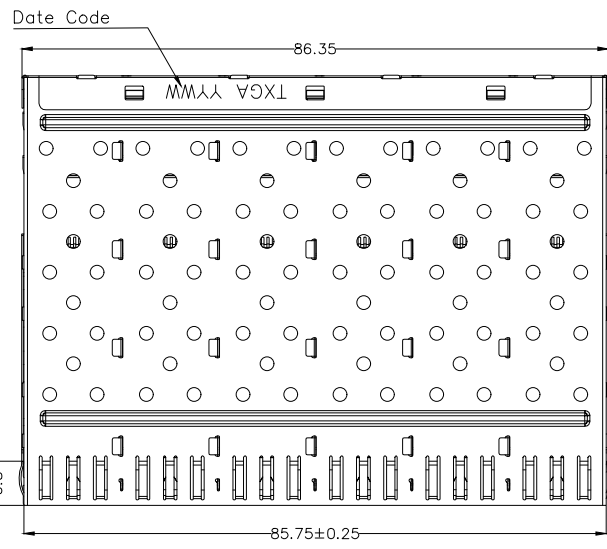

SPECIFICATIONS

Electrical
 Current Rating: 0.5A AC(rms)/DC
 Voltage Rating: 30V AC(rms)/DC
 Contact Resistance: 80 mΩ Max
 Insulation Resistance: 1000 MΩ Min
 Withstanding Voltage: 300V AC r.m.s
 Operating Temperature: -40°C~+85°C
 Storage Temperature: -55°C~+105°C

Material and plating
 Housing: LCP (UL 94V-0) Black
 Moulded Insert: High Temperature Plastic (UL 94V-0) Black
 Light Pipes: PC (UL 94V-0) Clear
 Light Pipe Housing: PBT (UL 94V-0) Black
 Contacts: Copper Alloy/Selective gold plated on contact area and matte tin plated on tails area
 Cage: Copper Alloy/Nickel plating 30u"MIN

Mechanical Requirement
 Durability: 100 Cycles Min
 Insertion and Extraction Force: 40N Max & 11.5N Max

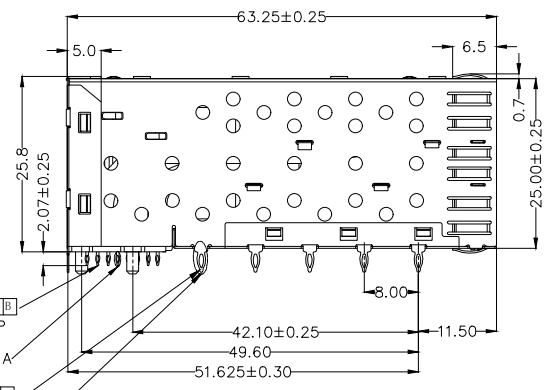

⌀0.25 A B
Signals TYP
See Detail A

⌀0.40 A B
Grounds TYP
See Detail B

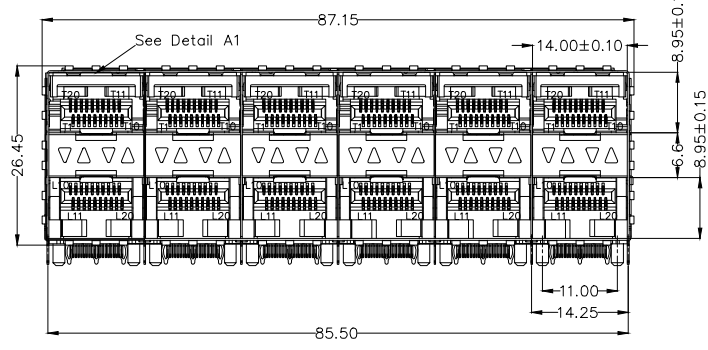

Ordering Information

FSFPO	003	—	12	F	7	XX	S	X	0
1	2	3	4	5	6	7	8		

1 Form factor FSFPO-SFP	2 Model serial num 003	3 Port Configuration 12-12 Ports	4 Mounting Style F-Through hole press-fit
5 Plating 7-Selective gold plated on contact area and matte tin plated on tails area	6 Plating Thickness 15-15u" 30-30u"	7 Cage S-With cage	8 Light Pipes 0-Without lightpipe 1-With inner and outer lightpipes 2-With inner lightpipes 3-With outer lightpipes

<p>THIRD ANGLE PROJECTION</p>	GENERAL TOLERANCES (UNLESS SPECIFIED)		APPROVE BY LEO	DATE 19/Sept/23	PART NO. FSFP0003-12F7XXSX0	ITEM NO. FSFP0003	<p>Building Technology Cornerstone</p>
	X. ±0.30	X.' ±5'	CHECKED BY GISELLE	DATE 19/Sept/23	TITLE Small Form-factor Pluggable Pitch 0.8mm 90°Angle		
DESIGN UNITS METRIC(mm)	X.X ±0.20	X.X' ±2'	DRAWN BY Hejianpeng	DATE 19/Sept/23	THIS DRAWING CONTAINS INFORMATION THAT IS PROPRIETARY TO TXGA INDUSTRIAL ELECTRONICS(S,Z)CO.,LTD AND SHOULD NOT BE USED WITHOUT WRITTEN PERMISSION		
SCALE 5:1	SIZE A4	X.XX ±0.15	X.XX' ±1'				
		X.XXX ±0.10	X.XXX' ±0.5'				

1 2 3 4 5 6 7 8

1 2 3 4 5 6 7 8

REV	LOCATIONS	DESCRIPTION	DATE	REVISER	APPD

A

A

B

B

C

C

D

D

E

E

F

F

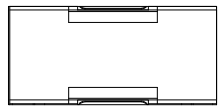

0-Without lightpipe

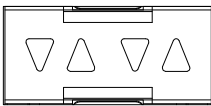

1-With inner and outer lightpipes

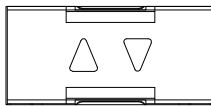

2-With inner lightpipes

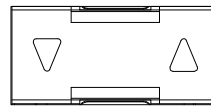

3-With outer lightpipes

Light Pipe Configuration
Detail D Scale 2:1

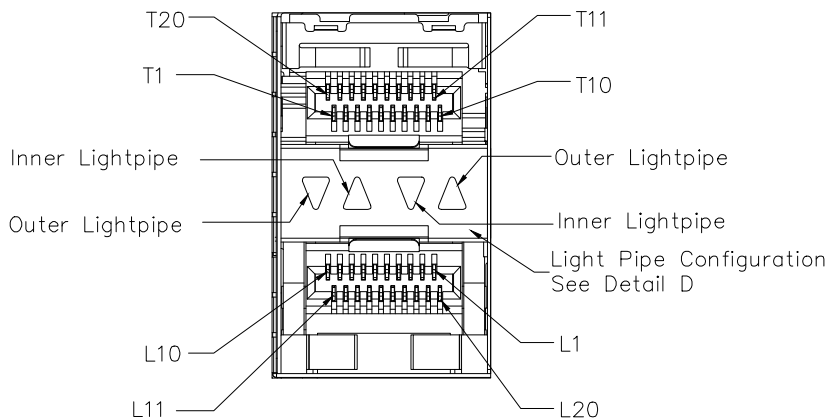

Detail A1
Scale 4:1

<p>THIRD ANGLE PROJECTION</p>	GENERAL TOLERANCES (UNLESS SPECIFIED)		APPROVE BY LEO	DATE 19/Sept/23	PART NO. FSFP0003-12F7XXSX0	ITEM NO. FSFP0003	<p>Building Technology Cornerstone</p>	
	X. ±0.30	X.* ±5°	CHECKED BY GISELLE	DATE 19/Sept/23	TITLE Small Form-factor Pluggable Pitch 0.8mm 90°Angle			REV 0
	DESIGN UNITS METRIC(mm)	X.X ±0.20	X.X* ±2°	DRAWN BY Hejianpeng	DATE 19/Sept/23	THIS DRAWING CONTAINS INFORMATION THAT IS PROPRIETARY TO TXGA INDUSTRIAL ELECTRONICS(S.Z)CO.,LTD AND SHOULD NOT BE USED WITHOUT WRITTEN PERMISSION		SHEET NO. 2/5
	SCALE 5:1	SIZE A4	X.XX ±0.15	X.XX* ±1°	X.XXX ±0.10	X.XXX* ±0.5°		

1 2 3 4 5 6 7 8

1 2 3 4 5 6 7 8

REV	LOCATIONS	DESCRIPTION	DATE	REVISER	APPD

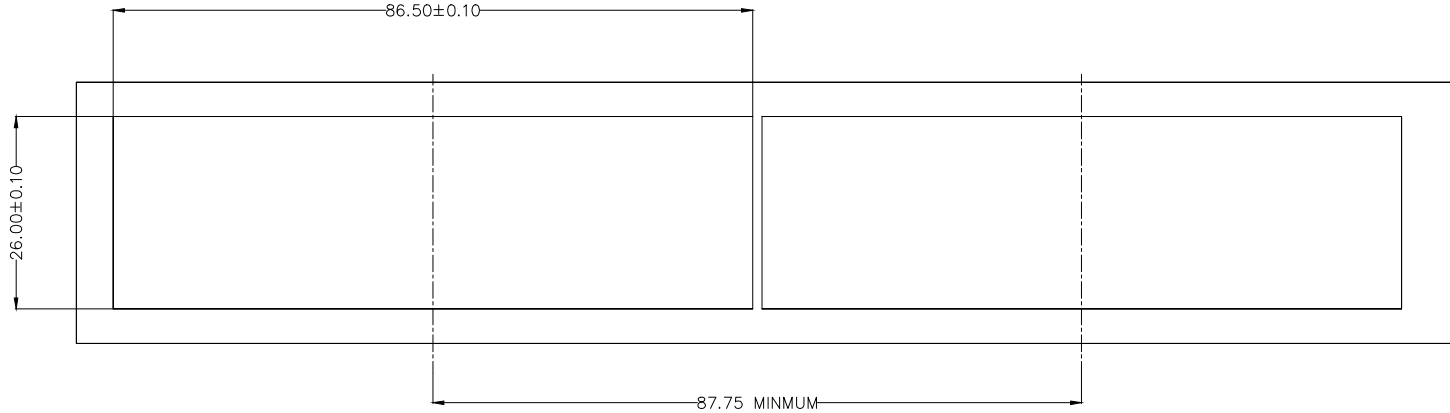

Bezel Cut-out Center Spacing Detail
Bezel Thickness: 0.8-2.6

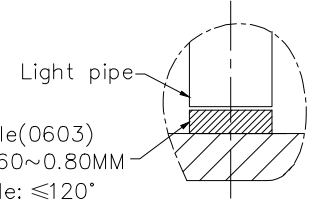
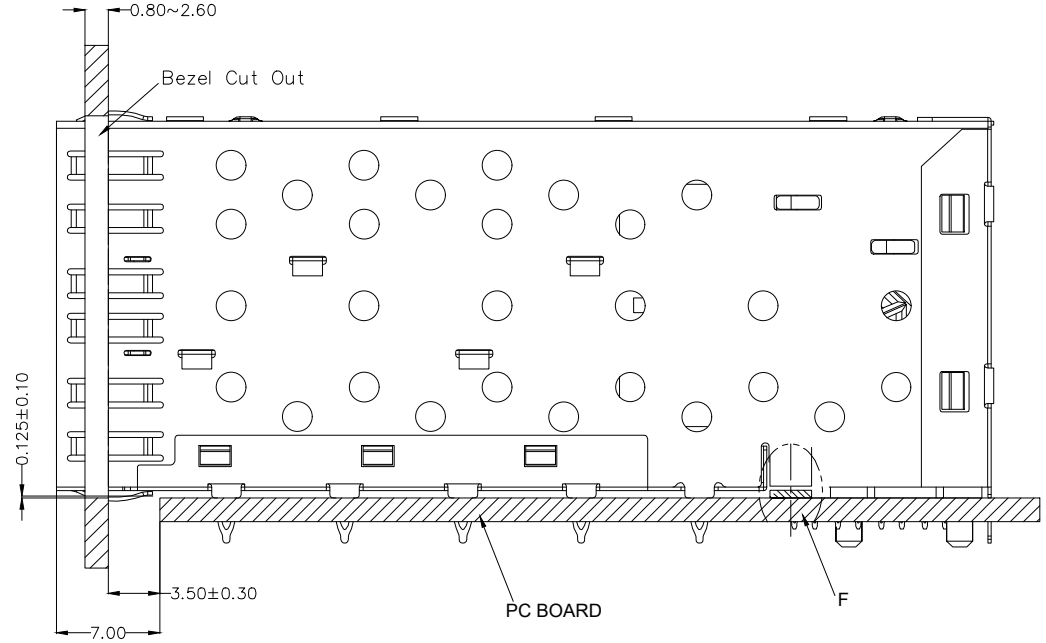

Detail F
Scale 4:1

<p>THIRD ANGLE PROJECTION</p>	GENERAL TOLERANCES (UNLESS SPECIFIED)		APPROVE BY LEO	DATE 19/Sept/23	PART NO. FSFP0003-12F7XXSX0	ITEM NO. FSFP0003	<p>Building Technology Cornerstone</p>	
	X. ±0.30	X.* ±5°	CHECKED BY GISELLE	DATE 19/Sept/23	TITLE Small Form-factor Pluggable Pitch 0.8mm 90°Angle			REV 0
	DESIGN UNITS METRIC(mm)	X.X ±0.20	X.X* ±2°	DRAWN BY Hejianpeng	DATE 19/Sept/23	THIS DRAWING CONTAINS INFORMATION THAT IS PROPRIETARY TO TXGA INDUSTRIAL ELECTRONICS(S.Z)CO.,LTD AND SHOULD NOT BE USED WITHOUT WRITTEN PERMISSION		SHEET NO. 3/5
	SCALE 5:1	SIZE A4	X.XX ±0.15	X.XX* ±1°	X.XXX ±0.10	X.XXX* ±0.5°		

1 2 3 4 5 6 7 8

REV	LOCATIONS	DESCRIPTION	DATE	REVISER	APPD

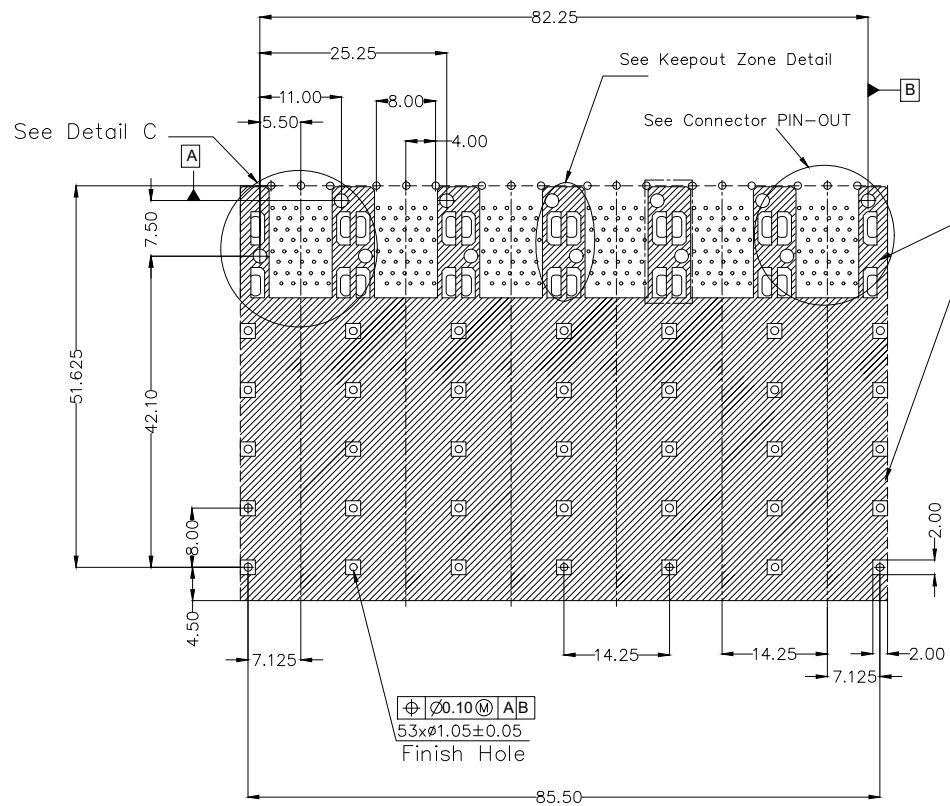

Cross-Hatched Area Denotes Component AND Trace Keep-Out (Except Chassis Ground)

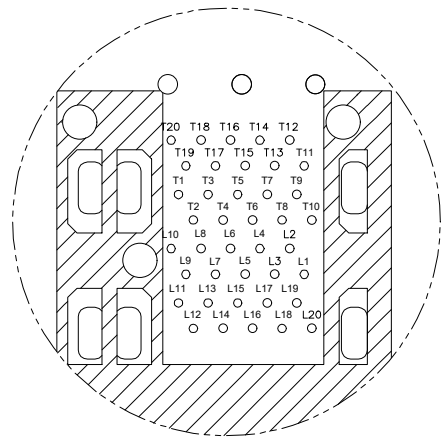

Connector PIN-Out Component Side of Board

RECOMMENDED PCB LAYOUT—COMPONENT SIDE
 RECOMMENDED PCB THICKNESS—2.63MM
 THE ENTIRE AREA OF THE CONNECTOR FOOTPRINT
 TO BE CONSIDERED THE KEEP OUT AREA FOR COMPONENTS
 (OTHER THAN LIGHT PIPE LED'S)
 THIS AREA IS INDICATED BY THE DASHED LINE

<p>THIRD ANGLE PROJECTION</p>	GENERAL TOLERANCES (UNLESS SPECIFIED)		APPROVE BY LEO	DATE 19/Sept/23	PART NO. FSFP0003-12F7XXSX0	ITEM NO. FSFP0003	<p>Building Technology Cornerstone</p>	
	X. ±0.30	X.' ±5°	CHECKED BY GISELLE	DATE 19/Sept/23	TITLE Small Form-factor Pluggable Pitch 0.8mm 90°Angle			REV 0
	DESIGN UNITS METRIC(mm)	X.X ±0.20	X.X' ±2°	DRAWN BY Hejianpeng	DATE 19/Sept/23	THIS DRAWING CONTAINS INFORMATION THAT IS PROPRIETARY TO TXGA INDUSTRIAL ELECTRONICS(S.Z)CO.,LTD AND SHOULD NOT BE USED WITHOUT WRITTEN PERMISSION		SHEET NO. 4/5
	SCALE 5:1	SIZE A4	X.XX ±0.15	X.XX' ±1°	X.XXX ±0.10	X.XXX' ±0.5°		

