

REV	LOCATIONS	DESCRIPTION	DATE	REVISOR	APPD

Electrical
 1. Withstanding Voltage: DC 300V
 2. Conduction impedance: 3Ω (MAX)
 3. Insulation Resistance: 10MΩ (MIN)

Packing specification
 1.10pcs/Bag

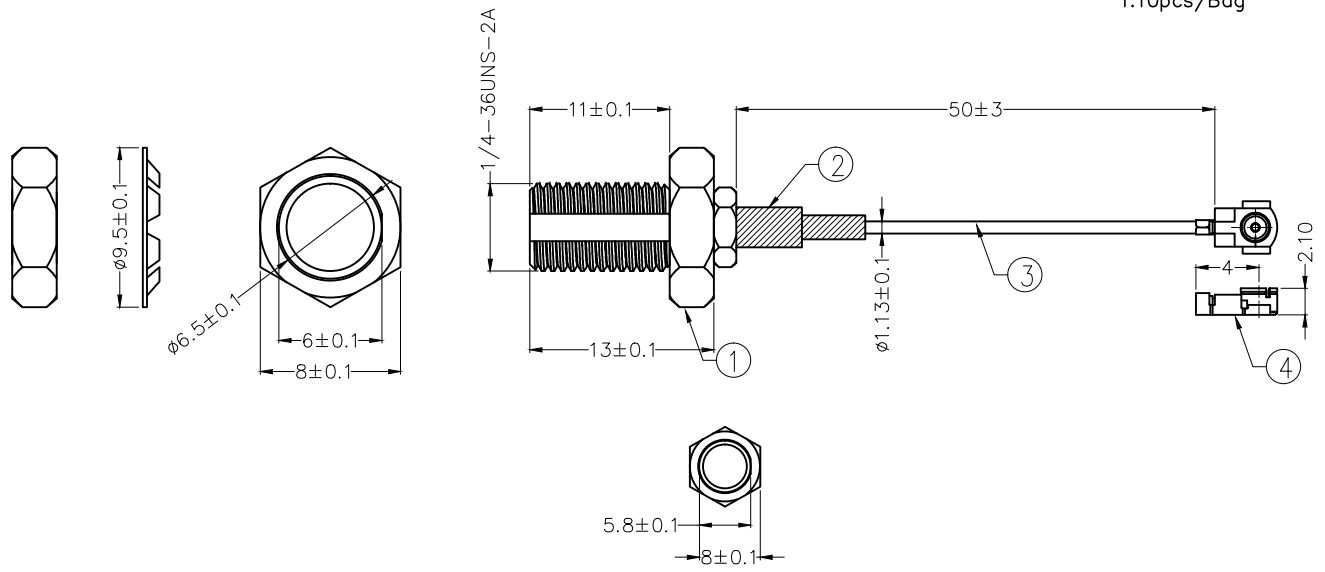

* Note: All Materials Meet The "RoHs" !

④	RF MHF I plug: RF05002-PEB103MA
③	Coaxial Cable: RG178 Jack Gray, OD=1.13mm
②	Black Heat Shrink Tube Ø3.5
①	SMA Jack, Gold plated
NO.	Specification

 THIRD ANGLE PROJECTION	GENERAL TOLERANCES (UNLESS SPECIFIED)		APPROVE BY	DATE	PART NO.	ITEM NO.	 Leader Of Industry	
	X. ±0.30	X.* ±5'	VERNON	29/AUG/17	FSP11138-00050	FSP11138		
DESIGN UNITS Metric	X.X ±0.20	X.X' ±2'	CHECKED BY	DATE	TITLE		REV 0	SHEET NO. 1/1
SCALE 5:1	X.XX ±0.15	X.XX' ±1'	KATE	29/AUG/17	SMA-IPEX CONDUCTOR CABLE		THIS DRAWING CONTAINS INFORMATION THAT IS PROPRIETARY TO TXGA INDUSTRIAL ELECTRONICS(S.Z)CO.,LTD AND SHOULD NOT BE USED WITHOUT WRITTEN PERMISSION	
SIZE A4	X.XXX ±0.10	X.XXX' ±0.5'	DRAWN BY	DATE				
			LXF	29/AUG/17				