

REV	LOCATIONS	DESCRIPTION	DATE	REVISER	APPD
0		New Release	30/MAY		FRANK

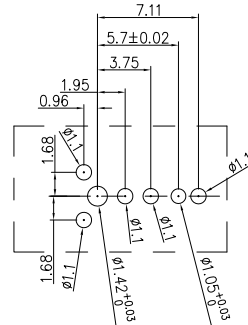

Material  
connector parts material Plating  
inner contact brass Gold  
outer contact brass Sn  
housing LCP  
Flame proofing  
Component category  
overmold material conforms to UL94V-0  
housing material conforms to UL94V-0  
International protection code IP20  
RoHS compliant  
Standards  
According the standard IEC 63171-2  
Power over Data Line (PoDL) acc. IEEE 802.3bu  
PCB Layout MB\_952

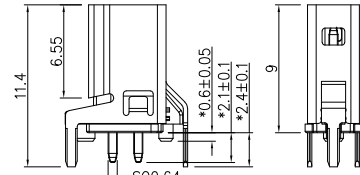
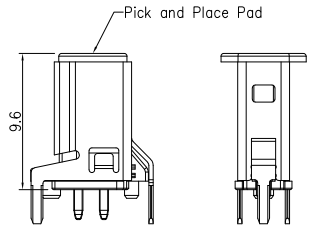
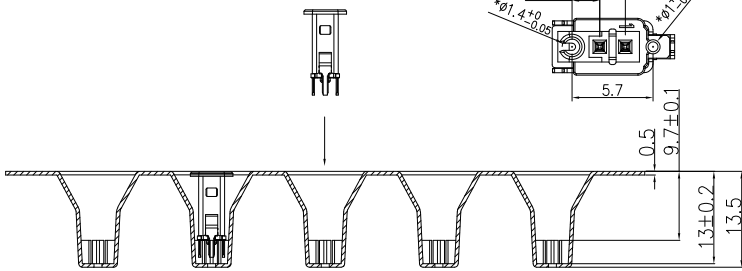

min. loading belt empty  
400mm(belt end)

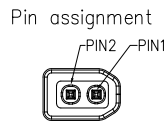

Pair	Contact	Data
1	1	Rx/Tx+
	2	Rx/Tx-

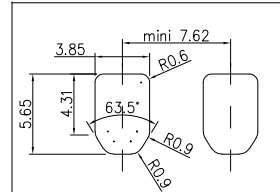

Panel cutout

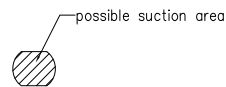
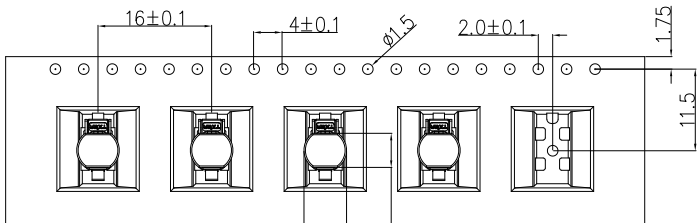

contact dimensions	effective length
contact 1	11.3
contact 2	15.3

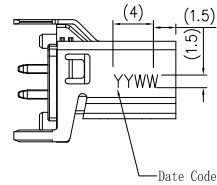

Date Code

Ordering Information

FSPRESS02 - 02 S 1 16 M 00  
1 2 3 4 5 6

1 Series Name - 2 Circuits - 3 Orientation - 4 Contact plating  
FSPRESS02 - 02-2Circuits - S-Vertical(180°) - 1-Gold plated

5 Contact plating thickness - 6 Packaging  
16-0.5µm - M-Reel

USER DIRECTION OF UNREELING  
EMBOSS TAPE

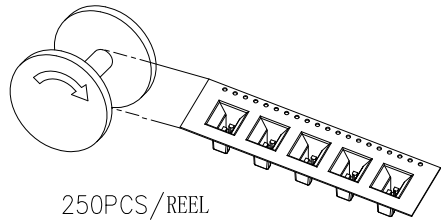

250PCS/REEL

 THIRD ANGLE PROJECTION DESIGN UNITS Metric SCALE 2:1 SIZE A4	GENERAL TOLERANCES (UNLESS SPECIFIED)		DATE	APPROVE BY	PART NO.	ITEM NO.	 Building Technology Cornerstone
	X.±.012(0.30)	X.±5°	FRANK	30/MAY/24	FSPRESS02-02S116M00	FSPRESS02	
	X.X±.008(0.20)	.X±2°	CHECKED BY	DATE	TITLE	SPE T1 Socket Straight THR THIS DRAWING CONTAINS INFORMATION THAT IS PROPRIETARY TO TXGA INDUSTRIAL ELECTRONICS(S,Z)CO.,LTD AND SHOULD NOT BE USED WITHOUT WRITTEN PERMISSION	
	X.XX±.006(0.15)	.XX±1°	CHERRY	30/MAY/24	SPE T1 Socket Straight THR		
X.XXX±.004(0.10)	.XXX±0.5°	DRAWN BY	DATE		REV 0	SHEET NO. 1/1	
		DANIEL	30/MAY/24				