

1 2 3 4 5 6 7 8

REV	LOCATIONS	DESCRIPTION	DATE	REVISER	APPD
1	△	New Drawing	12/JUN/24	MATT	LEO

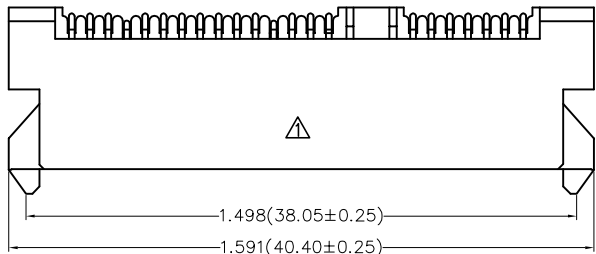

**SPECIFICATIONS**

**Electrical**  
 Current Rating: 1.0A AC(rms)/DC  
 Contact Resistance: 20 mΩ Max  
 Insulation Resistance: 800 MΩ MIN  
 Withstanding Voltage: 600V AC r.m.s  
 Temperature Range—Operating: -40°C~+85°C

**Material and Plating**  
 Housing: LCP (UL 94V-0)/Black  
 Contact: Phosphor Bronze/Selective gold on contact area, tin on tail.  
 Board Lock: Brass/Tin-Plated

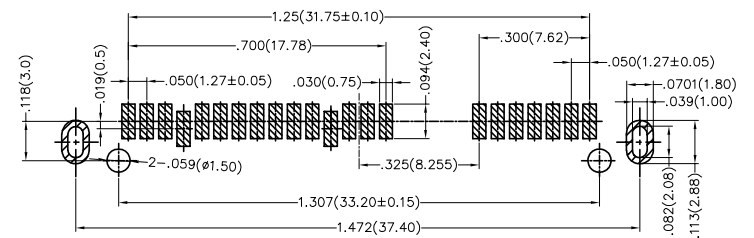
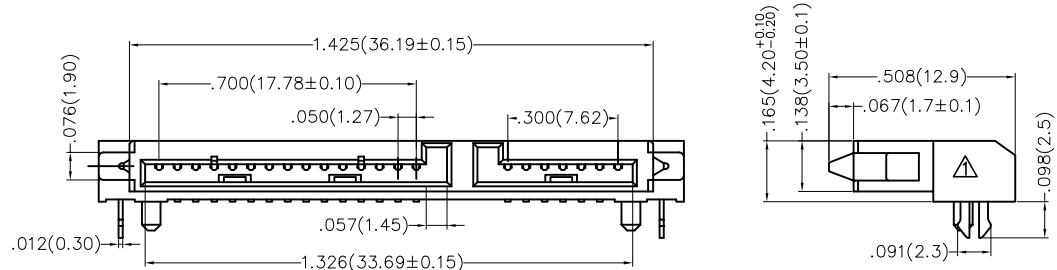

Recommended P.C.Board Layout

**Ordering Information**

FST 22 09 — F S B 3 XX 3 K6 X  
 1 2 3 4 5 6 7 8 9 10 11

1	Category SATA-FST	2	Circuits 22-7+15	3	Distinction No. 09	4	Type F-Female	5	Assembly Layout S-SMT	6	Entry Angle B-90° Angle
7	Plating 3-Half Gold/Tin	8	Thickness of Plating 00-Gold Plating 03-3u"..... Custon Plate Available	9	Material-Resin 3-LCP	10	Color-Resin K6-Black	11	Packaging L-Tube K-Tray		

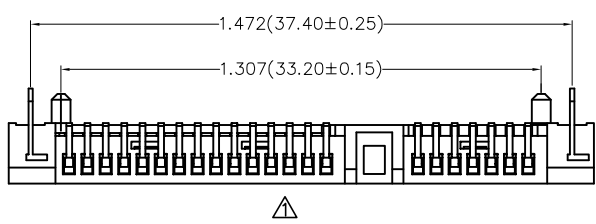
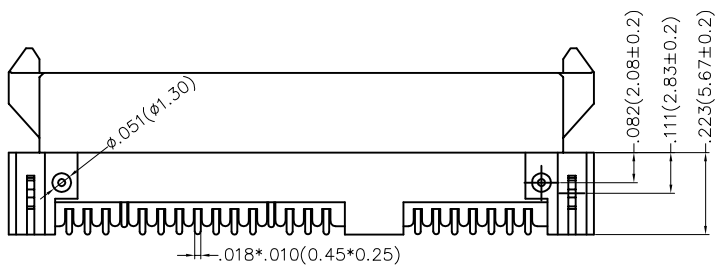

THIRD ANGLE PROJECTION		GENERAL TOLERANCES (UNLESS SPECIFIED)		APPROVE BY	DATE	PART NO.	ITEM NO.	
DESIGN UNITS Inch (metric)	X.±.012(0.30)	X'.±5'	CHECKED BY CHERRY	DATE 01/JUL/13	TITLE SATA 7+15 FEMALE SMT	FST2209-FSB3XX3K6X	FST2209	
	X.XX±.008(0.20)	.X'±2'						
SCALE 5:1	X.XX±.006(0.15)	.XX'±1'	DRAWN BY JACOB	DATE 01/JUL/13	THIS DRAWING CONTAINS INFORMATION THAT IS PROPRIETARY TO TXGA INDUSTRIAL ELECTRONICS(S.Z)CO.,LTD AND SHOULD NOT BE USED WITHOUT WRITTEN PERMISSION			
	X.XXX±.004(0.10)	.XXX'±0.5'						

1 2 3 4 5 6 7 8